

# SMART ELECTRONIC WALL HUNG TOILET

WALL MOUNTED

PRODUCT MANUAL

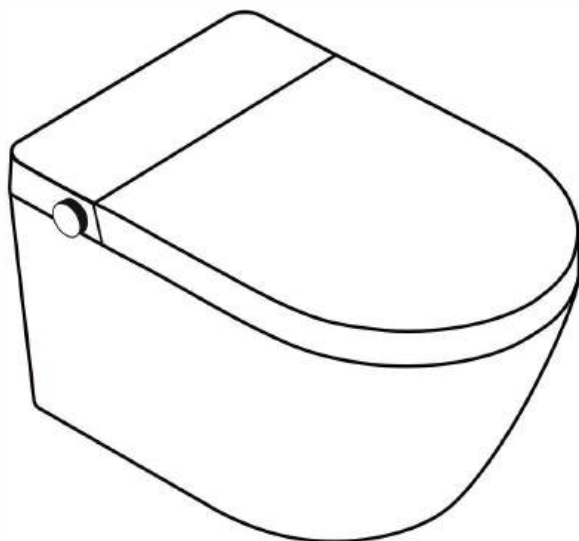
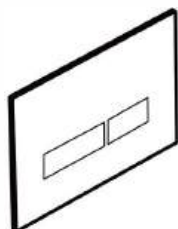

## Safety Notes

Please read this manual carefully before installation and strictly follow the instructions. After reading, please keep this manual in a prominent place. In order to avoid injury and property damage to users and others, please strictly observe the safety warnings and precautions.

### Please do follow the safety notes as below.

#### ⚠ FORBADE

⚠ Lit Cigarettes and other burning objects can not be put into the toilet bowl, otherwise it may cause a fire.

1. Do not disassemble, repair or modify the product on your own, otherwise it may cause fire or electric shock.
2. Do Not pour water or detergent on the body or plug, otherwise it may cause fire or electric shock.
3. Do not use wet hands to plug or pull the plug, or you may get an electric shock.
4. Do not use other electrical appliances in the same socket.
5. Do not use extension cords or loose loose unstable power sockets, which may cause fire or electric shock.
6. If the power cord is damaged, to avoid danger, it must be replaced by the manufacturer, its maintenance department or a professional from a similar department.
7. This product is an electrical appliance and should not be exposed to water. Do Not Spray Urine or other liquids

Pull out the power plug when there is thunder. Do not place the product where it may fall into or be pulled into the bathtub or sink. Do not place product in water or other liquids. Do not touch products that have fallen into water or are immersed in water. Unplug the power plug immediately. Please do not stand on a ceramic toilet. The ceramic toilet must be fitted with anchor bolts. Do not use water other than tap water, or it may cause skin inflammation and other problems. Please do not let the sun direct irradiation products, so as to avoid product discoloration and affect the remote control reception effect. This product seat and cover has slow down function, please do not press hard, so as not to damage the slow down device. Do not apply force or impact. Do not stand on seat ring, cover or body. Do not place heavy objects. Do not use banana water, gasoline, lotions and detergents, pesticides, toilet cleaners and hard bristles to clean this product. Please stop using and cut off the power supply immediately when the product function is abnormal or malfunction, and contact the service provider in time.

#### ⚠ MUST BE OBEYED

⚠ Lit Cigarettes and other burning objects can not be put into the toilet bowl, otherwise it may cause a fire.

1. Do not disassemble, repair or modify the product on your own, otherwise it may cause fire or electric shock.
2. Do Not pour water or detergent on the body or plug, otherwise it may cause fire or electric shock.
3. Do not use wet hands to plug or pull the plug, or you may get an electric shock.
4. Do not use other electrical appliances in the same socket.
5. Do not use extension cords or loose loose unstable power sockets, which may cause fire or electric shock.
6. If the power cord is damaged, to avoid danger, it must be replaced by the manufacturer, its maintenance department or a professional from a similar department.
7. This product is an electrical appliance and should not be exposed to water. Do Not Spray Urine or other liquids

Pull out the power plug when there is thunder. Do not place the product where it may fall into or be pulled into the bathtub or sink. Do not place product in water or other liquids. Do not touch products that have fallen into water or are immersed in water. Unplug the power plug immediately. Please do not stand on a ceramic toilet. The ceramic toilet must be fitted with anchor bolts. Do not use water other than tap water, or it may cause skin inflammation and other problems. Please do not let the sun direct irradiation products, so as to avoid product discoloration and affect the remote control reception effect. This product seat and cover has slow down function, please do not press hard, so as not to damage the slow down device. Do not apply force or impact. Do not stand on seat ring, cover or body. Do not place heavy objects. Do not use banana water, gasoline, lotions and detergents, pesticides, toilet cleaners and hard bristles to clean this product. Please stop using and cut off the power supply immediately when the product function is abnormal or malfunction, and contact the service provider in time.

## FUNCTIONS

BUTT WASH	Cleans buttocks dirt.
WOMEN CLEANING	Gentle cleansing of the intimate area, specially designed for women.
CHILD CLEANING	Specifically designed for children's delicate skin.
TUBE POSITION ADJUSTMENT	Different washer positions can be adjusted.
WATER PRESSURE REGULATION	Different water outlet pressures can be adjusted.
RECIPROCATING MASSAGE	Expand the scope of cleaning.
HOT AND COLD MASSAGE	Alternate hot and cold washing, start in the buttock or women's wash.
CONSTANT TEMPERATURE HEATING	Instant hot water, no need to wait.

INSULATION SEAT	The seat ring can be heated and can be adjusted in multiple positions.
WARM AIR DRYING	Dry after cleaning, multi-speed adjustable.
SEAT HEATING	Intelligently determine whether the user is seated to prevent wrong operation.
NIGHT LIGHT	The smart toilet emits soft light, making it easy for you to use.
AUTOMATIC FLUSH	Automatically determine whether the user wants to flush.
FOOT INDUCTION	The foot sensor can open the cover and open the circle.
AUTO OPEN COVER	When people approach to toilet, the cover is opened automatically.
AUTOMATIC CLOSE COVER	When leave seat, close cover and flush automatically.
FOAM LAYER	Prevent water from splashing butt.
UV STERILIZATION	The seat cover is dropped, and it is automatically sterilized and disinfected.

Note: The functions of different models and configurations are different, please refer to the actual purchased model functions.

## How to use Foam layer

How to use the foam shield Preliminary preparation: Unscrew the cap of the bubble guard bottle and install the cap with a tube.

- 1.Manual foaming: long press the one-button automatic button on the remote control for 5 seconds, the foaming function can be turned on separately.(The first operation needs to operate 2-3 times to make the foam liquid completely enter the machine).
- 2.Automatic foaming: Press and hold the energy-saving button for 5 seconds, a long beep is to turn on the foaming function of the human body seated, and a short beep is to close the foaming function of the human body seated.

## Name of Parts

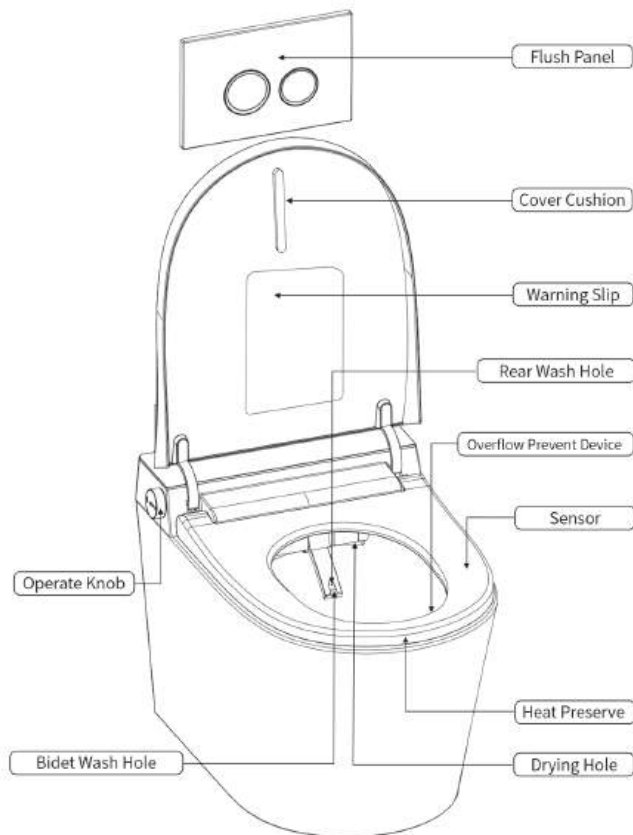

## Operating instructions for knobs

Forward KNOB (counter-clockwise rotation) → SELF-CLEANING → FEMALE MOBILE CLEANING FOR 2 minutes → drying for 3 minutes → stop, female fixed cleaning again counter-clockwise rotation for female fully automatic mobile cleaning, FEMALE MOBILE CLEANING AGAIN COUNTER-CLOCKWISE rotation for the female fully automatic fixed cleaning.

**Drying stop:** In other functional states, press the button to stop the function. In other states, press the button to dry the function. When the cover plate is cut off, the hand press the cover plate Knob to flush the water with the function of power off.

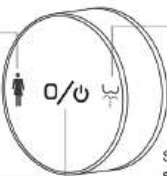

Forward KNOB (clockwise rotation) → self-cleaning → hip moving cleaning for 2 minutes → drying for 3 minutes → stop, hip fixed cleaning again clockwise rotation for the hip full automatic moving cleaning, when the buttock moves cleanses, rotates clockwise once more for the buttock full automatic fixed cleanses.

**Status:** Use Buttocks, children, hot and cold massage, fully automatic function for the blue, use for women when purple, when drying for red. People seated for the green often light, people seated for the white often light.



### 3 INSTRUCTIONS for REMOTE CONTROL

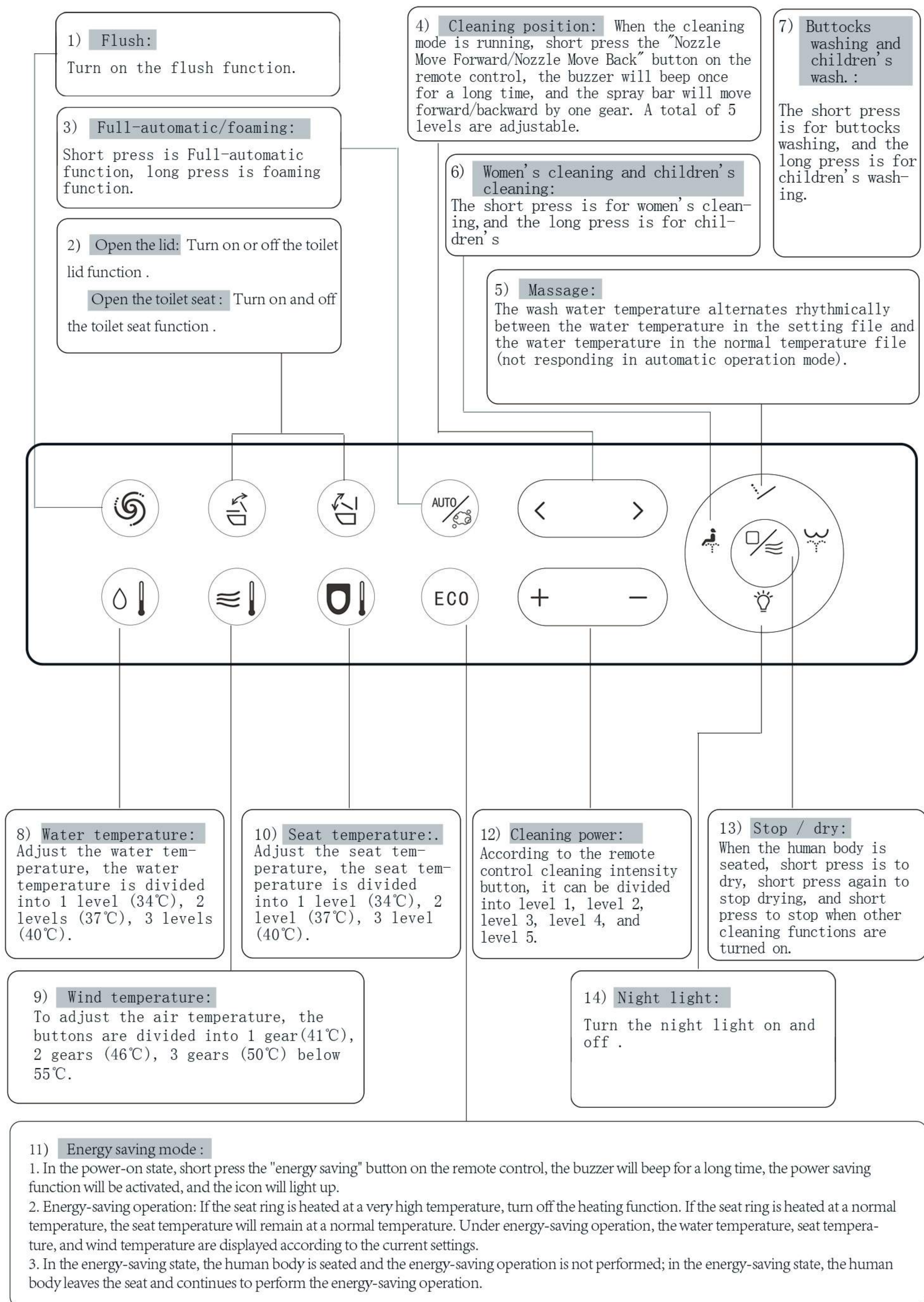



# Installation method

## Wall mounted toilet installation drawing

1. Fix the sewage pipe, bolts, flushing pipe and panel at the corresponding position of the wall.

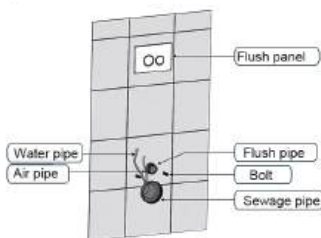

2. Remove the upper cover and take out the decorative cover and screws. Lift the toilet lid up.



3. Stick the mat. Tear film off and stick mat on the back of toilet accordingly.

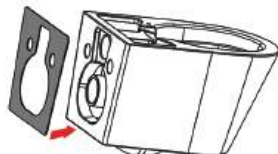

4. Rinse the pipeline impurities in the sequence of steps ①②③④ as shown in the figure below.

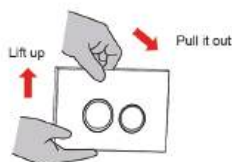

① Disassemble the panel

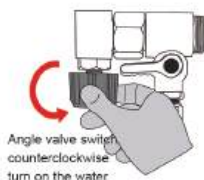

② Open angle valve



③ Open the three-way valve



④ Close the three-way valve

5. Fix the toilet Fix the toilet in the corresponding position.

- ① Pass the water pipe and air pipe through the back of the toilet.
- ② Align the mouth of the flushing pipe and the mouth of the sewage discharge pipe.
- ③ Align the fixing bolts 4. Push the toilet hard.

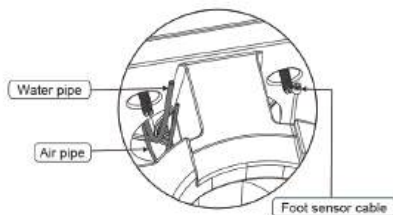

Note: The flushing pipe and sewage pipe should be aligned and firmly attached to the flush pipe opening and sewage pipe opening of the toilet.

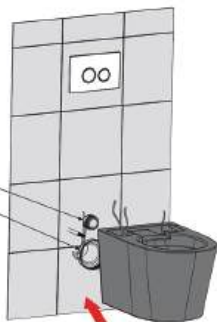

## Installation method

6. After confirming that the toilet are horizontal all around, then install it according to step 7.

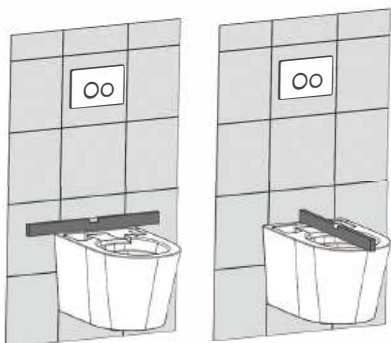

7. Install plastic gaskets, metal gaskets, nuts, decorative covers and other accessories in sequence.

Note: After the installation is completed, manually test the flushing and check the connection of the flushing pipe and the sewage pipe. If there is no water seepage and leakage, the installation is successful.

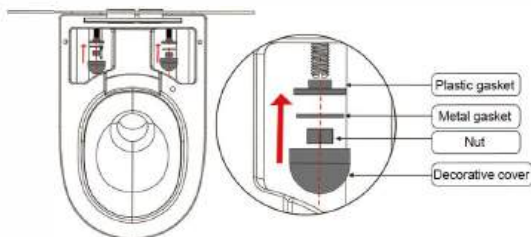

8. Connect the Air pipe, water pipe and foot sensor cable.

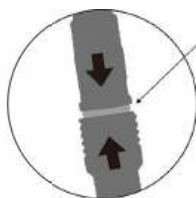
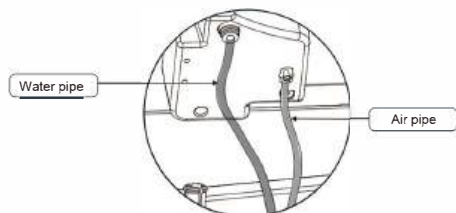
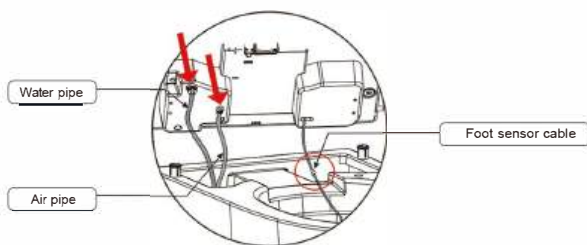
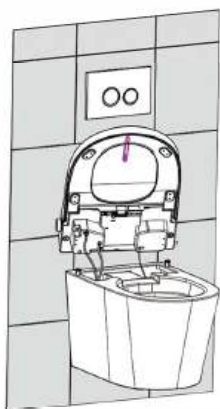

Foot sensor cable:

1. Line up the 2 arrows ensuring the male pins line up with the female pin holes and push the connection together.
2. Tighten the locking nut ensuring good cable connection.

BEWARE: DO NOT BEND PINS

## Installation method

9. After placing the installation position, the installation is completed.

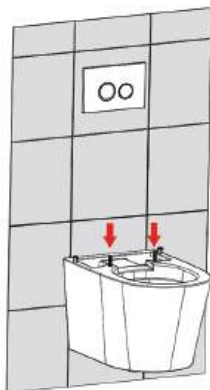

- ① Make sure that the toilet seat is fixed properly.
- ② Install the expansion screw on the toilet seat.

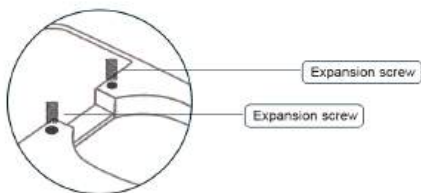

10. Install the smart toilet cover on the toilet to complete the installation.



- ① The cover plate fixing hole is aligned with the expansion screw hole.
- ② Secure the cover with the screws.
- ③ Put on the decorative cap.

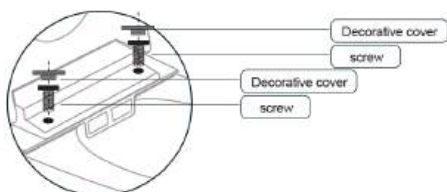

### Remote control installation

1. Tear off the protective sticker of the foam tape on the back of the bracket and stick it on the selected dry tile surface.
2. Put the remote control on the bracket.

Note: Please tear off the protective film of the face sticker when using it.



## UV Instructions for Use

- For manual open cover model : long press the seat temperature button on the remote control to force the UV lamp function on. Before turning on, you need to manually close the cover. Repeatedly operating the seat temperature button during the UV working process can turn off the function.
- For automatic open cover model :the sterilization function is automatically activated when the cover is closed, and the sterilization function is automatically closed when the cover is opened.
- Turn off the automatic sterilization function : when the toilet is turned off, short press the lighting button of remote control to switch it off.

## Handling of frequently asked questions

	reason	Deal with
No squirting	Blockage caused by bending of intake hose;	Eliminate the bending of the intake hose;
	Inlet Valve closed;	Open the intake valve;
	Tap Water, no water	Waiting for water
Weak spouting	Partial blockage due to bending of intake hose;	The drain hose bends;
	Intake valve not fully open;	Fully open the inlet valve;
	Clogged Inlet strainer	Clean the inlet filter
The water is not hot	Water temperature set to room temperature;	Reset the water temperature gear;
	In standby or power-saving mode	Switch to function mode and spray after 2 minutes
Seat temperature is not hot	Set the seat temperature to normal;	Reset the setting temperature;
	In standby mode	Switch to function mode and spray after 2 minutes
The wind is not hot	Set the air temperature to room temperature	Reset the wind temperature gear
No Wind	In standby or power-saving mode	Switch to function mode to use the drying function
Spray Rod not retracted	Power cut;	Gently push the spray rod back and wait for incoming power;
	Stuck in a foreign object	removal
The boom doesn't extend out	Power cut;	Waiting for the call;
	Not Seated in the seat sensing area	Sit in the correct position. Sit in the sensing area
The remote doesn't show	Remote control battery positive and negative charge or low battery	Reload the battery and align the anode and cathode; Replace with a new battery
 Pay Attention	If the failure is not eliminated after handling according to the above method, the power should be cut off, contact the service provider, please professional maintenance. If the power leakage protection switch often jumps off, that the product has leakage, please cut off the power supply, contact the service provider, please professional maintenance.	

## Accessory list

ITEM	Qty
liner	1
remote control	1
Mat	1
Connecting pipe	1
Battery	2

Notify: The product are subject to the actual. We will not notify separately for product upgrades or other reasons caused by differences of actual product. All final interpretation rights belong to our company.