

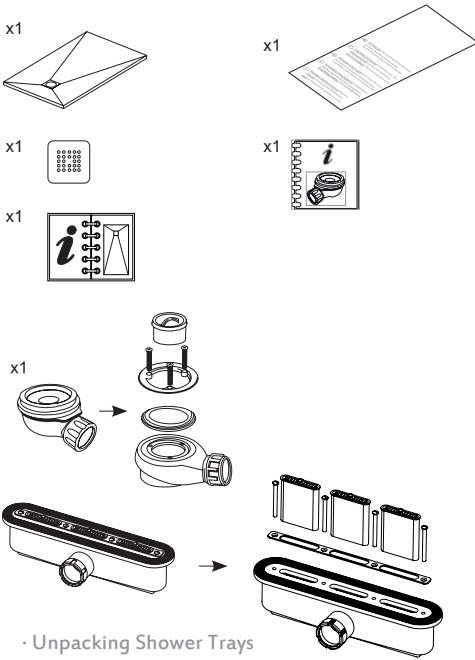

## 1. INSTALLATION · EINBAU

- Delivery Included items
- Lieferumfang



- Unpacking Shower Trays
- Duschwanne auspacken

- Necessary tools
- Erforderliche Werkzeuge

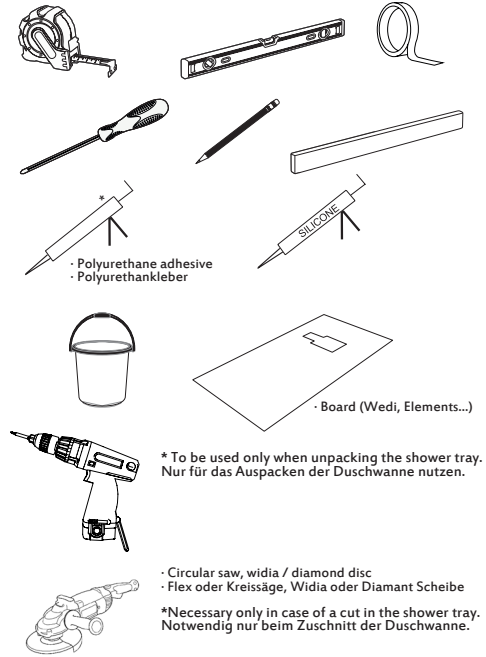

- Polyurethane adhesive
- Polyurethankleber

\* To be used only when unpacking the shower tray.  
Nur für das Auspacken der Duschwanne nutzen.

- Circular saw, widia / diamond disc
  - Flex oder Kreissäge, Widia oder Diamant Scheibe
- \*Necessary only in case of a cut in the shower tray.  
Notwendig nur beim Zuschnitt der Duschwanne.

Installation must be performed by AUTHORISED INSTALLERS · Der Einbau muss nur von einen SPEZIALIZERTEN und AUTHORITYSIERTEN Installateur durchgeführt werden.

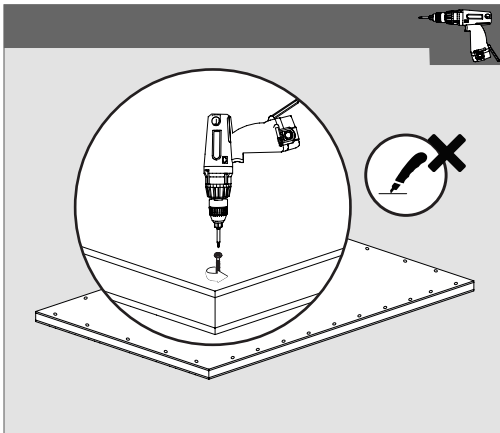

### english

Store the shower tray horizontally, remove all the screws COMPLETELY from the cover, being careful not to scratch the shower tray with the screws or cover.

### deutsch

Die Duschwanne immer waagrecht lagern. Die Schrauben aus dem hölzernen Deckel vorsichtig lösen.

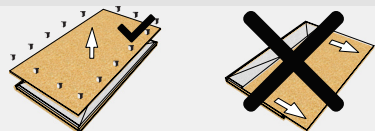

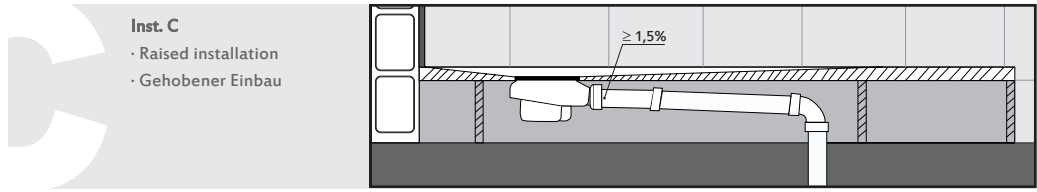
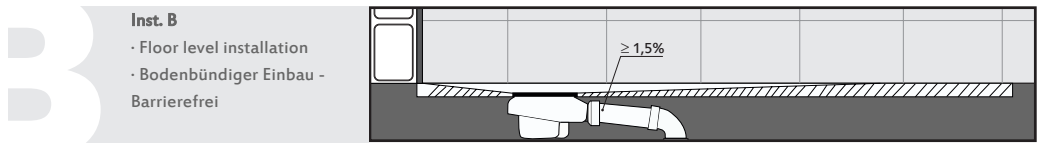
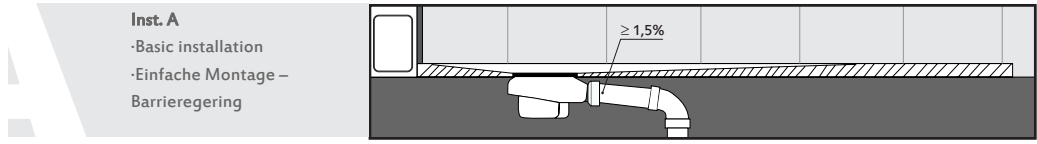

· Installation Scheme for U.K. homes with wood joists.

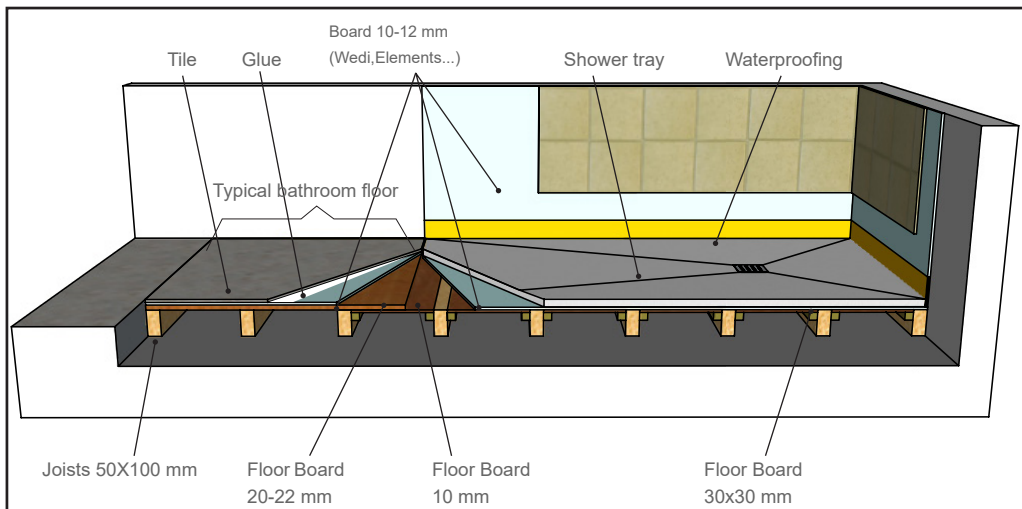

- Installation Squence
- Installationsskizze

## 1. CHECK THE SHOWER TRAY · ÜBERPRÜFUNG DER DUSCHWANNE

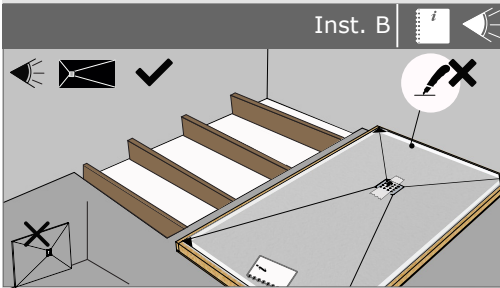

*english*

Check that the shower tray is in perfect condition. Do not use a cutter knife.

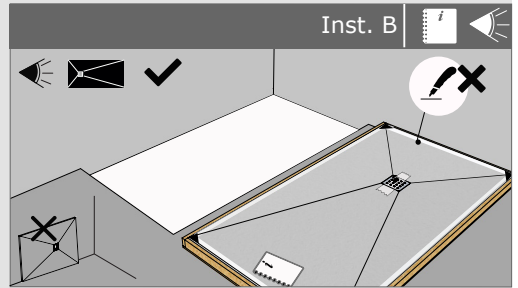

*deutsch*

Vor der Verarbeitung müssen Duschwannen auf Beschädigungen kontrolliert werden

## 2. DRAIN PREPARATION · VORBEREITUNG DES ABLAUFES

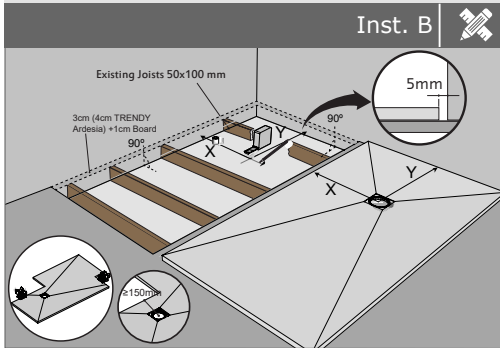

*english*

Measure and mark the center of the drain on the floor. In case of a made to measure tray, install the cut parts on the wall (if possible).

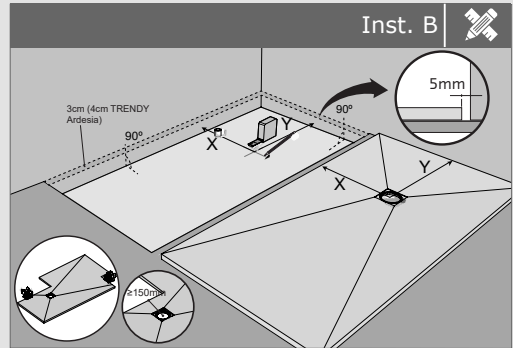

*deutsch*

Abwasseranschluss und Ablaufposition messen und vorbereiten.

## 3. DRAIN INSTALLATION · EINBAU DES ABLAUFES

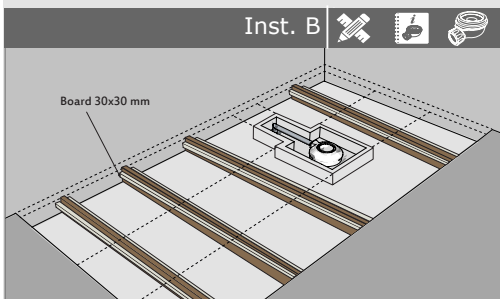

*english*

Install the waste trap provided following manufacturer instructions.

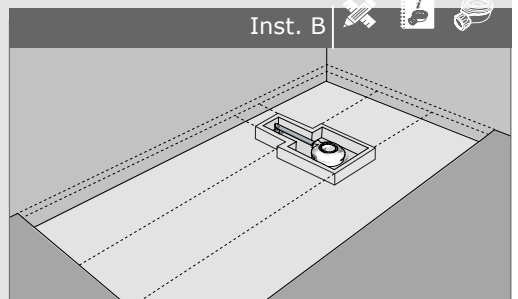

*deutsch*

Ablauf gemäß Hersteller-Anleitung vorbereiten.

#### 4. FLOOR PREPARATION - VORBEREITUNG DES ESTRICHES

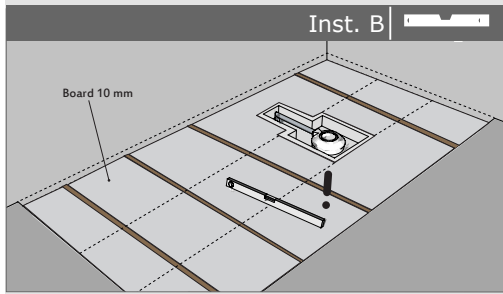

*english*

Install the 10mm board and test that it is well leveled.

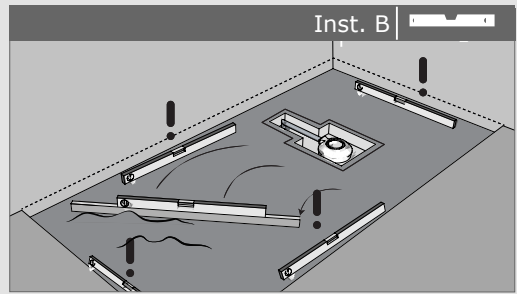

*deutsch*

Estrich legen und Bodenebenheit prüfen.

#### 5. BOARD INSTALLATION (WEDI, ELEMENTS...)

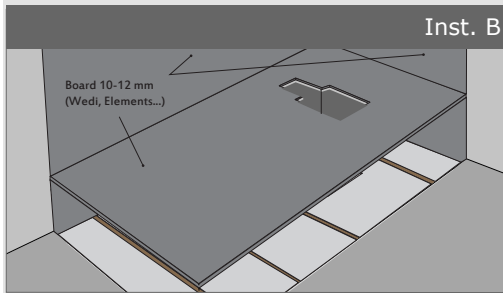

*english*

Install the Wedi board, Elements or similar.

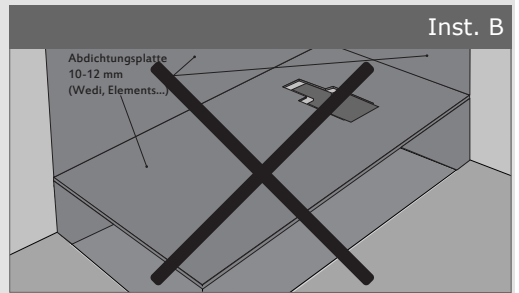

*deutsch*

Die Bauplatte (Wedi, Elements, o.ä.) soll nicht eingebaut werden

#### 6. WATERPROOFING INSTALLATION - EINBAU DER DICHTBÄNDER

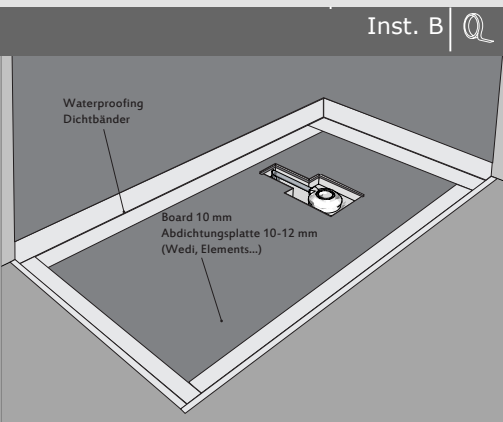

*english*

Install the waterproofing tape around the shower tray and walls.

*deutsch*

Dichtband laut Vorschrift der DIN 18534 installieren.

## 7. TESTING THE DRAIN LEVELS · ÜBERPRÜFUNG DER ABLAUFHÖHE

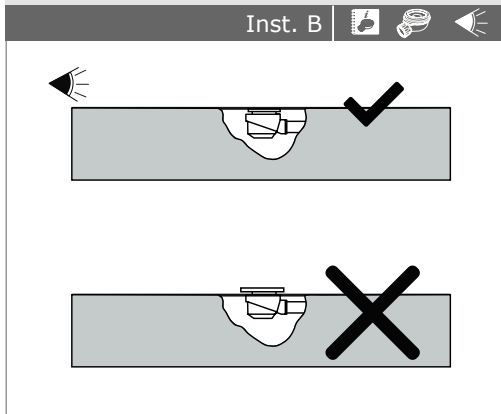

### english

Test that the drain doesn't overhang from the base. Otherwise, it will not work properly.

### deutsch

Der Ablauf soll nicht aus der Bodenhöhe hinausragen.

## 8. SHOWER TRAY INSTALLATION · MONTAGE DER DUSCHWANNE

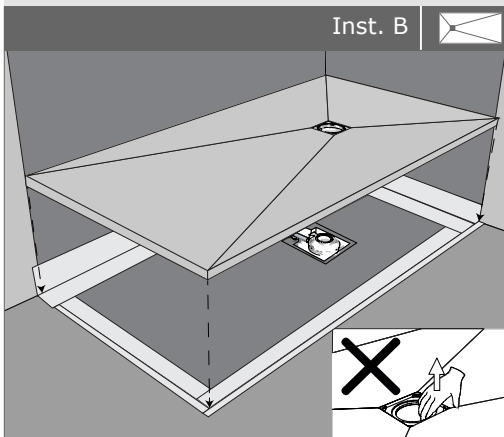

### english

Place the shower tray coinciding the hole with the previously installed drain (depending on the shower tray model).

### deutsch

Duschwanne in Position bringen.

## 9. DRAIN ASSEMBLY · ABLAUFANSCHLUß

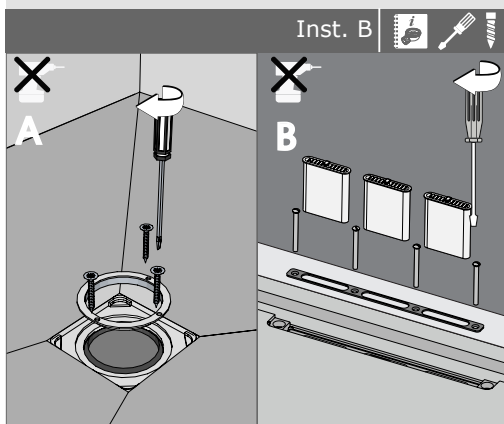

### english

CONSULT DRAIN INSTALLATION GUIDE.

- A** Assemble rubber joint ring piece in the hole of the shower tray, and then assemble the screws with the stainless steel ring.
- B** Place the stainless steel ring on the top of the shower tray using the fastening screws. Insert the siphon.

### deutsch

- A** Ablauf gemäß Hersteller-Anleitung mit einem Schraubenzieher anschließen. WICHTIG Bitte keinen Akkuschauber verwenden!
- B** Die Edelstahlchiene auf der oberen Seite der Wanne legen und mit den Schrauben an das Ablaufsystem anschließen. Die Siphon-Trichter in die Ablauföffnungen einsetzen.

## 10. CHECKING THE DRAIN - ABLAUFPRÜFUNG

Inst. B

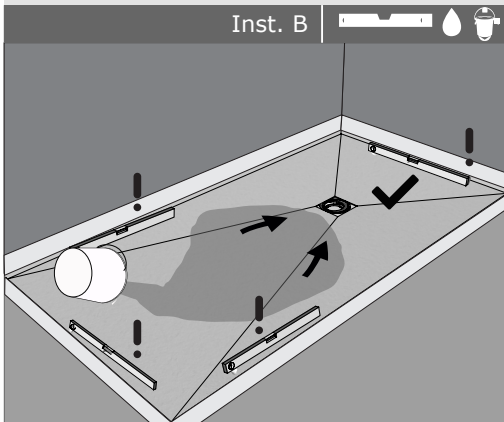

*english*

Check that the shower tray drains properly and that it is level.

*deutsch*

Ablaufprüfung durchführen und das richtige Gefälle der Duschwanne kontrollieren.

## 11. FIT THE SHOWER TRAY AFTER CHECKING - VERKLEBUNG DER DUSCHWANNE NACH ÜBERPRÜFUNG

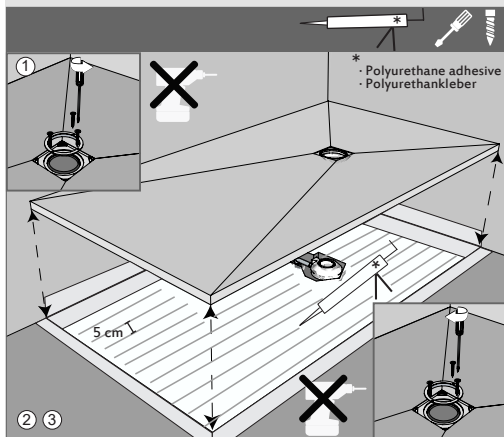

*english*

- ① Disassemble the waste trap.
- ② Take off the shower tray.
- ③ Fix the shower tray to the supporting base using ULTRABOND (Mapei) applied in 10 mm strips with a distance of 5 cm and check that is leveled.
- ④ Assemble again the waste trap.

*deutsch*

- ① Ablauf lösen
- ② Duschwannen entfernen.
- ③ Empfohlene Kleber für die Duschwannen sind u.a. SIKAFLEX 11FC 11FC (Sika) oder Ultrabond MS Rapid (Mapei) in 10mm Bahnen auf die Duschwannen auftragen mit Abstand von 5 cm untereinander.
- ④ Ablauf anschließen und Ausrichtung der Wanne überprüfen.

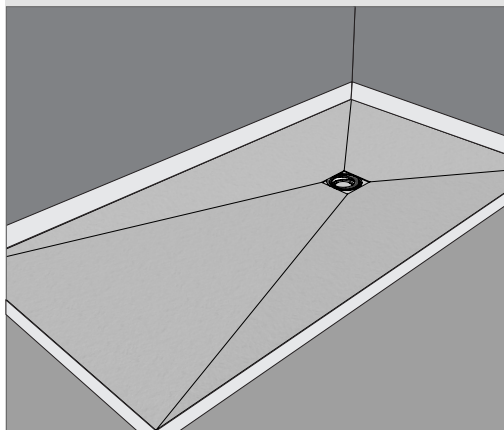

## 12. SEALING AND FINISHING · SILIKONIEREN UND DUSCHWANNE SCHÜTZEN

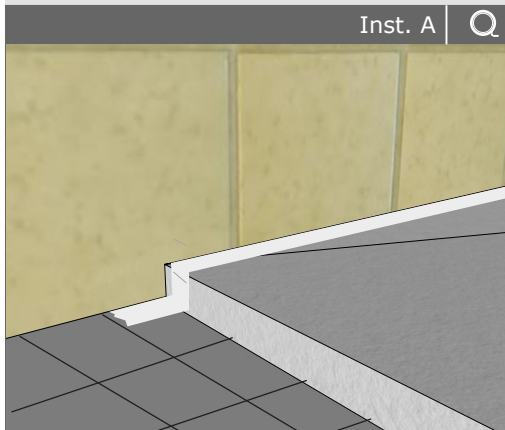

### english

Prepare the base with masking tape before sealing shower tray and walls.

### deutsch

Duschwannenrand mit Klebeband schützen.

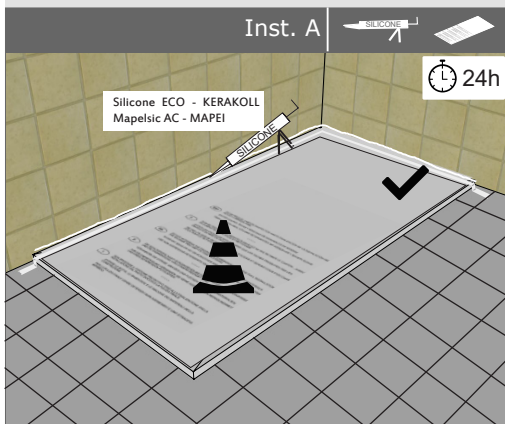

### english

Protect the shower tray with the card board included in the packaging till the work is finished and isolate the joints between the shower tray and walls with silicone. Let it dry for 24 hours.

### deutsch

Die Duschwanne bis die Montagearbeiten im Bad vollständig abgeschlossen sind vor Beschädigungen mit dem dazu gelieferten Karton schützen, und die Fugen zwischen Duschwanne und Wände silikonieren (Silikon ECO - KERAKOLL, Mapesil AC - MAPEI). 24 Stunden trocken lassen.

## 13. DETAIL SEALING AND FINISHED · EINBAUSKIZZE LAUT VERSCHIEDENER EINBAUMÖGLICHKEIT

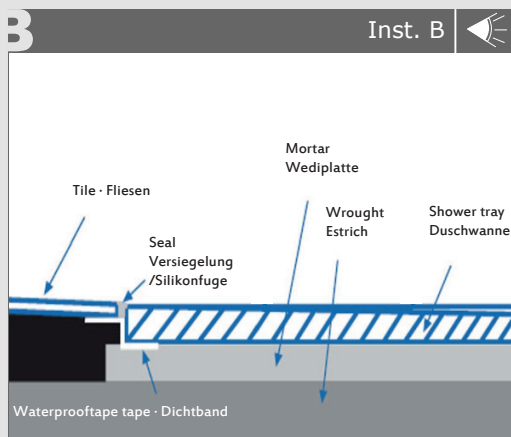
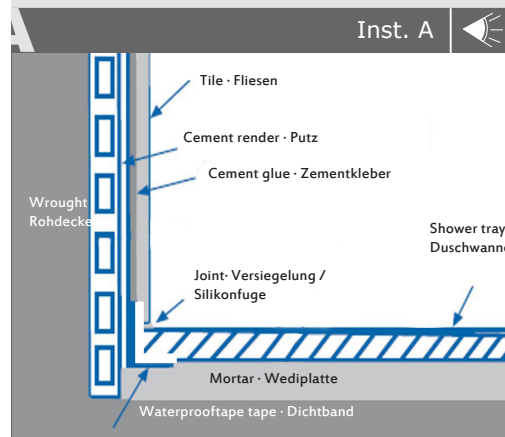

## 14. CLEANING UP AFTER THE WORK · REINIGUNSHINWEISE

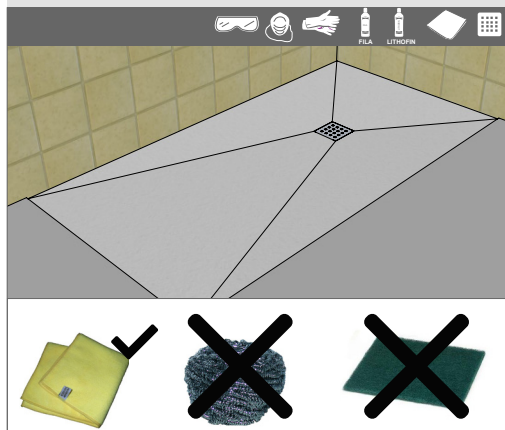

### english

To clean up we suggest to use DETERTEK from FILA, fuga soap, or similar. NEVER USE A SCOURER (SCOTCH BRITE OR SIMILAR), neither solvents, acid or abrasive products. Use gloves, protective mask and glasses.

### deutsch

Mögliche Zement oder Mörtelreste mit entsprechenden Zementschleifentferner reinigen. Empfohlene Produkte sind Detertek (FILA) oder Hybrid Flex (Schuhböcks). Verwenden Sie niemals scheuernde Reinigungsmittel, Lösungsmittel oder Scheuerschwämme. Für Ihre Sicherheit empfehlen wir die Verwendung von Mundschutz sowie Handschuhe.

## 15. INSTALLING THE SHOWER ENCLOSURE · EINBAU DER DUSCHABTRENNWAND

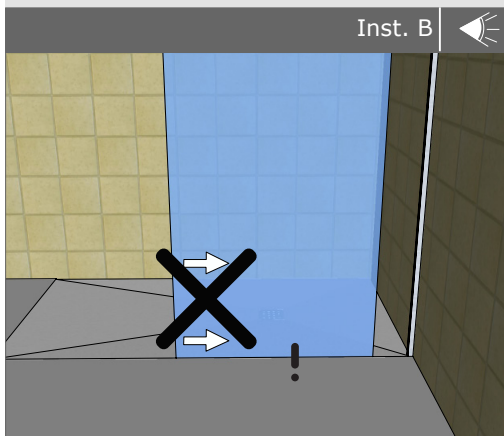

### english

**WARNING!** Never slide the metallic profiles or glass on the shower tray to prevent scratching the tray.

**WARNING!** Don't let to fall silicone rests on the tray while installing the shower enclosure.

### deutsch

**ACHTUNG – Glaswände, Metallprofile und sonstige Komponente zum Einbau der Duschabtrennung nicht über die Duschwanne ziehen, da diese Kratzer u.a. Beschädigungen verursachen können.**

**Vor dem Silikonieren die Wanne mit Klebeband schützen.**





## 2. USE AND MAINTENANCE

To enjoy your shower tray for years, please follow this simple tips:

For **routine cleaning** simply rinse with a mild ( non-abrasive ) cotton dish cloth with water. NEVER USE PADS ( SCOTCH BRITE or NATURAL FIBER ) no SOLVENTS , ACID, ALKALI OR ABRASIVE . After using any cleaner it is necessary to rinse abundantly with soap and water in order to remove any traces of cleaning products. Ensure sufficient ventilation of the bathroom .In cases of stubborn stains you can use the so-called "magic erasers" which can be purchased at any supermarket.

Avoid contact with lacquer, nail polish remover , organic solvents , alcohols , acids, Alkalis,etc.

If you are going to use hair dyes, rinse the shower tray with water and soap when finished.

To remove any traces of lime that can stay in the panel , use a limescale cleaner (Viakal) lowering 1:3 with water (1 L Viakal by 3 L of water) as follows:

- Apply with a wet cloth over the entire surface.
- Leave on for 15 minutes and after that time rinse thoroughly.
- Place the grid again and rinse the shower tray with water again.
- Not recommended for outdoor use.

## 2. REINIGUNGS- UND PFLEGEHINWEISE

Für die tägliche Reinigung reicht es aus, die Duschwanne mit Wasser abzuspülen und für eine ausreichende Lüftung des Badezimmers zu sorgen. Für eine sorgfältige Reinigung sollte mit Wasser und handelsüblicher Seife, sowie einem nicht scheuernden Schwamm oder Baumwolltuch (raue Scheuerschwämme, Bürsten sind zu vermeiden) geputzt und abgespült werden. Vermeiden Sie Desinfektionsmittel, die Säuren oder Lösungsmittel enthalten.

Sollten dennoch Flecken entstehen können handelsübliche Entkalkungsmittel wie ANTIKAL,

FROSCH, VISS, oder ähnliche Mittel in folgender Weise verwendet werden:

- Entkalkungsmittel mit Wasser im Verhältnis 1:3 (1 Liter Entkalkungsmittel zu 3 Liter Wasser) verdünnen.
- Das Ablaufgitter entfernen. Mit einem feuchten Tuch auf der ganzen Fläche verteilen und ca. 15 Minuten einwirken lassen.
- Danach mit viel Wasser abspülen. Wenn nötig mehrmals wiederholen. Zum Abschluss das Ablaufgitter einsetzen.
- Nicht für den Außenbereich geeignet



## FAQ'S · HÄUFIG GESTELLTE FRAGEN

### 3. FAQ'S

#### 1. What products may I use to clean the trays after the installation?

To clean any traces of glue and cement mortar joints use a descaler called Fugasoap (KERAKOLL), DETERDEK from FILA brand, because it is specific for the removal of debris from construction works , also used for the removal of other components such as salt , rust and cal , please read the instructions. DO NOT RUB , let the product act; NEVER USE PADS ( SCOTCH BRITE , or NATURAL FIBER ) nor SOLVENTS , ACID, ALKALI OR ABRASIVE . After cleaning, rinse thoroughly and ensure sufficient ventilation of the bathroom . It is not dangerous for the user and not dangerous for the environment .

#### 2. What products may I use to clean my shower tray and worktops Daily?

Soap and water applied with a non-abrasive sponge. NEVER USE PADS ( SCOTCH BRITE , or NATURAL FIBER ) nor SOLVENTS , ACID, ALKALI OR ABRASIVE . In case of stubborn stains you can use the so-called "magic erasers " which can be purchased at any supermarket.

**3. - Which are the characteristics of the drain?**

The drain is a siphon type and it has a piece that can be taken off to clean it. You only need to take off the Acquabella stainless steel grid to access and pull the handle.

**4. My bathroom has syphon pot, what can I do?**

You may take off the white plastic cylinder and take off the tap, then assemble the cylinder again.

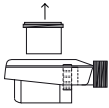

If no siphon is required in the valve, cut 5 cm of the funnel.

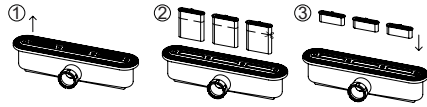

**5. What material may I use for gluing or sealing shower tray?**

The bonding of the various elements must be done using Polyurethane adhesive like ULTRABOND (MAPEIS), SIKAFLEX 11FC (SIKA), SUPERFLEX (KERAKOLL) and sealing with grouting ceramic material or nonacidic silicone.

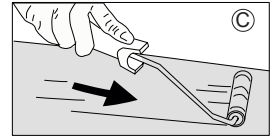
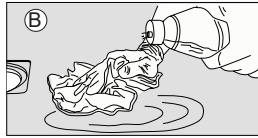
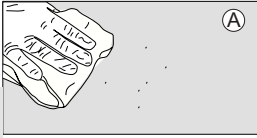

#### 4. SHOWER TRAY REPAIR INSTRUCTIONS

It is possible to repair the colour of a shower tray if for some reason its surface has been damaged by improper use. In these cases you can request a repair kit remember to specify the correct texture and colour of the panel to repair. The kit consists of two containers, A and B.

Procedure to repair a shower tray:

- Clean the surface of the panel very well. Water meths or acetone diluted can be applied with a lint-free cloth. Images A-B.
- The surface must be completely clean and dry
- Secure with masking tape or similar susceptible areas (tiles, screens, etc.)
- Open the can and the bottle.
- Put the coloured lacquer and catalyst with the small plastic container (that its part of the kit) and mix.
- Use a little roller to paint 8 or 10 cm. good quality, long strokes always in the same direction, repeating when if necessary. It is important not release remains. Image C
- Depending on the state of the area to restore, you may need to apply several coats of paint. Allow this to dry for at least 40 minutes before applying the next coat
- Let it dry for 48 hours before removing the masking tape protection.

**CAUTION:** for your safety, use mask and gloves as you are working with chemicals