



## SAFETY WARNING

Before use please read carefully and use in accordance with these safety instructions.

Before commencing any electrical work ensure the supply is switched OFF at the mains. Either by switching off the consumer unit or by removing the appropriate fuse. This product should be installed in accordance with the relevant sections of the building regulations code and in accordance with the latest edition of IEE regulations (BS 7671).

If the unit is to be used as a replacement for an existing product, remove the existing unit from its location and disconnect the wiring. Connect the wires as shown in diagram. Ensure terminals are properly tightened and ensure no bare wires are visible. When pushing back into the backbox ensure no wires are trapped. Read the instructions carefully before starting the installation process and keep them safe for future reference.

**IF IN ANY DOUBT, PLEASE CONTACT A QUALIFIED ELECTRICIAN.**

## SWITCHES MUST BE INSTALLED BY A QUALIFIED ELECTRICIAN

## SPECIFICATION

### WARNING: DO NOT EXCEED THE LOAD RATING AS SHOWN ON THE BACK OF THE PRODUCT

#### Touch and Touch & Remote On/Off Switches:

1 Gang	3 - 1000watts
2 Gang	3 - 500watts (500 watts per gang)
3 Gang	3 - 333watts (333 watts per gang)

#### 1 Gang Touch and Touch & Remote Dimmer Switches:

LED\*/Halogen/Incandescent: 3 - 100W

#### 2 Gang Touch & Remote Dimmer Switches:

LED\*/Halogen/Incandescent: 3 - 50 watts (50 watts per gang)

Voltage:	220~240V ~ 50/60Hz
Working Temperature:	0°C~40°C Relative
Humidity:	10% - 93%
Energy Consumption:	<0.02W
Measurement:	86x86mm
Backbox depth:	35mm
Life:	100,000 operations (relay life)
Remote usage distance:	>10M
Remote battery:	27A 12vDC
Battery life:	1 year (dependent on usage)

**Note:** Our dimmer switches are not suitable for use with fluorescent loads, including energy saving lamps and certain non dimming LED bulbs.

\*Not all LED bulbs are compatible and depends on brand, please call for more information.

## INSTALLATION

**1. Power Off:** Turn off the mains power before starting any installation.

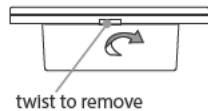

**2. Remove the glass panel:** Using a flat screwdriver align to aperture on the bottom of cover and twist and lift to unclip. Be careful not to damage the glass.

**3. Wiring:** Wire as described as per the diagram. Push wires firmly into terminals and tighten terminal screws to ensure wires are held securely. No bare wires should protrude from the terminals. Ensure correct wires are connected to the correct terminals, if incorrectly wired, this could damage the switch.

**4. Fix screws:** Screw to attach switch to backbox

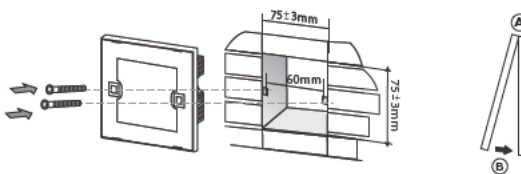

**5. Re-attach the glass Surround:**

Align the glass panel over the switch (A) and firmly push (B) to click into place.

**6. Power on:** Ensure the glass is attached before turning the power is on, wait 2 minutes for the switch to power up, then touch the panel to turn on the light.

**7. For 2 way & intermediate models:**

You will need to pair the gangs, Press and hold a gang on the master wired switch (i) for 5 seconds until you hear a beep. Within 60 seconds press the corresponding gang on the slave switch you want to pair with the master switch - the switch will flash or beep to confirm pairing is successful. Repeat the process for all gangs you want pair.

## WIRING DIAGRAMS

### 1 WAY WIRING

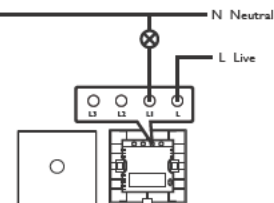

1 GANG

### 2 WAY WIRING

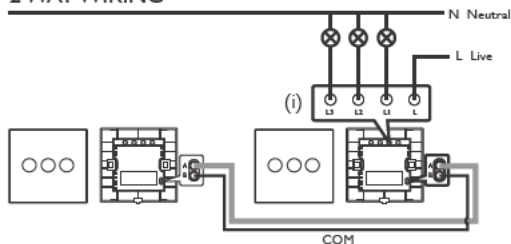

3 GANG

### INTERMEDIATE WIRING

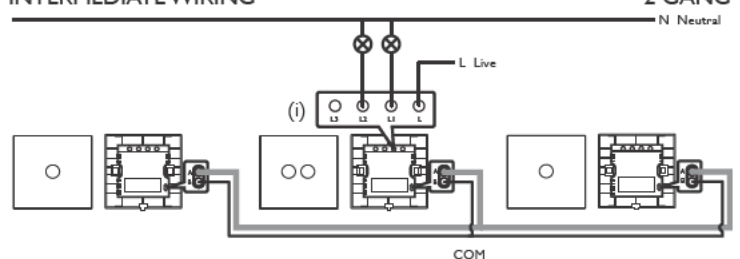

2 GANG



## TOUCH ONLY & TOUCH AND REMOTE SWITCHES ( ON / OFF )

### TO TURN ON

Touch the Circle / Oval to turn on

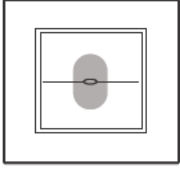

### TO TURN OFF

Touch the Circle / Oval to turn off

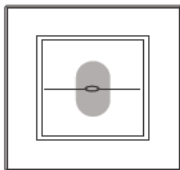

### (REMOTE MODELS ONLY)

#### PAIRING A REMOTE

Step 1. Press and hold the oval/circle gang on the switch for 5 seconds, you will then hear a beep. Once you've heard this beep take your finger of the gang.

step 2. As soon as you've taken your finger of the gang hold down either A, B or C depending on the button you want to work with that gang.

Once you've pair the gang(s) that button (A,B or C) on the remote will only work with that gang.

Four remotes can be paired to each gang, if the maximum amount of remotes registered is reached the first pairing will be deleted.

To switch all gangs off press the button D on the remote.

#### UN-REGISTERING A REMOTE CONTROL FROM THE GANG/SWITCH:

Hold down on the gang for 10 seconds you will hear one beep after 5 seconds and another 5 seconds later.

### USING THE REMOTE

Press A / B / C light turns on  
Press A / B / C again the light turns off  
Press D to switch off all lights that are paired to that remote.



A = 1 gang  
B = 2 gang  
C = 3 gang  
D = All off

## TOUCH DIMMERS & TOUCH AND REMOTE DIMMER SWITCHES

### TO TURN ON/OFF

Touch the Circle / Oval to turn on. The lights shall slowly increase in brightness to the last used level

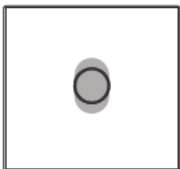

### TO DIM UP/DOWN

Touch & hold Circle / Oval to dim up. Release then touch and hold again to dim down.

### REMOTE MODELS

#### Pairing the remote

Step 1. Press and hold the oval/circle gang on the switch for 5 seconds, you will then hear a beep. Once you've heard this beep take your finger of the gang.

Step 2. As soon as you've taken your finger of the gang hold down either A or B depending on the button you want to work with that gang.

Note: On a 2 gang dimmer the remote will dim 1 gang at a time. The remote will dim up/down the last gang that was turned on.

#### UN-REGISTERING A REMOTE CONTROL FROM THE GANG/SWITCH:

Hold down on the gang for 10 seconds you will hear one beep after 5 seconds and another 5 seconds later.

### USING THE REMOTE

Press A or B to turn lights on to the last used setting and to turn off

Press 'C' and 'D' buttons to dim up and down.



A or B = Turn on / off  
C = Dim up  
D = Dim down

## FAQ'S

Q: The light switch works when the front panel of glass is off but when I put the front glass panel back on it doesn't work.

A: You must insure you have the front panel of glass on the switch whilst the mains power is off. Turn the mains power off for 30 seconds and the put the front panel of glass onto the switch, turn the mains power back on and leave for a further 30-60 seconds. This allows the switch to reset the proximity and will now work.

Q: I have wired the switches and the 1 way is working but the 2 way switch isn't?

A: Ensure you have paired the switches after wiring them, to do this hold onto the gang of the master switch (the switch that has the neutral in L1, L2 or L3) and hold for 5 seconds, you'll then hear a beep. Have someone at the other end of the switch you want to make 2 way and they hold for 5 seconds once you've taken your finger off.

Q: Do I need to use additional wiring on a 2 way or intermediate circuit other than the A to A - B to B?

A: You will not have to use any additional wiring that isn't on the diagram, it is IMPORTANT that you ensure A to A and B to B is wired correctly as they carry the Live/Neutral.

## FACTORY RESET:

Press and hold the oval/circle for 10-15 seconds until you hear a beep (you will hear a beep after 5 seconds but ensure you continue holding until you hear the second beep)

## GUARANTEE

All items purchased, come with a 2 year warranty from date of purchase. Please keep proof of purchase.