

BLUETOOTH GENERATOR  
CONTROL PAD INSTRUCTIONS

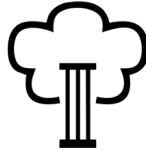

LIVINGHOUSE.CO.UK  
TEL: 01722 415000  
EMAIL: SALES@LIVINGHOUSE.CO.UK

---

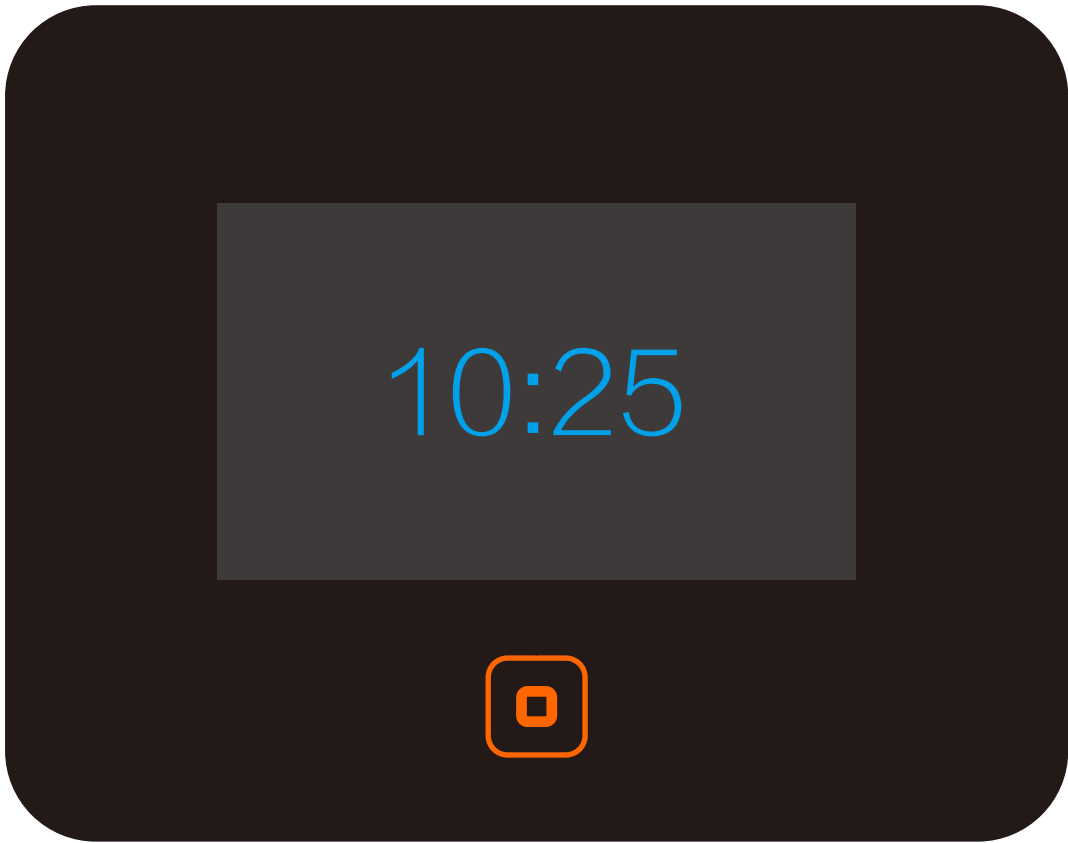

Standby Interface

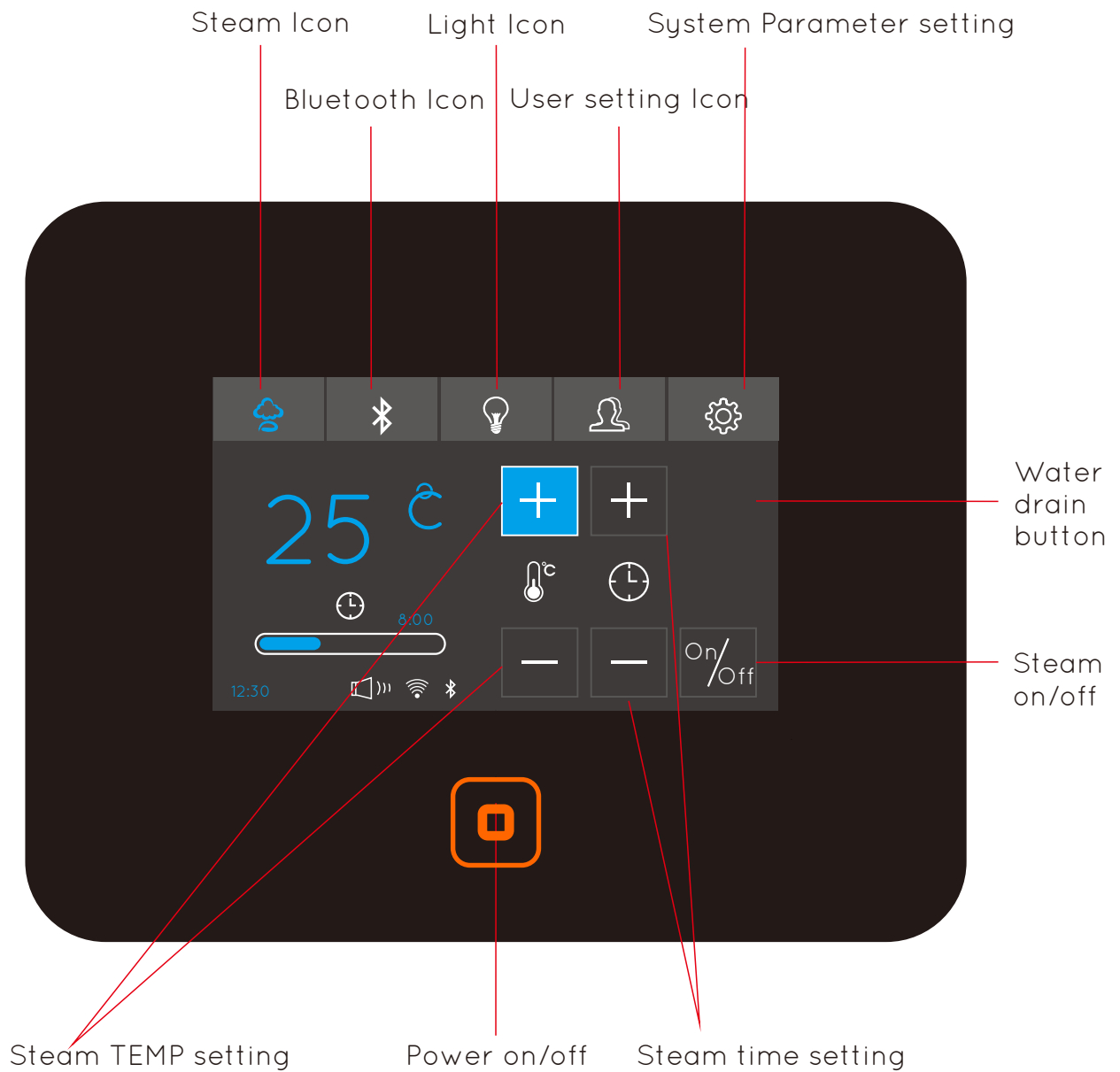

1.Steam on/off: pressing the on/off button to open the steam function.

2.Water drain button: When steam generator shuts off, press this button to drain the generator.

3.Time/TEMP setting:you can press these buttons to adjust the steam working time/TEMP.

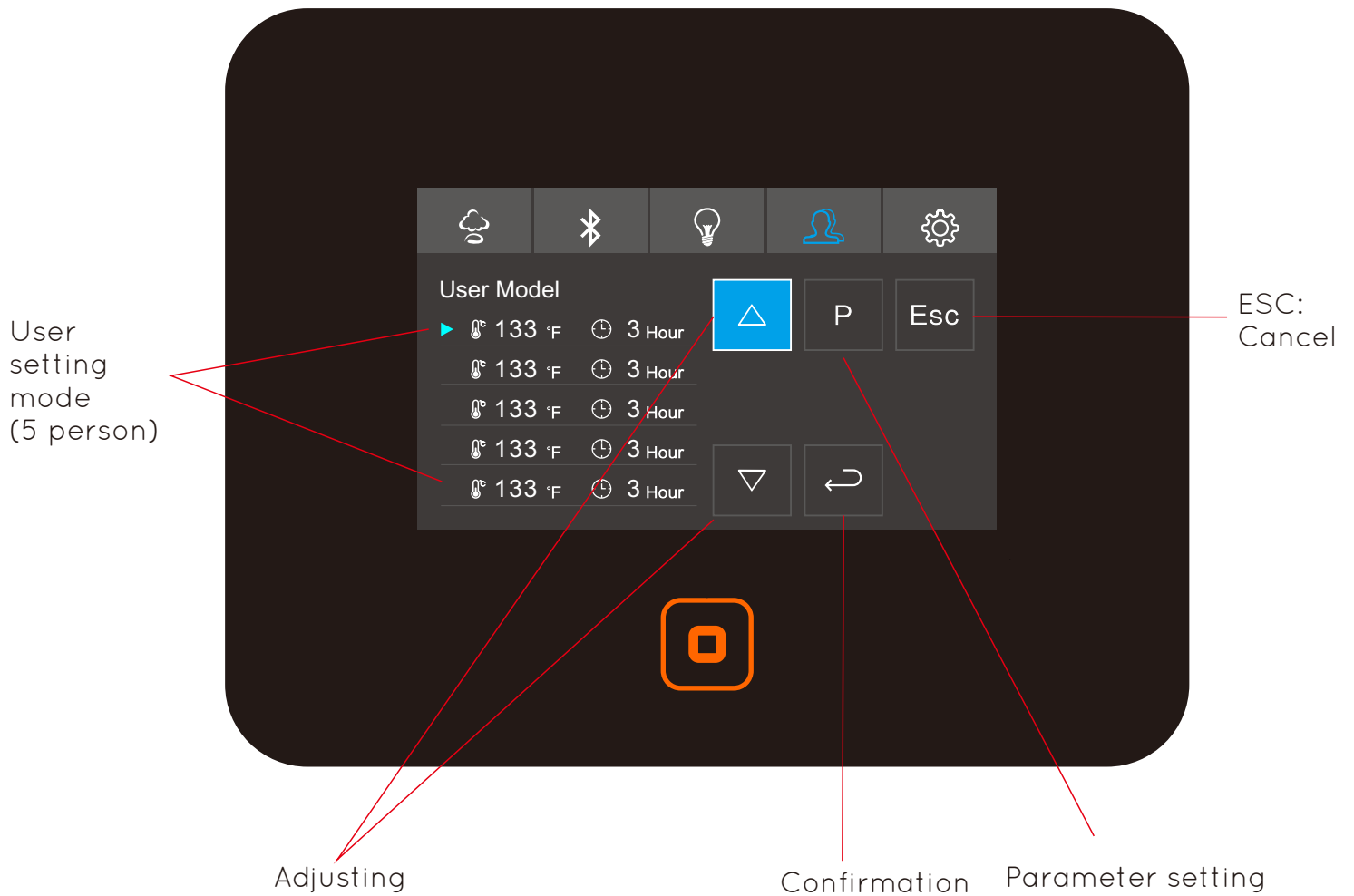

1. Enter user setting mode - choose one of the user modes by adjusting button
2. After selecting, press confirmation button to enjoy the steam programmed with this user setting.
3. After choosing the user mode, you can press the parameter setting button to edit the setting of this user, you can also press the confirmation button after setting or press ESC button to cancel the setting.

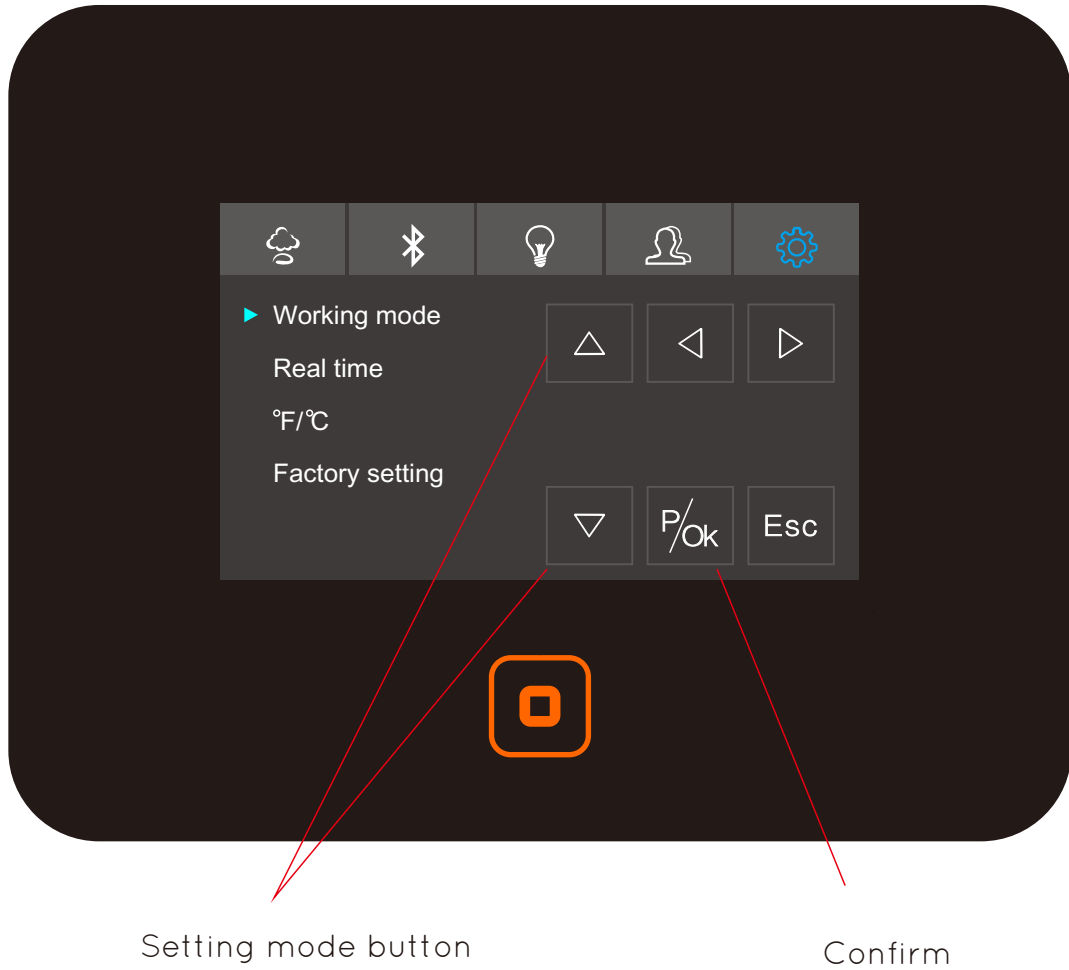

## System Parameter setting Interface

Press the setting mode button to select modes you require including working mode, Real Time, °C&F switch, factory setting, after making a choice press confirmation button to enter into relative parameter setting.

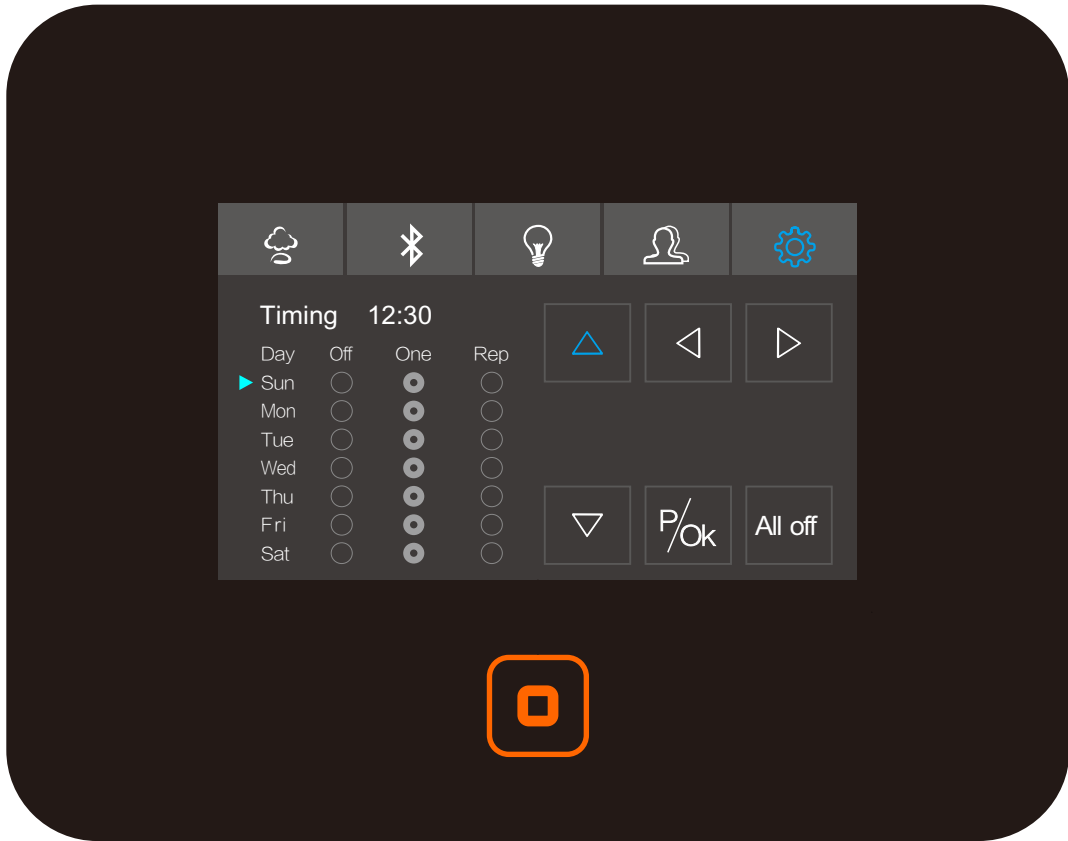

## Reservation start up time

You can set the steam start up time on the interface such as Date and Start Up time. It can also be set for working one time use or repeated every week.

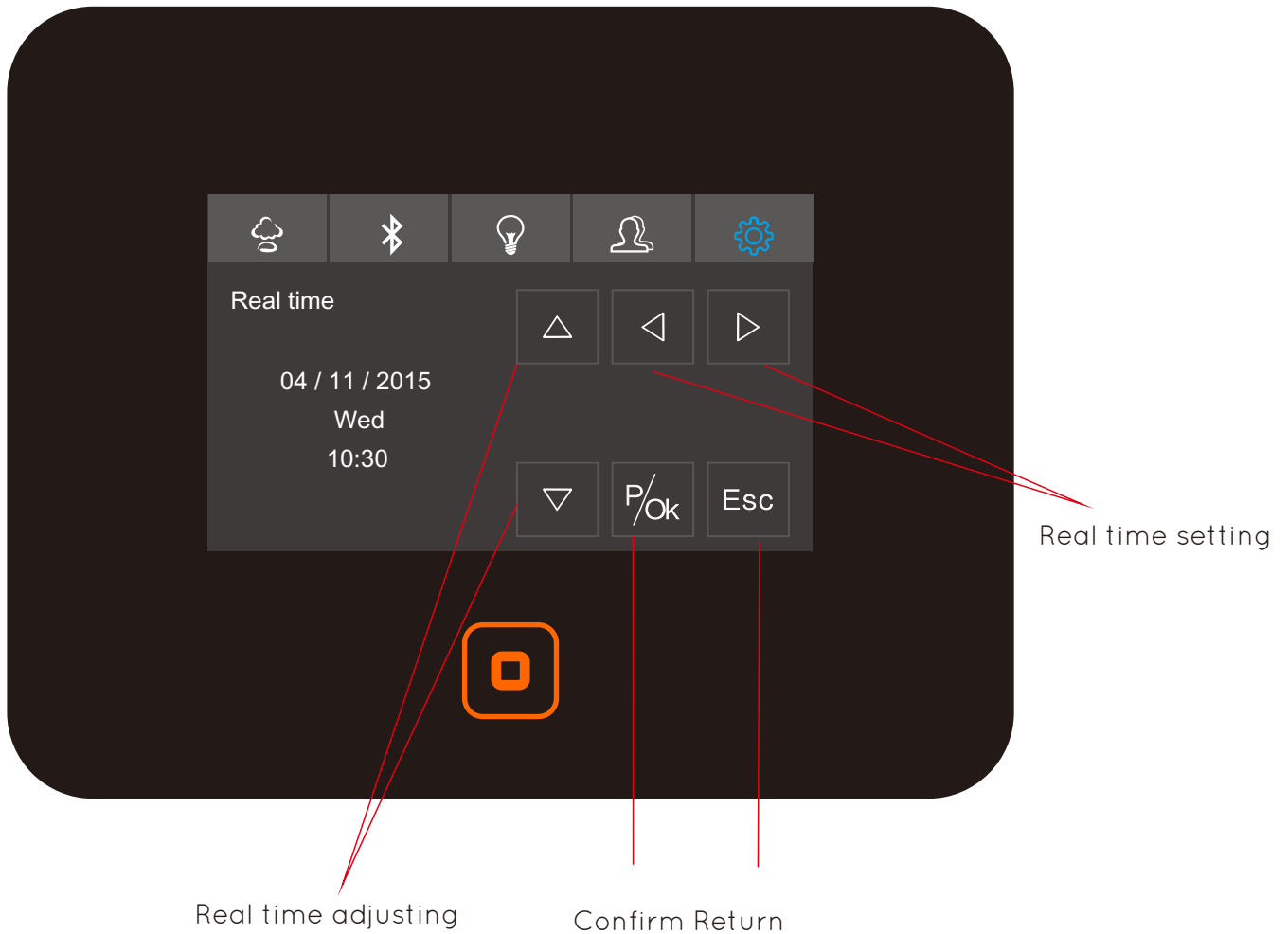

## Real time setting

1. Press real time setting button to set time
2. Press real time adjusting button to adjust time
3. Press confirm button to save the real time setting
4. Press ESC to cancel existing time setting

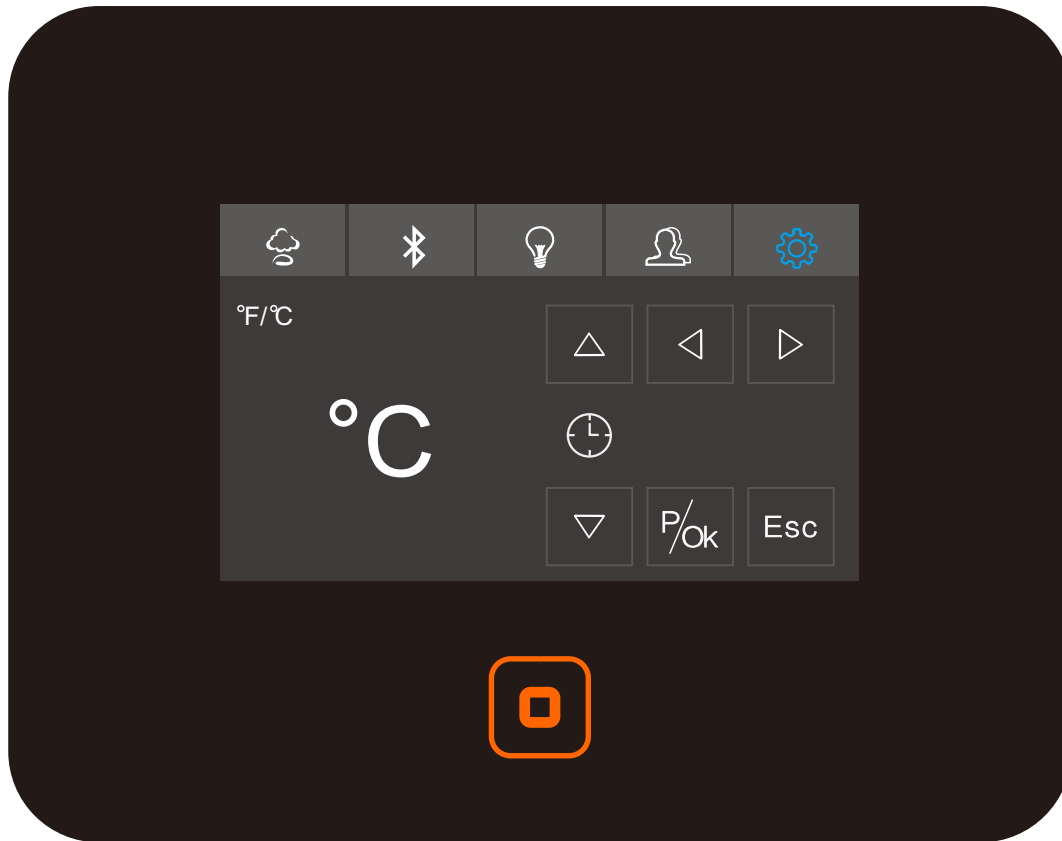

## Celsius and Fahrenheit

Press adjusting button to switch between Celsius and Fahrenheit, followed by pressing OK to save the TEMP unit setting for future using.



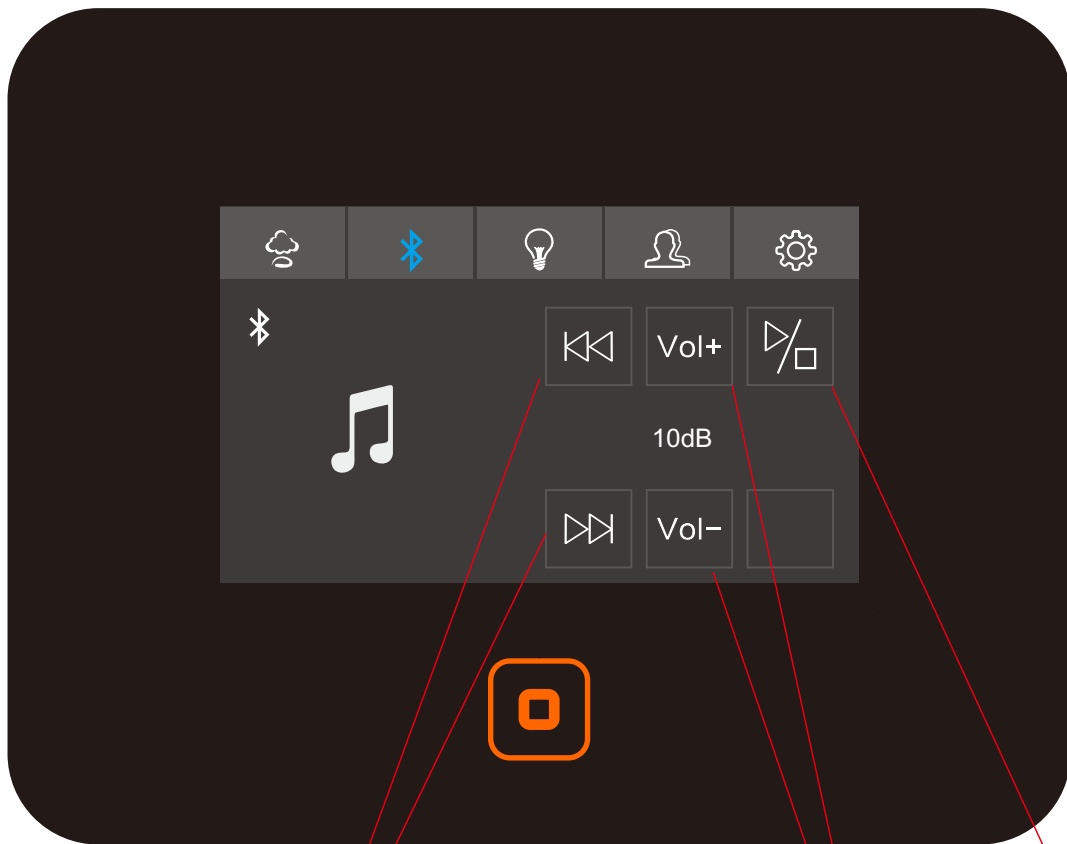

Song switch

Volume adjusting

Song Pause

**Bluetooth( need to connect with Multimedia player)**

After connecting with Multimedia player, you can control the music switch, volume and display statue.

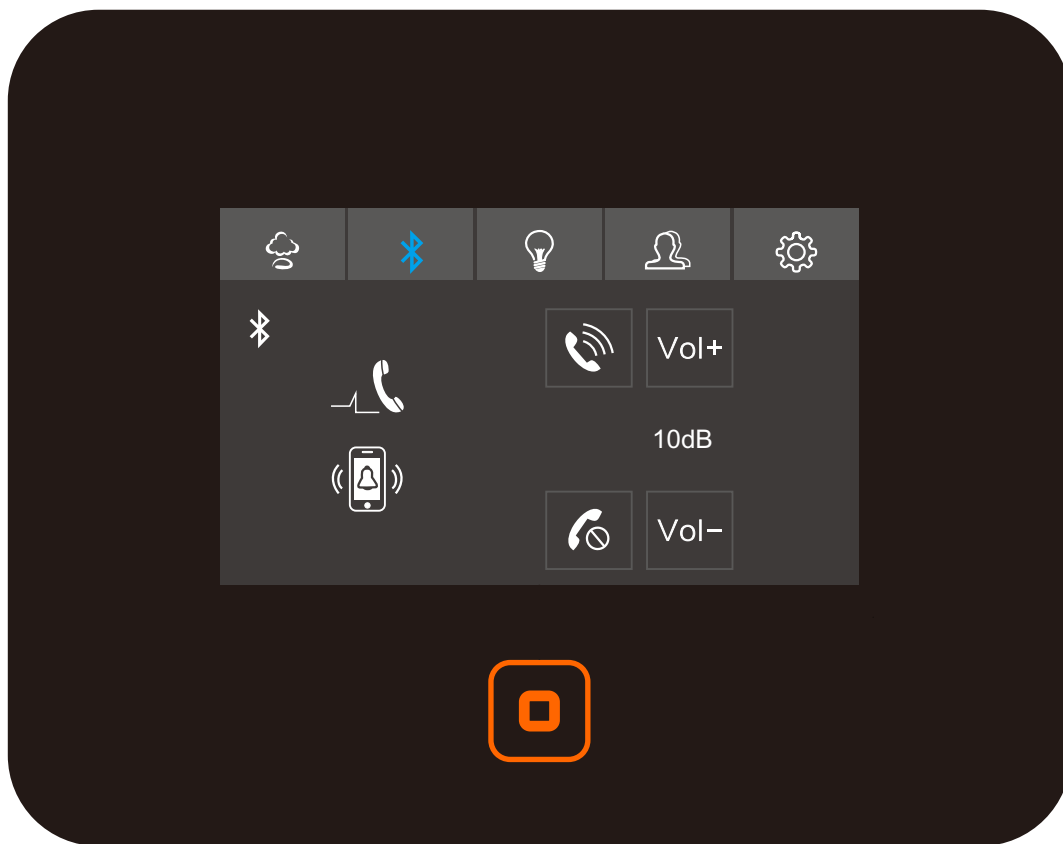

## Bluetooth phone receiver interface

Allows you could to answer the phone call via the bluetooth phone receiver interface.

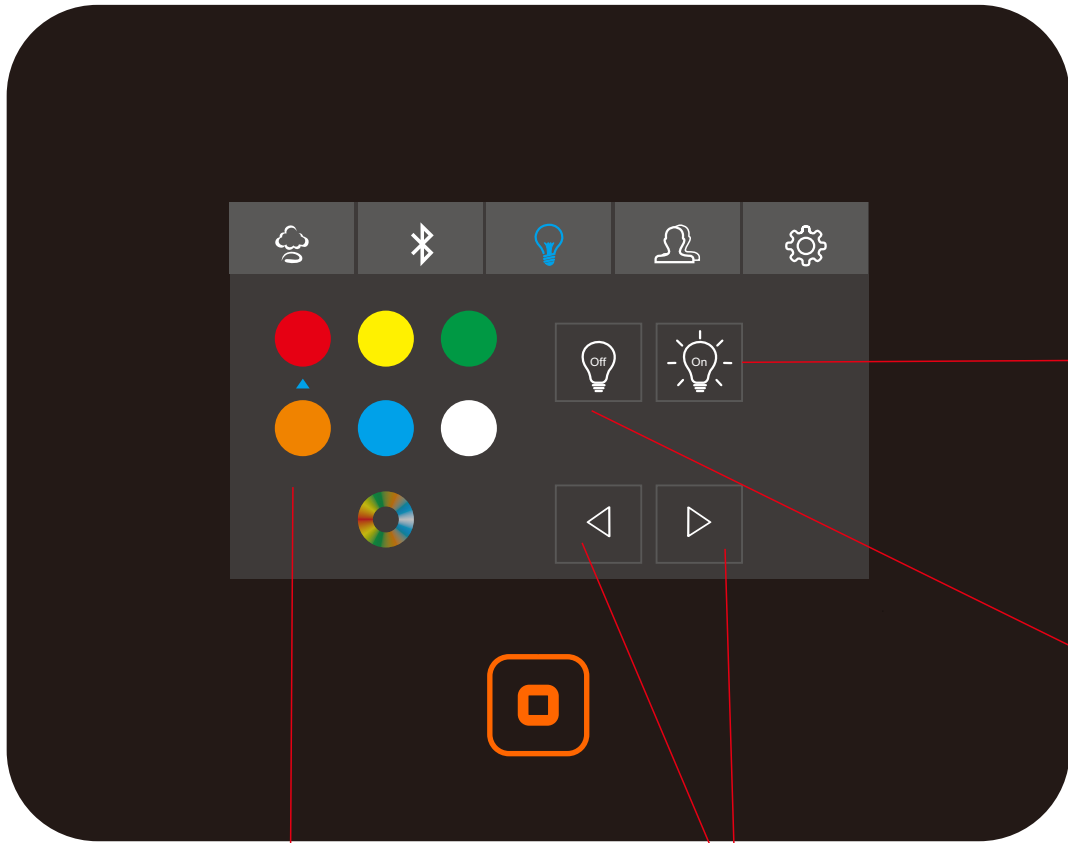

Light ON/OFF

Chroma light power off button

Light color indicator

Chroma light color changing

## How to Reset to Factory Settings

To revert the control back to factory settings:

Go to Settings. 

Move arrows to "Factory Settings".

Short press "OK" to restore factory settings.

Long press "OK" for 2 seconds to restore the WIFI setting data.



LIVINGHOUSE.CO.UK

TEL: 01722 415000

EMAIL: SALES@LIVINGHOUSE.CO.UK

---