

Doc M Compliant Folding Shower Seat (DMS1)

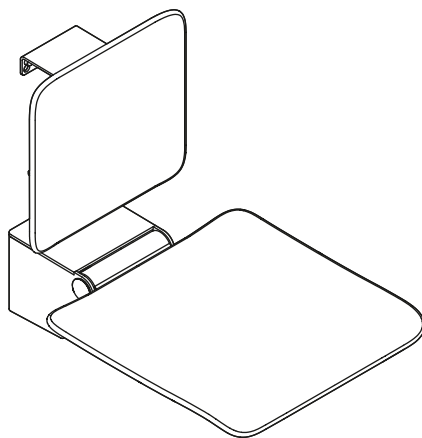

Installation and operating instructions



LIVINGHOUSE.CO.UK

TEL: 01722 415000

EMAIL: SALES@LIVINGHOUSE.CO.UK

Intended purpose

The removable hanging seat is designed for use in bathrooms, especially showers. It provides the option to sit down while taking a shower for persons with or without physical disabilities.

Exclusion of liability

Livinghouse accepts no liability whatsoever for damage to persons or property that occurs or has occurred as a result of improper mounting or maintenance, particularly if the safety instructions and other points to note listed are not or have not been observed in full. Livinghouse accepts no liability whatsoever for damage occurring from incorrect cleaning.

Warning notices



CAUTION!

Comply with the intended purpose, stated maximum load and fixing instructions.

Safety instructions

These instructions are intended for qualified skilled personnel and the user of the installed product. Following installation, the instructions must be made available to the user.

- Follow with the installation instructions and instructions for use.
- In case of questions, problems, uncertainties or if damage occurs, contact the Livinghouse support service.
- Ensure that the product is installed, maintained and repaired by qualified, skilled personnel only.
- Check the product for damage on acceptance. Report defects immediately.
- Install/use the product only:
 - in accordance with its intended purpose
 - in its original condition without modifications
 - in perfect condition
- Use original spare parts only.
- Use only Livinghouse fixing materials.
- Only use in closed rooms.
- Ensure that the wall structure can permanently withstand the expected load. Lightweight construction must be appropriately lined at the back.

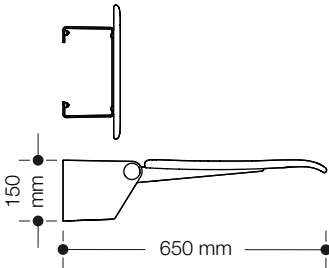
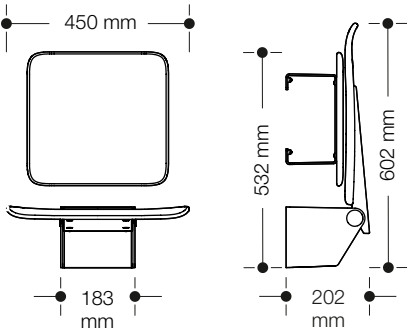
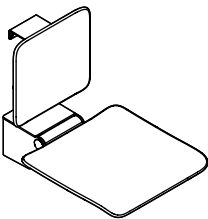

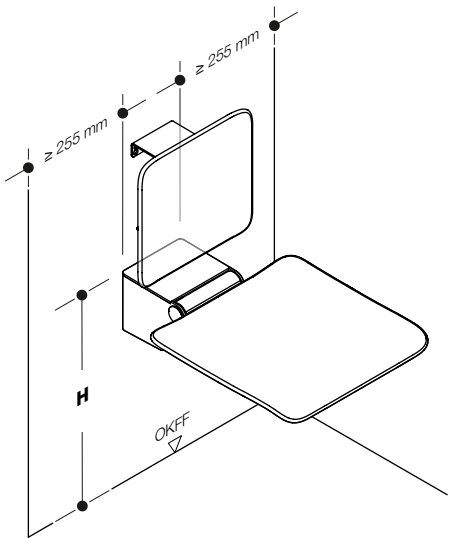

Observe any differing or updated country-specific specifications!

	DE, NL, I, PL	AT	CH	F	UK	B	DK
H	460-480 mm	460-480 mm	460 mm	450-500 mm	480 mm	500 mm	500 mm

Tools required

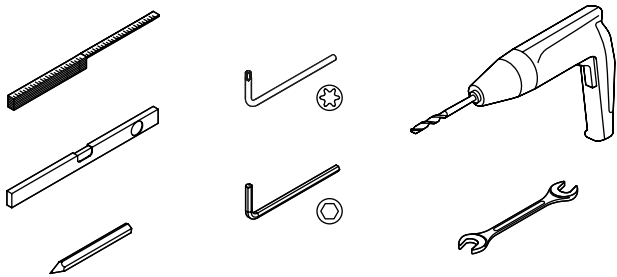

Mounting information

- LH10.2 – Concrete (synthetic dowel)
- LH11.2 – Aircrete
- LH12.2 – Lightweight walls with rear lining
- LH13.2 – Lightweight walls with steel plates
- LH17.2 – Concrete
- LH18.2 – Solid/perforated brick, lightweight concrete

Please specify upon ordering.

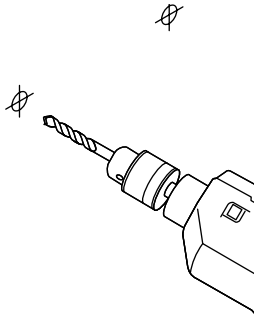
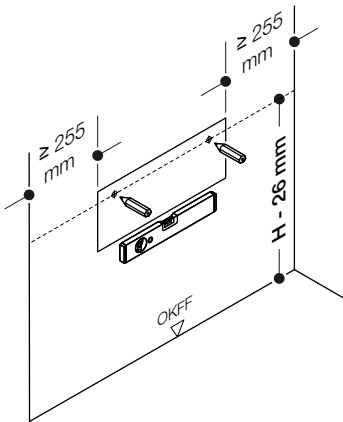

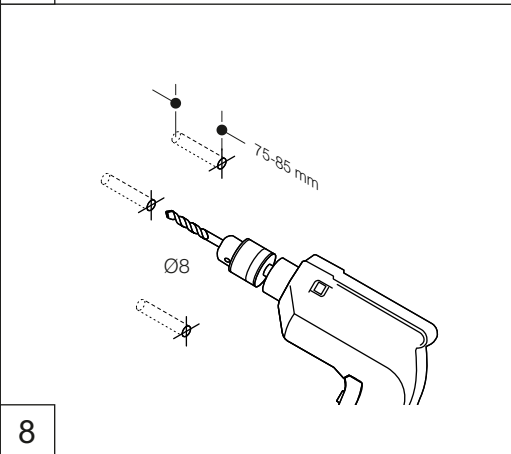
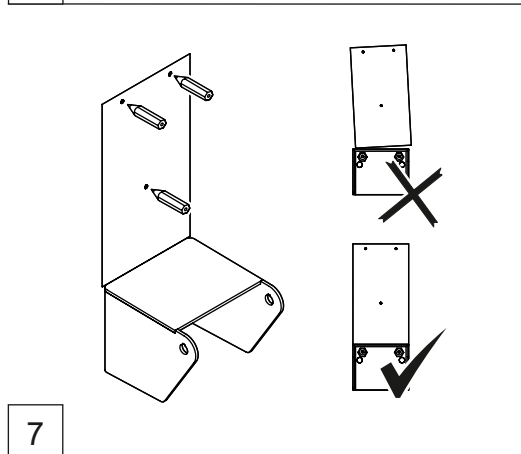
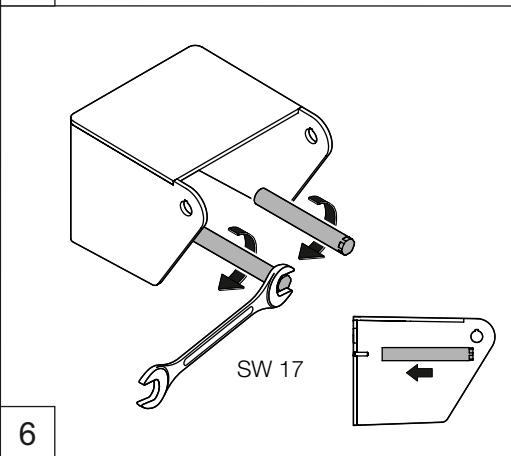
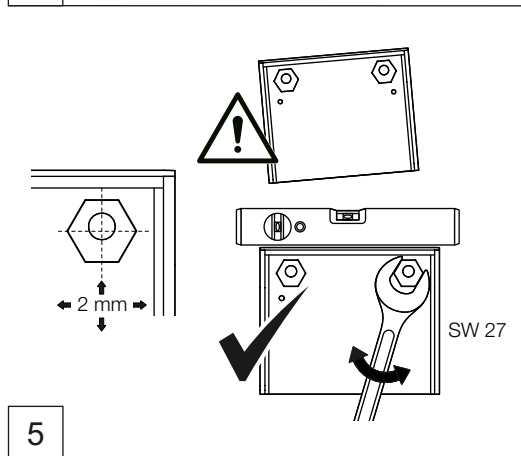
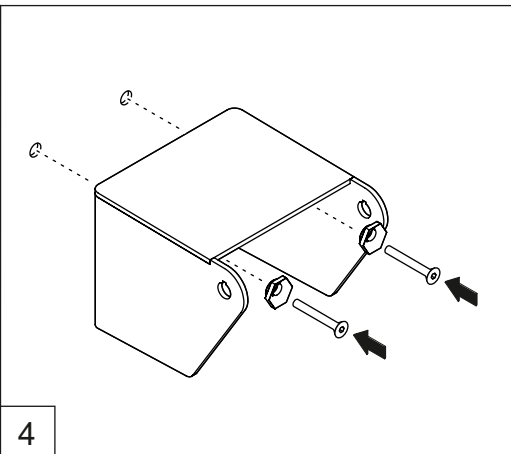
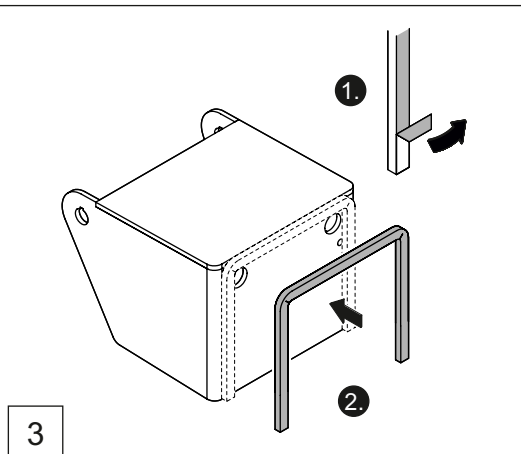

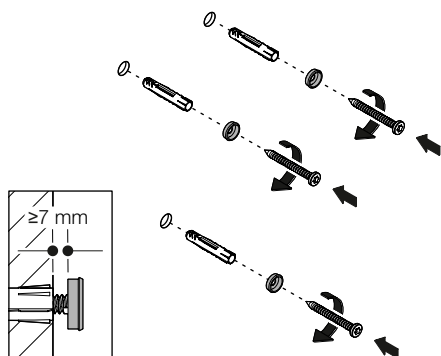

9

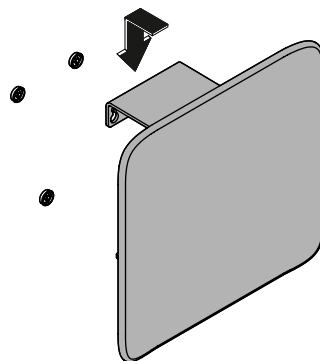

10

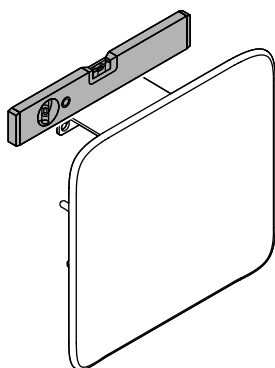

11

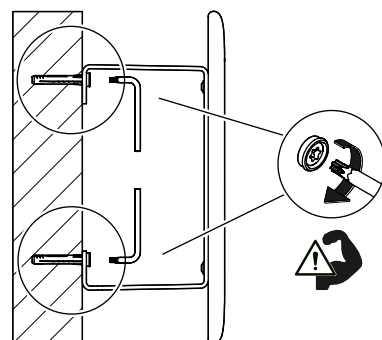

12

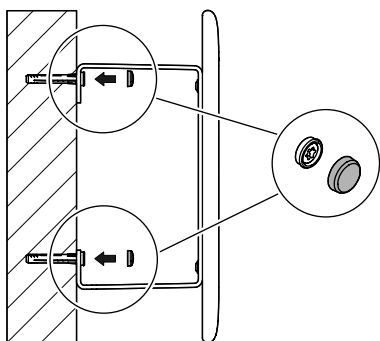

13

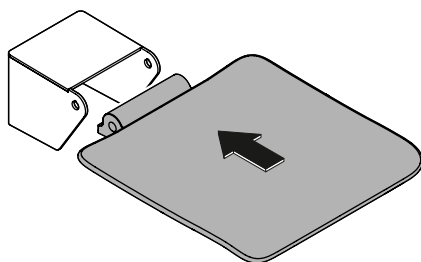

14

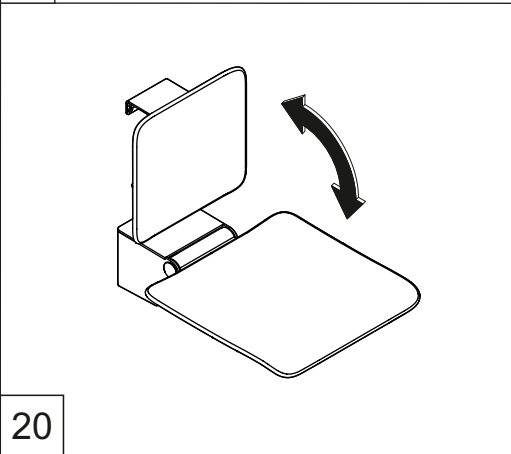
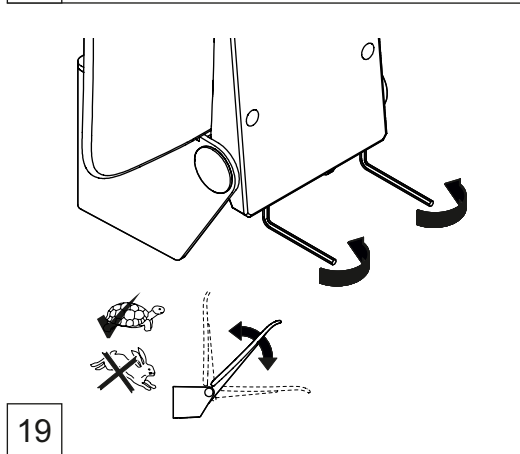
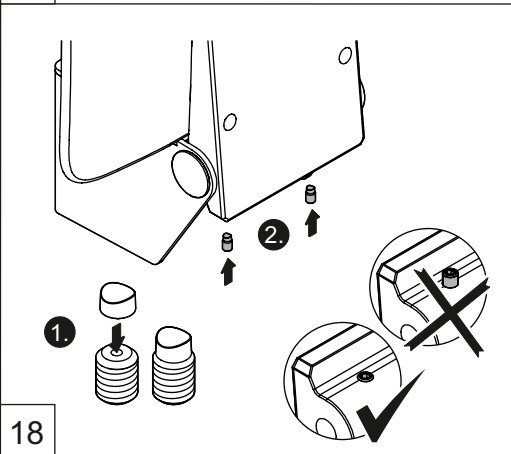
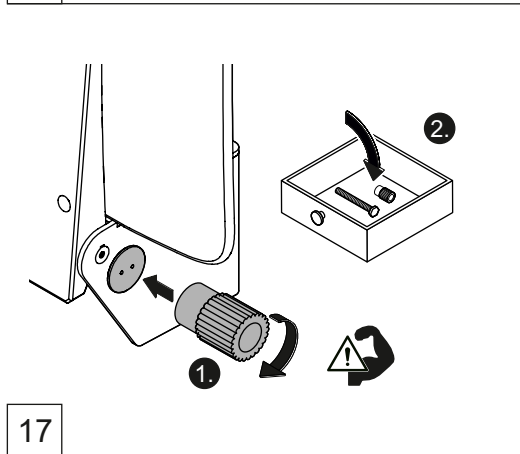
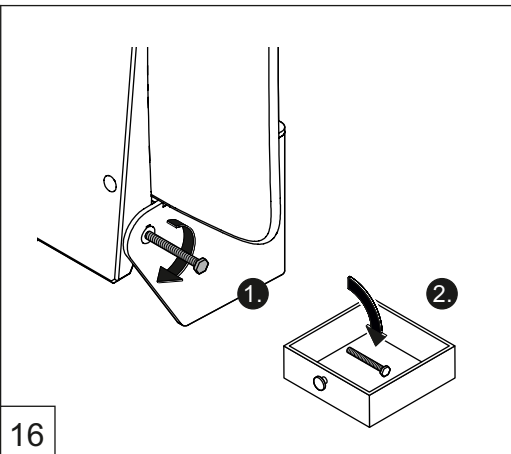
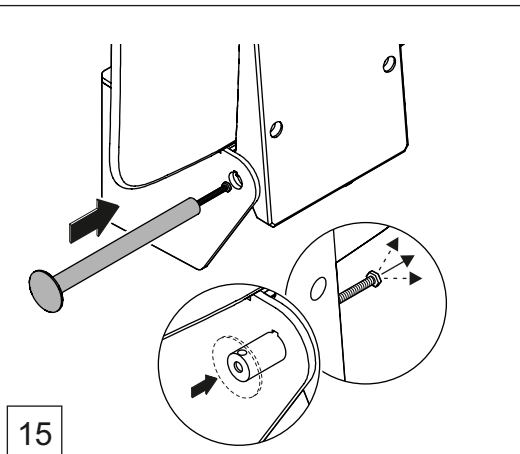

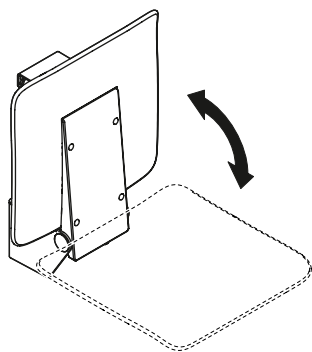

Fold up when not in use.

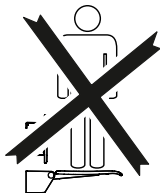
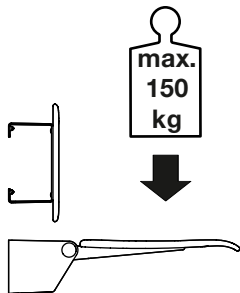
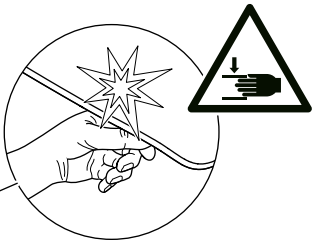
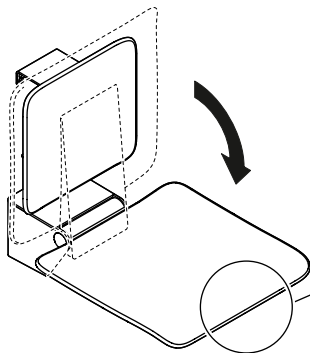

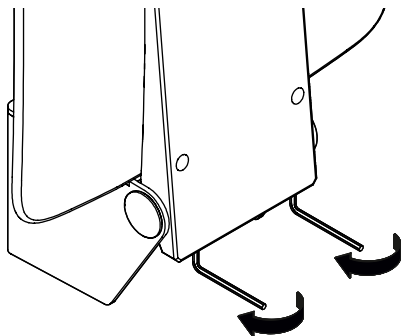

1

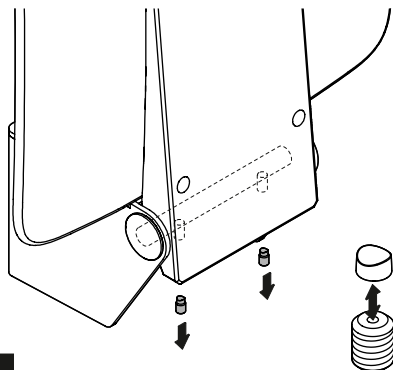

2

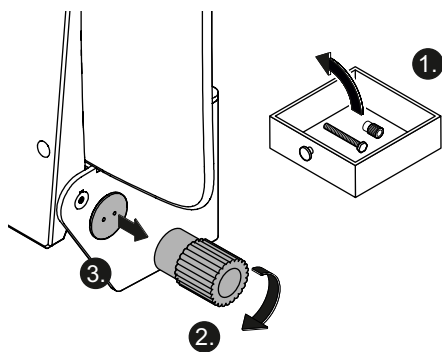

3

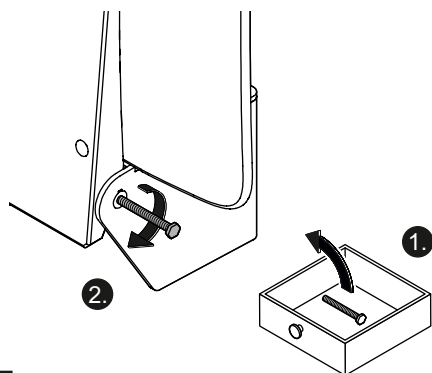

4

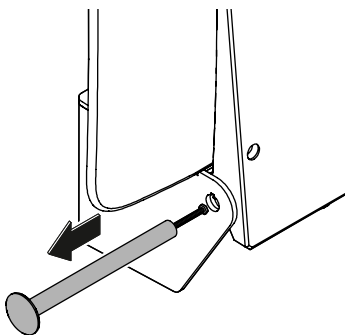

5

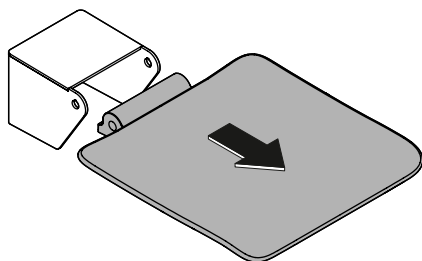

6

