

Pivot Framed Interior Contemporary Door (PVT1)  
Assembly Manual

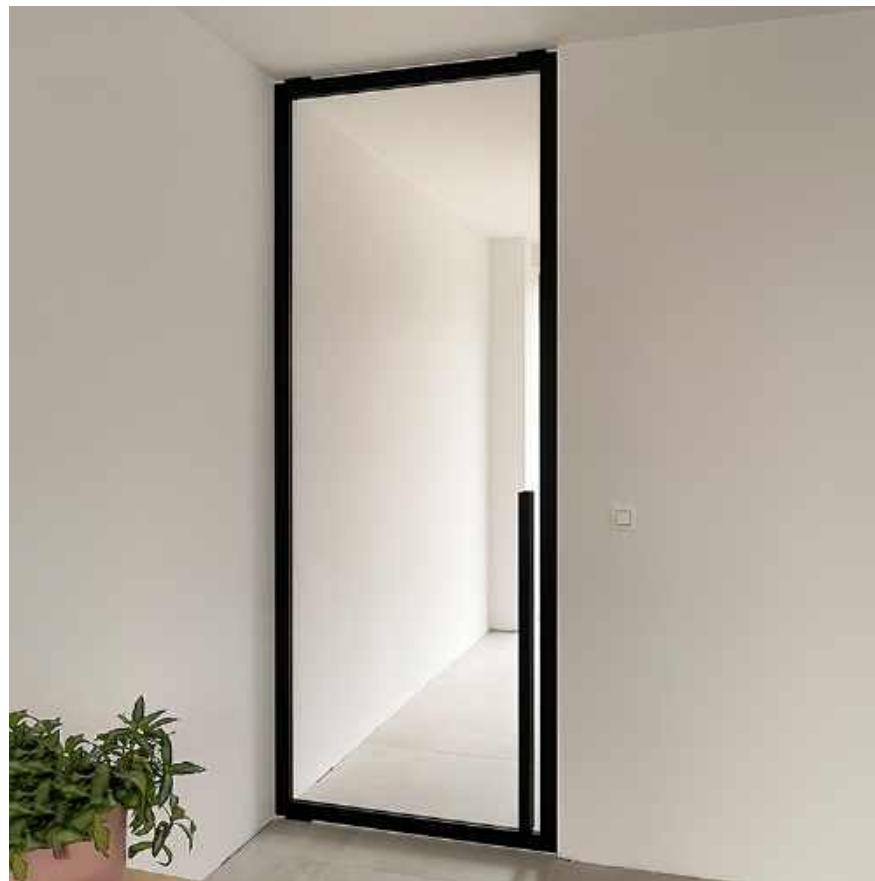

LIVINGHOUSE.CO.UK

TEL: 01722 415000

EMAIL: SALES@LIVINGHOUSE.CO.UK

---

## NL SET

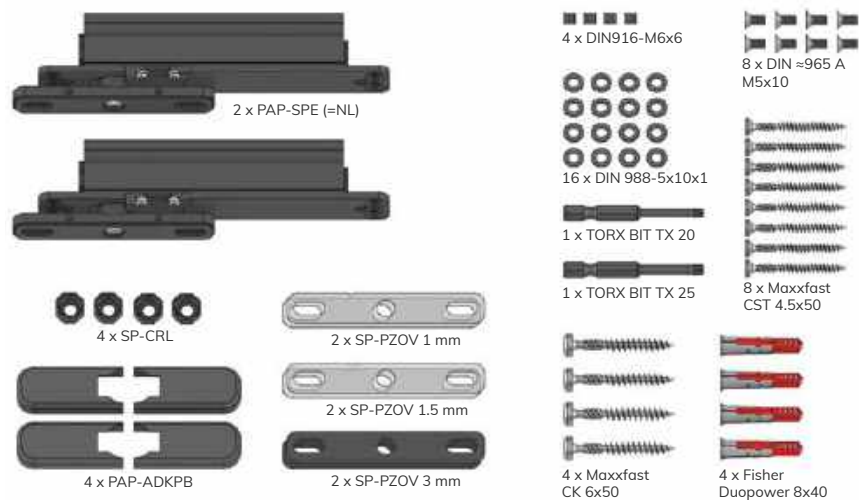

## XL SET

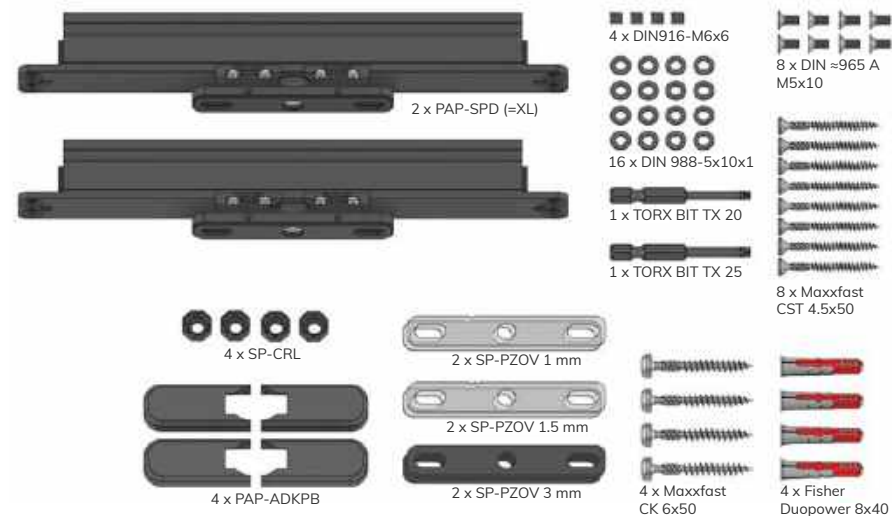

## OPTIONAL NL ACCESSORY SET

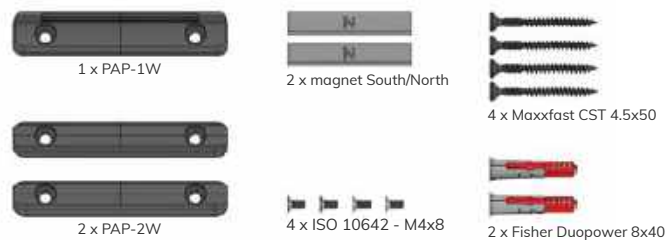

## OPTIONAL XL ACCESSORY SET

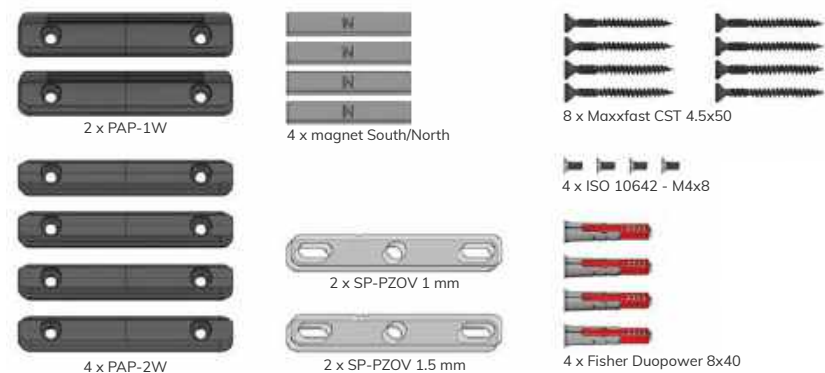

## OPTIONAL INSTALLATION TOOL

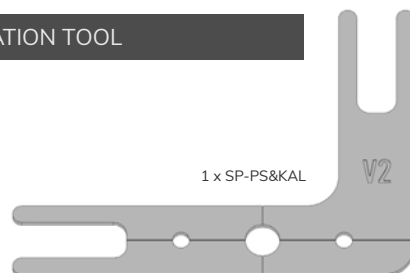

# PARTS

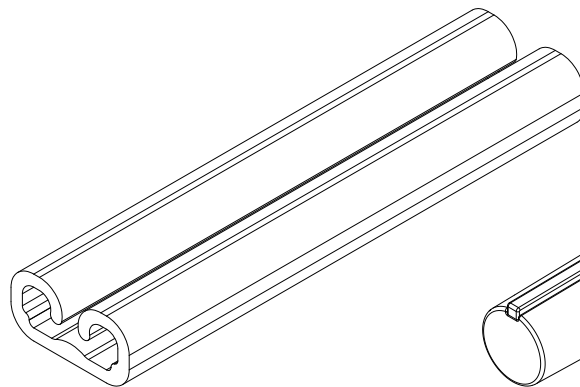

PAP-GLBR6-8

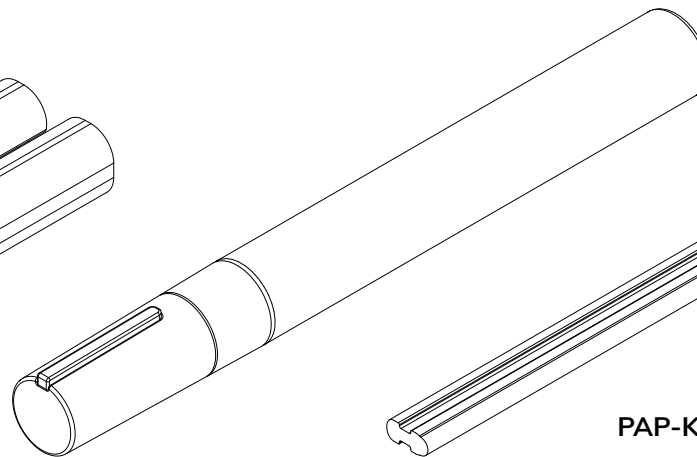

SAW CUT MARKER

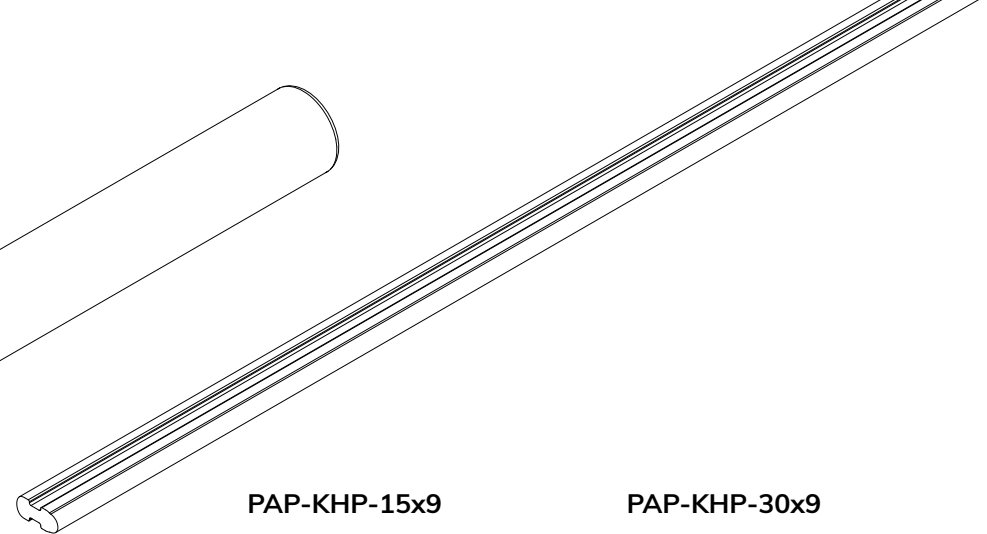

GLR68

PAP-KHP-15x9

PAP-KHP-30x9

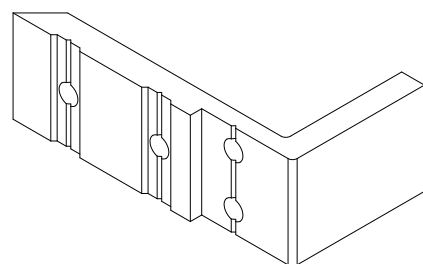
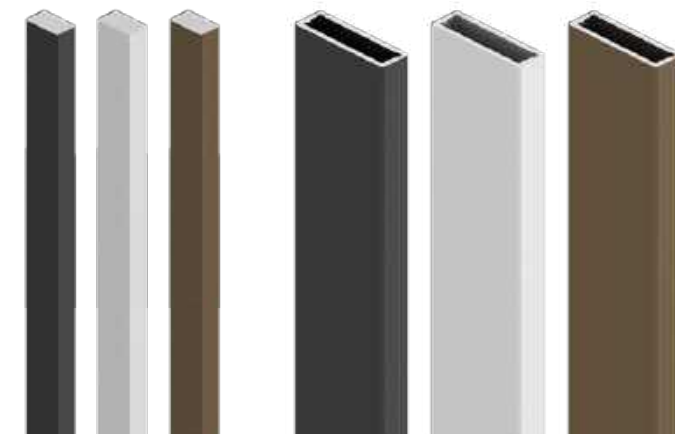

PAP-APV6040/20,25C

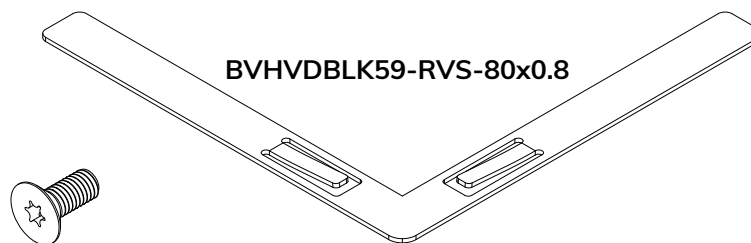

BVHVDBLK59-RVS-80x0.8



ISO10642-M5x12

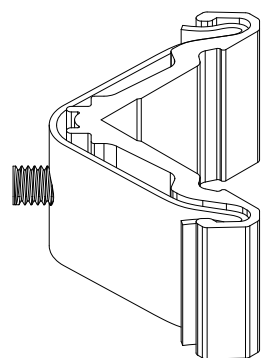

PAP-MCDBLK25x11x24,5

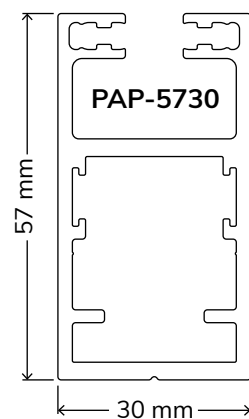

PAP-5730



BLACK

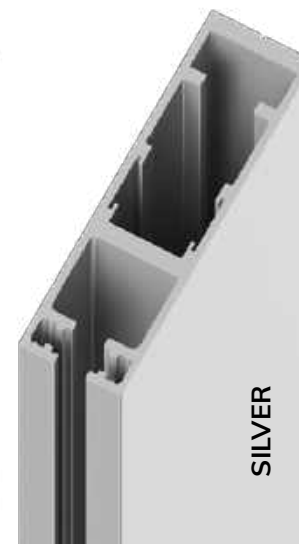

SILVER



BRONZE

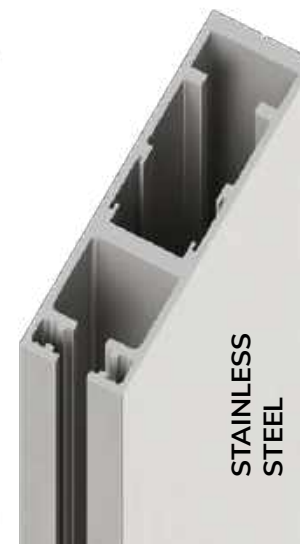

STAINLESS  
STEEL

## EXAMPLE KIT OVERVIEW

The aluminium profiles are delivered in a firm cardboard tube which protects the profiles during transport and remains stackable. All assembly accessories, pivot hinges and door grips are delivered in a separate cardboard box.



Made-to-measure  
& fully prepared profiles

Hardware  
& accessories

set  
+ optional accessory set  
+ optional installation tools

## LOCALLY SOURCED MATERIALS

- ▶ Glass\* (6 or 8 mm tempered glass)
- ▶ Silicone spray
- ▶ Isopropyl alcohol (cleaning alcohol)
- ▶ Acetone

\* Recommended 8 mm thick tempered glass for weight advantages during manipulation and installation on site

## RECOMMENDED TOOLS



Rubber hammer



Bit screwdriver



QuickGrip

## COLOR SAW CUTS

Degrease\* the saw cuts and use the supplied marker to paint the cuts.

\*Isopropyl alcohol

Remove excessive paint from  
visual sides with acetone or alike

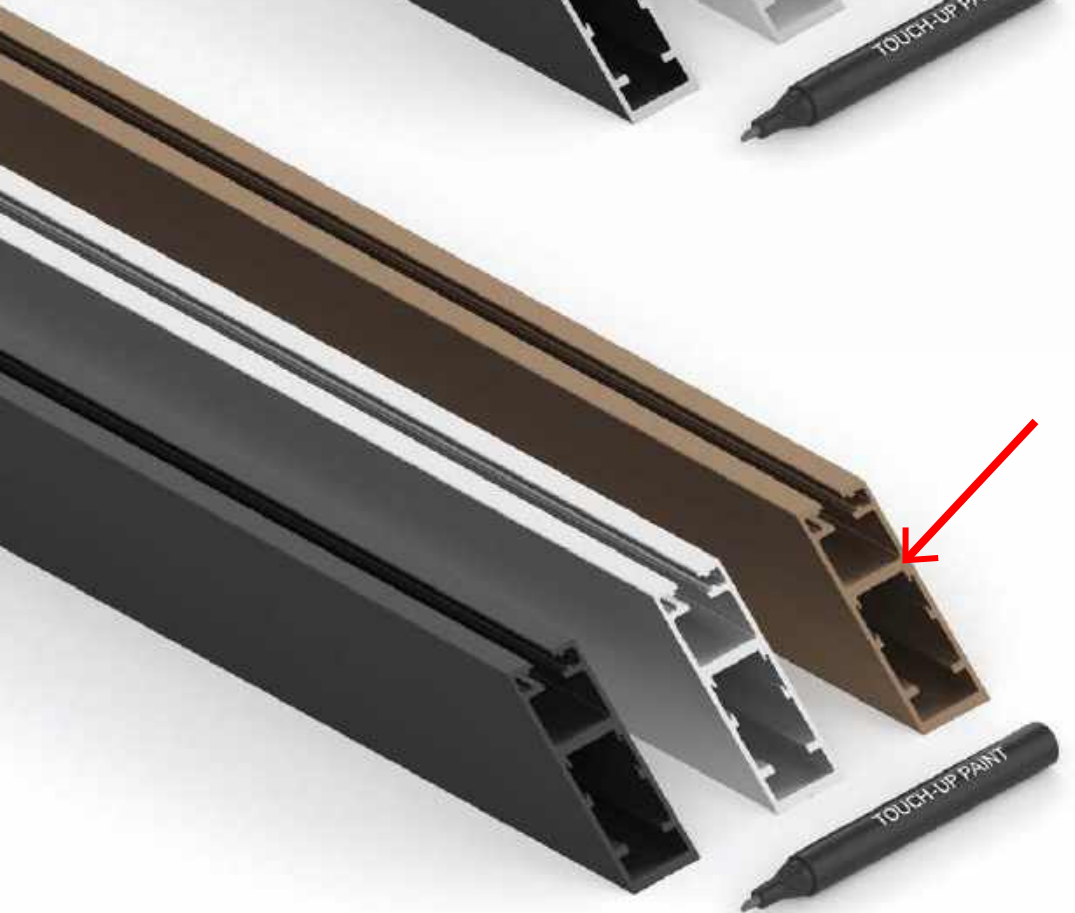
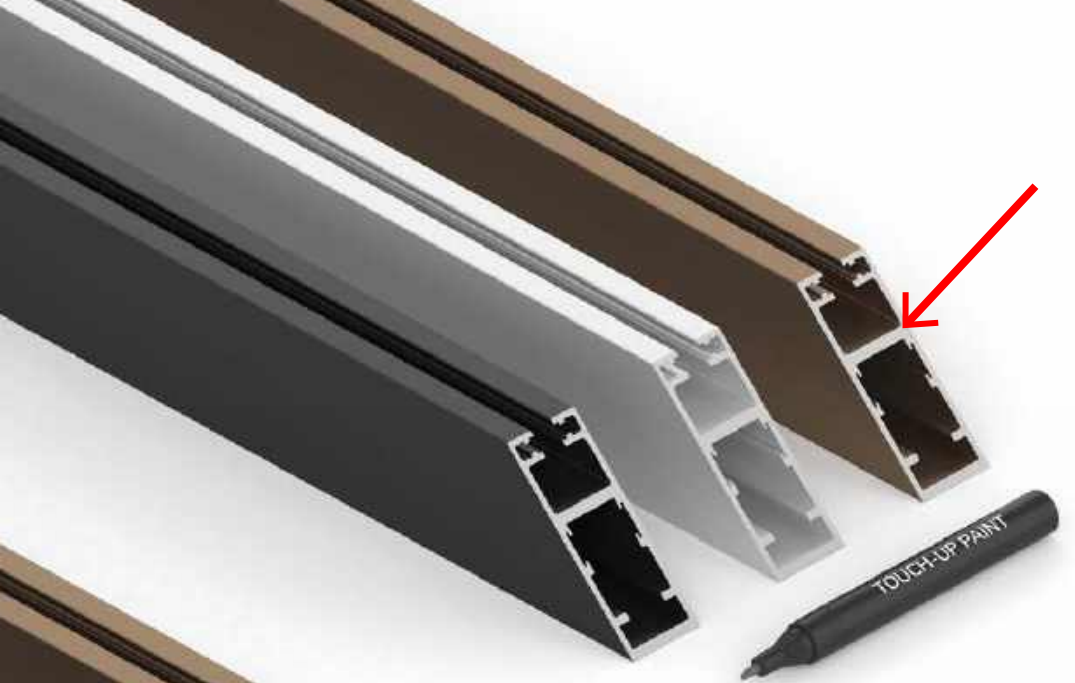

# INSERT EPDM INSERTS

Slide in 5 EPDM inserts (GLBR6-8) into every profile, and distribute them evenly.

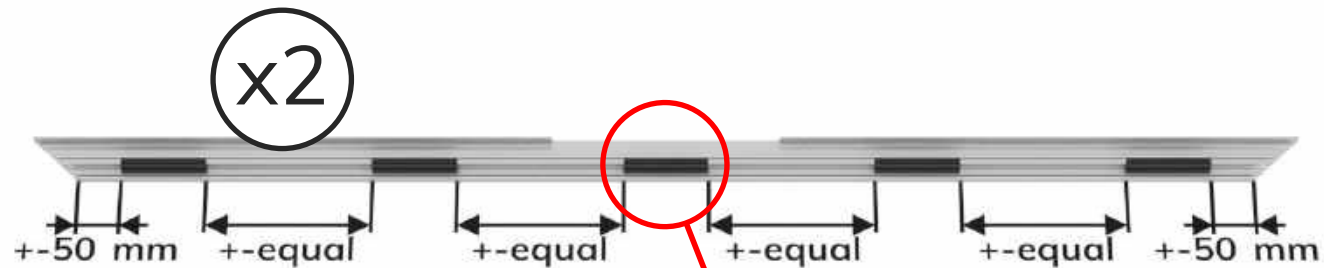
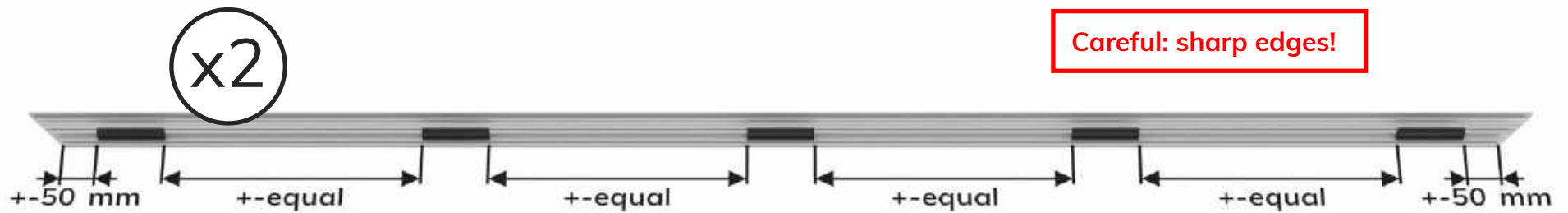

Always position 1 insert above pivot axis

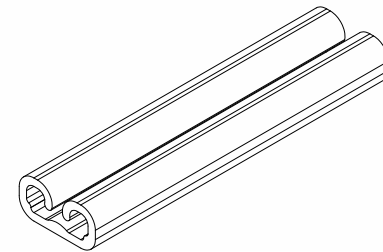

PAP-GLBR6-8

NL and XL share identical installation steps

## INSERT RUBBER EXTRUSIONS

The GLR68 rubber can be used for 8 mm glass because of its excentric profile shape. See visual for correct mounting positions. →

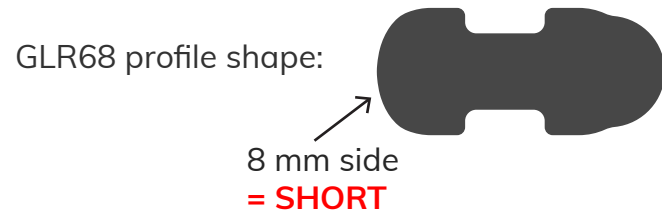

- 1 Cut off a strip from the start of the GLR68.  
- For 8 mm glass, cut off the **LONG** side.

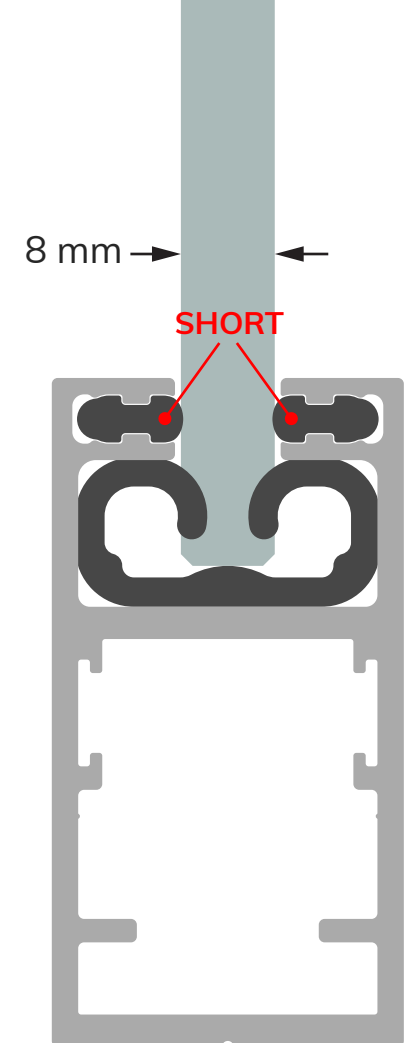
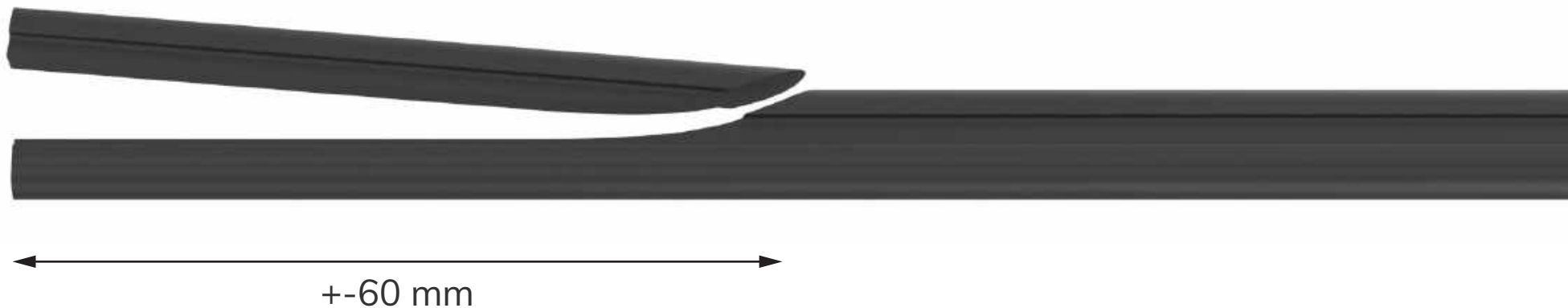

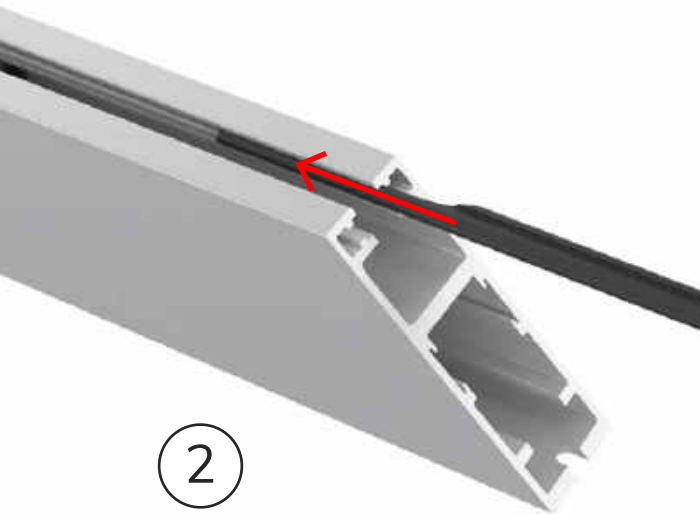

2

Guide the GLR68 through the canal, with the thin side towards the center of the profile.

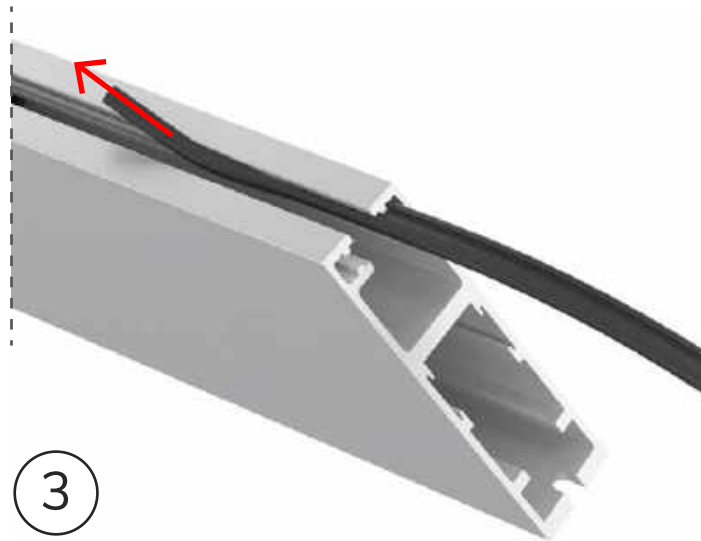

3

Pull the thin side out, and use this to pull the GLR68 through the aluminium profile.

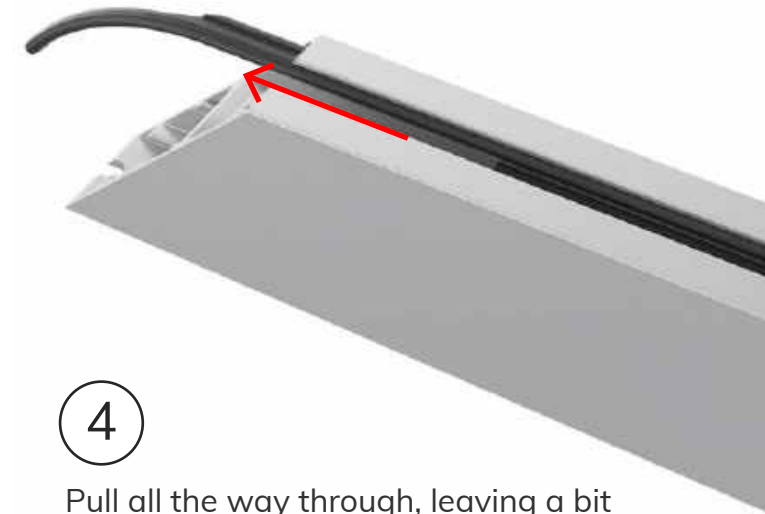

4

Pull all the way through, leaving a bit extra hanging out.

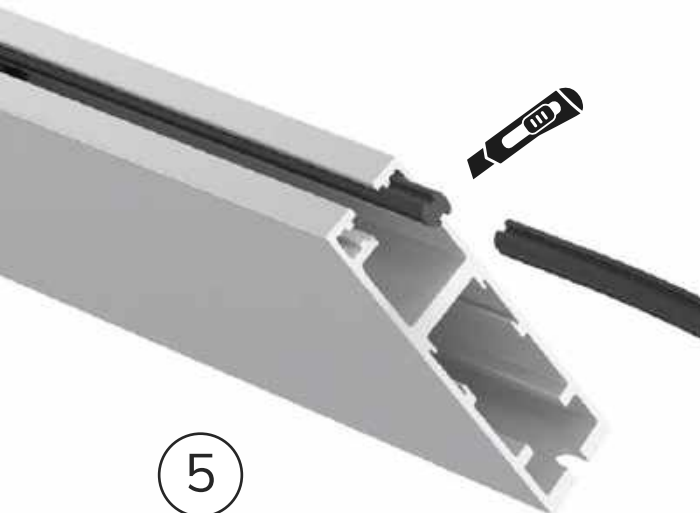

5

Cut this end at a 45° angle.

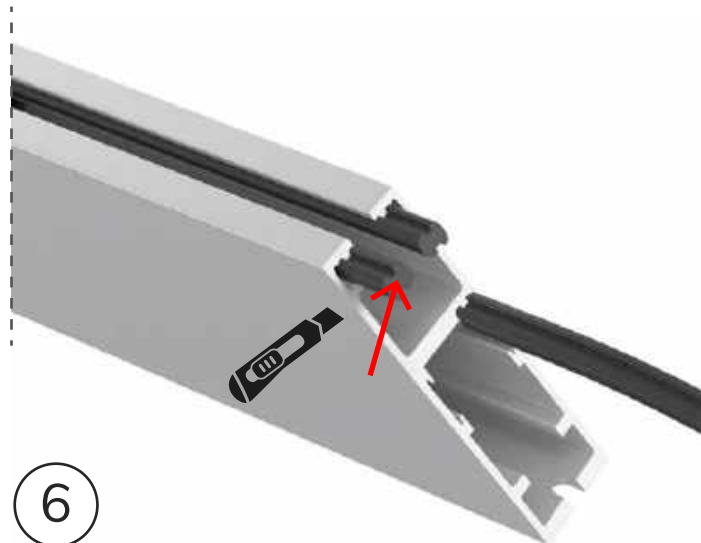

6

Repeat steps 1-5 for the second GLR68

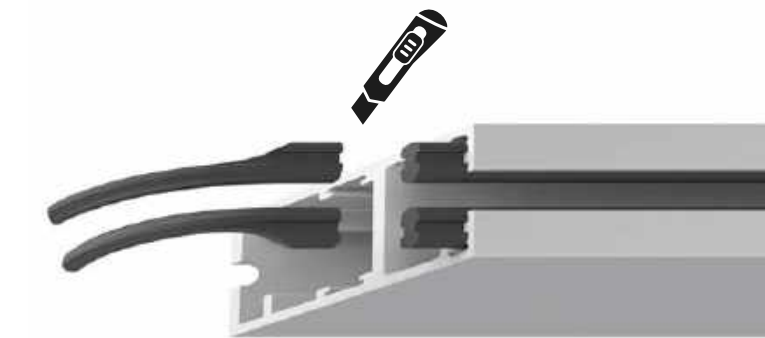

7

Cut off both remaining ends at the other side.

Apply steps 1-7 to each profile

## PREPARE TOP AND BOTTOM PROFILES

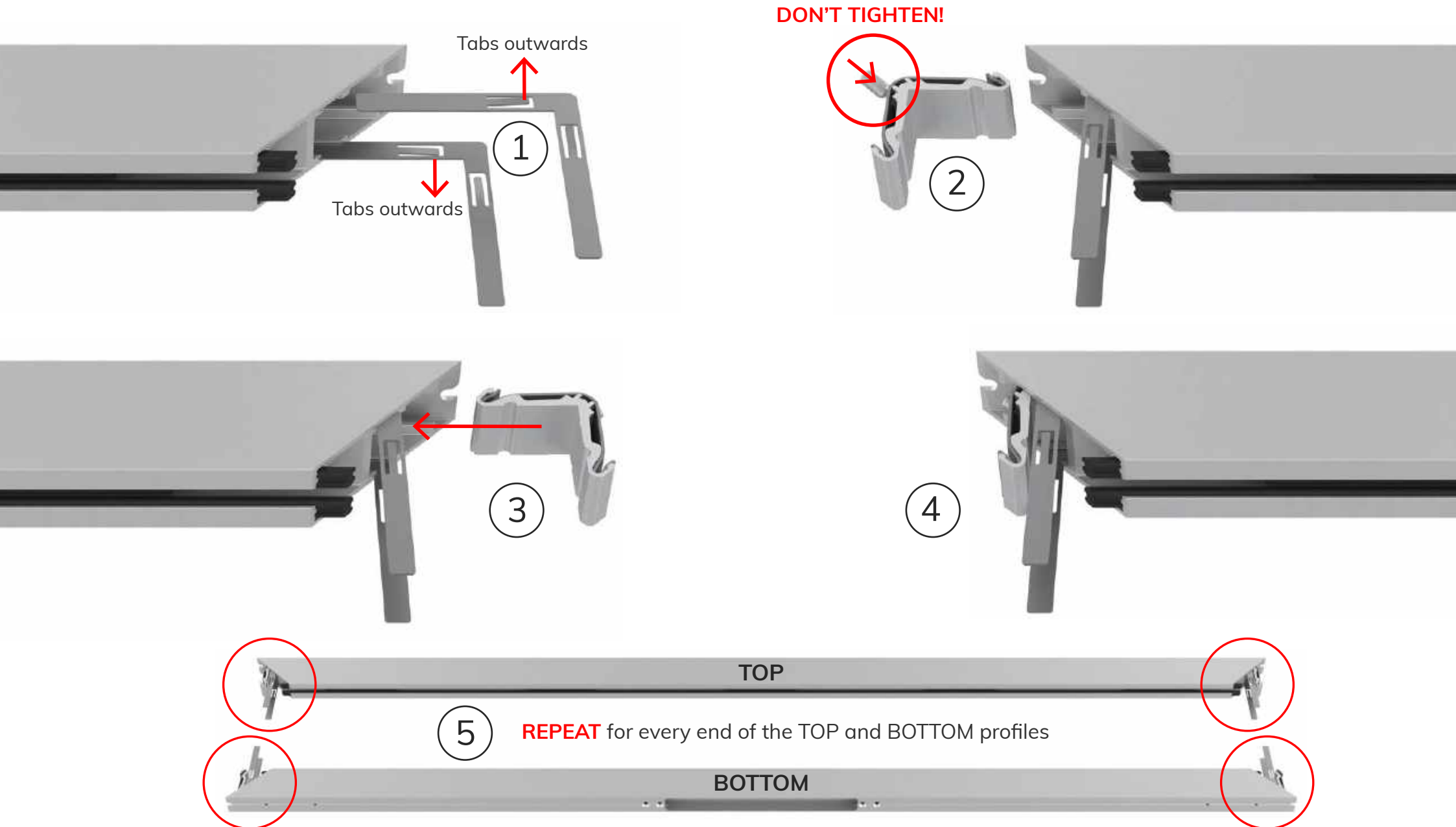

## PLACE GLASS PANEL

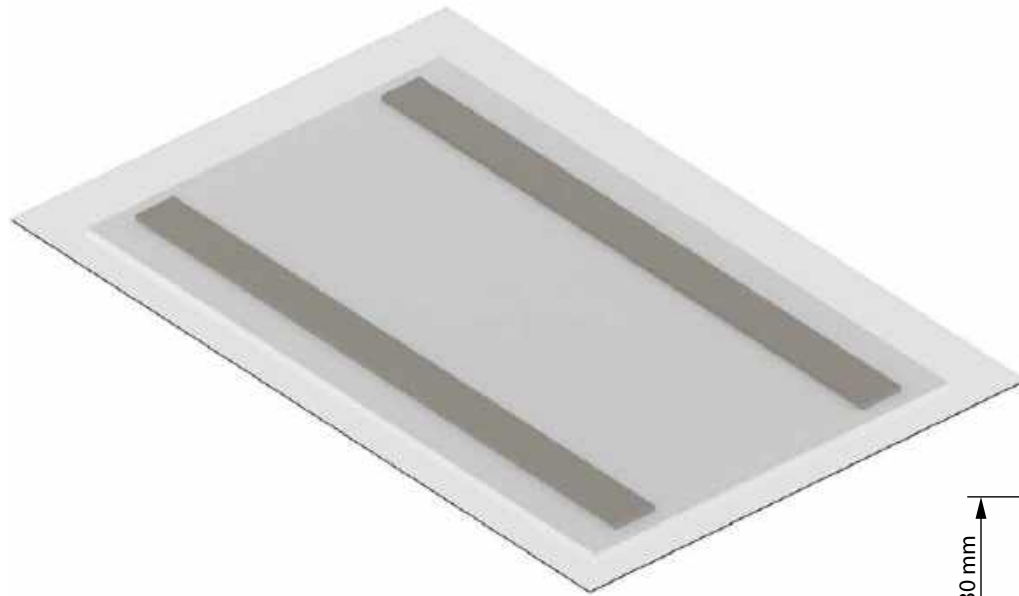

Use 2 wooden spacers (+- 15 mm thick) on an assembly table and place the locally purchased panel on top.

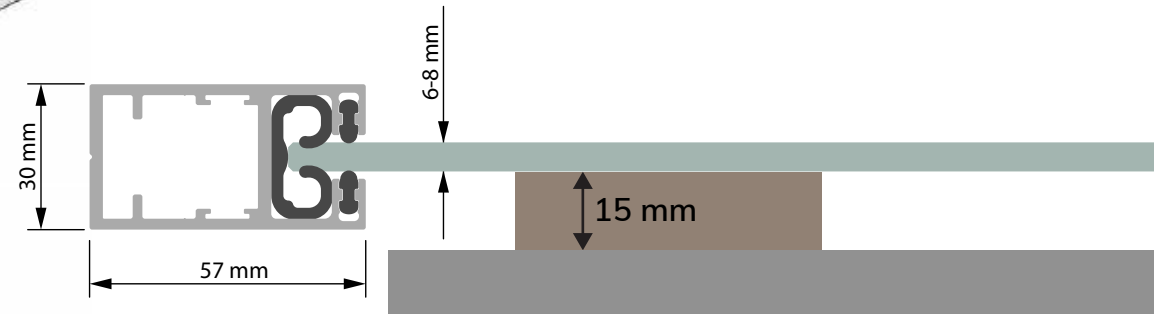

TOP

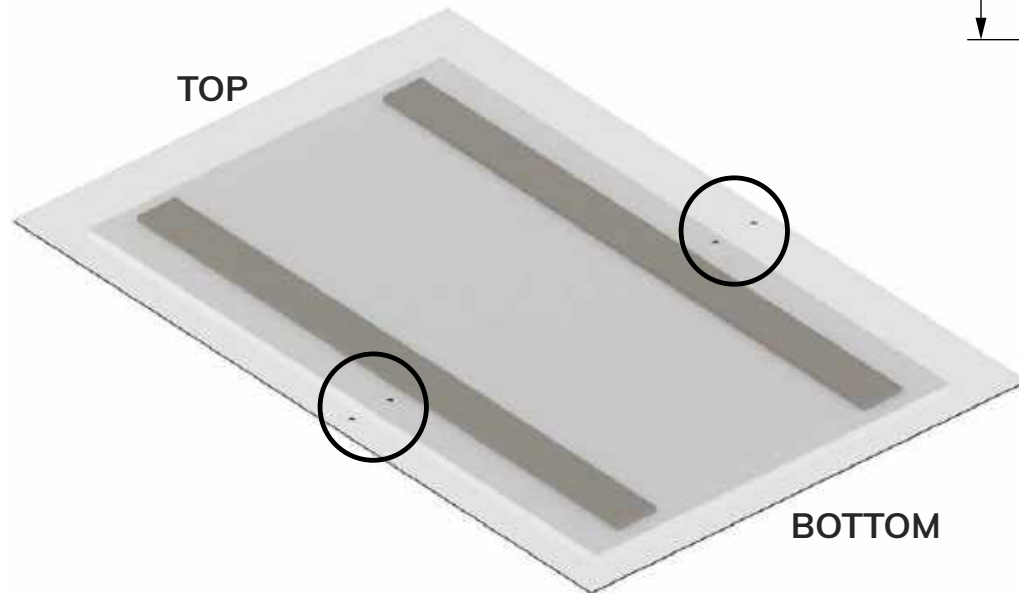

BOTTOM

If your panel has pre-drilled holes, check that it has a top/bottom and left/right side!

## MOUNT PROFILES ON GLASS

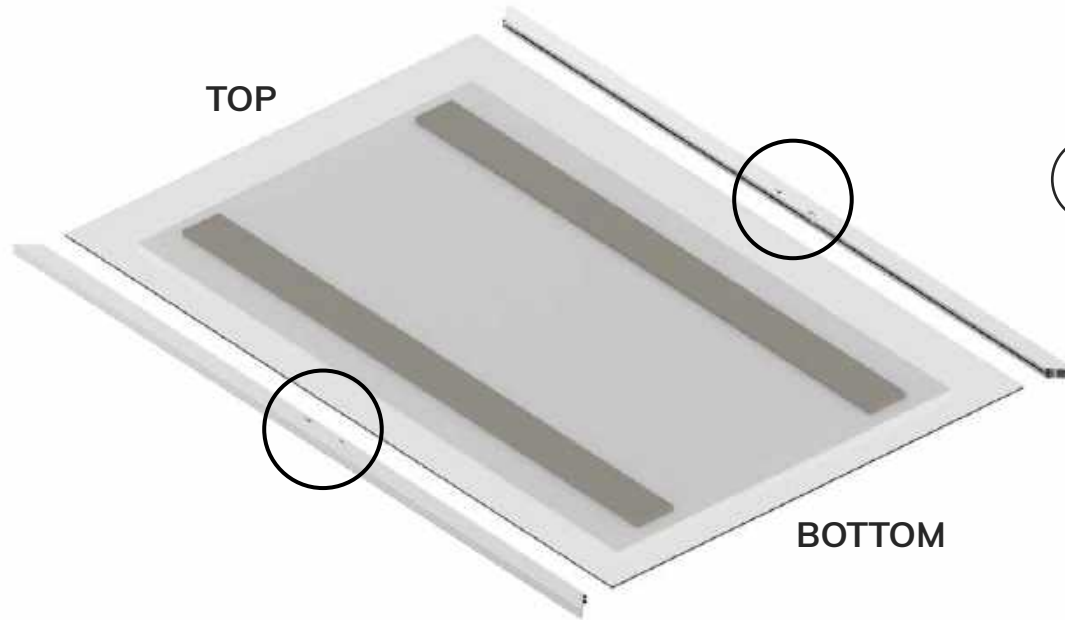

- 1 If there are holes for doorgrrips in the profiles, their top/bottom orientation is important!

**Careful: don't drop profiles!**

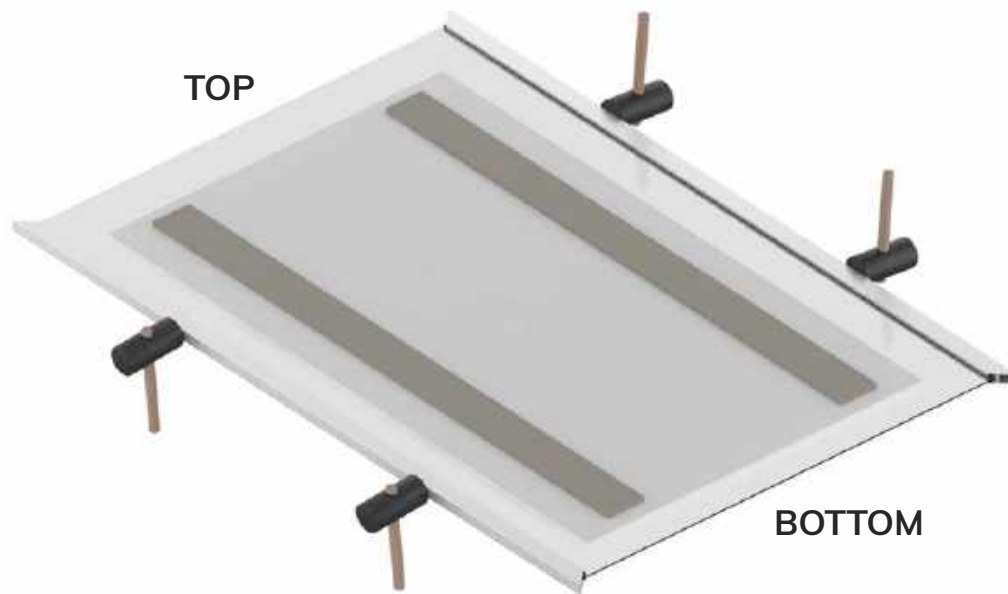

- 2 Push the left and right profiles with their EPDM inserts and GLR68 over the panel, matching the center of the profiles with the center of the glass.

Use a rubber hammer to facilitate positioning.

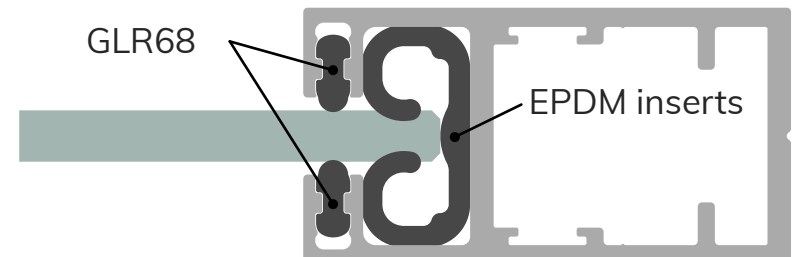

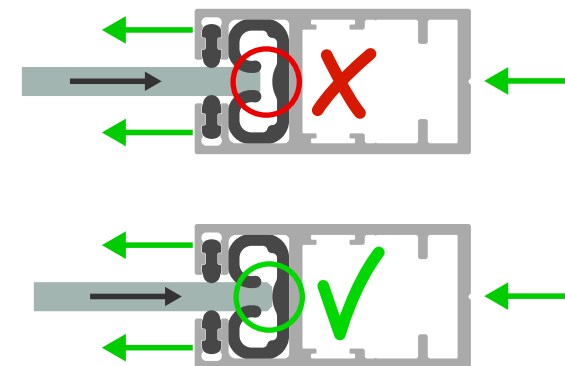
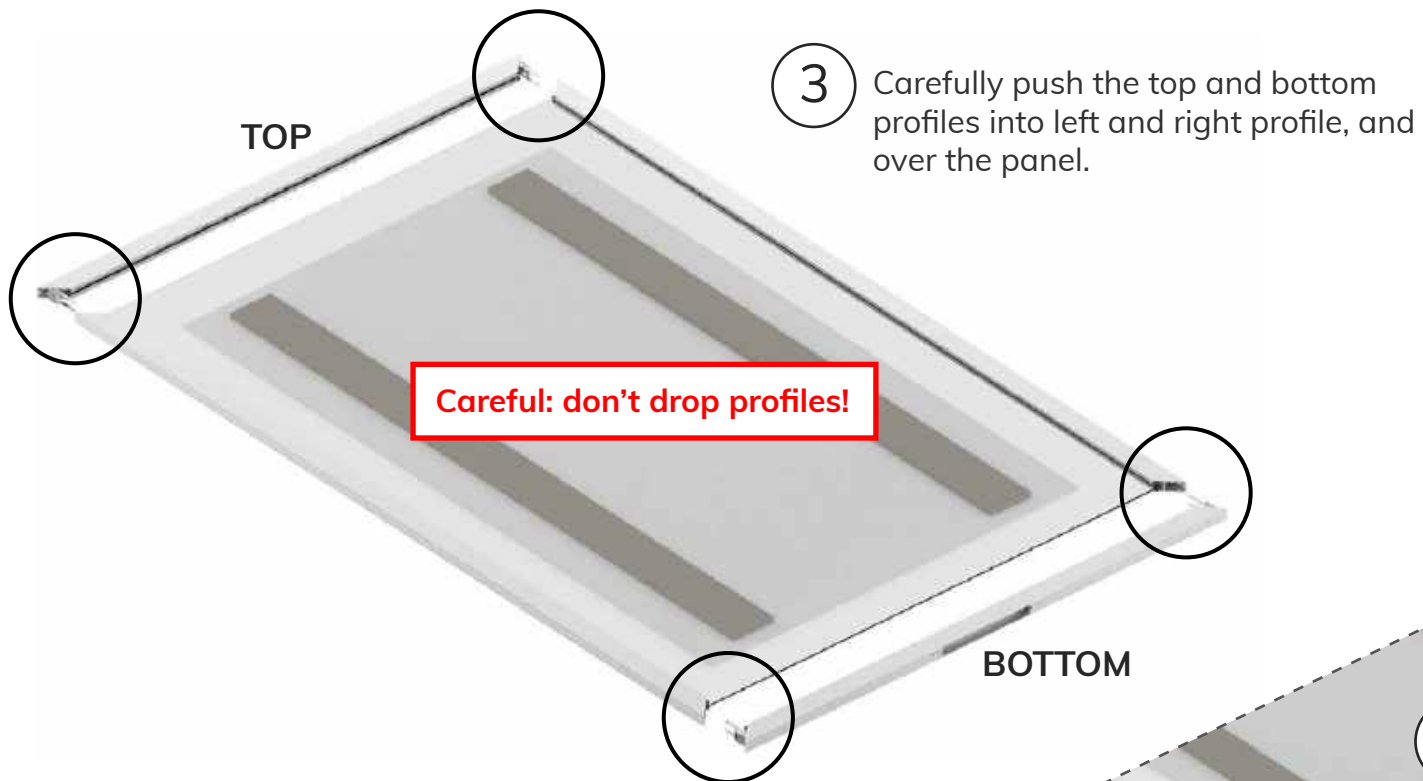

- 4 Push in the excess GLR68 into the profiles during mounting.

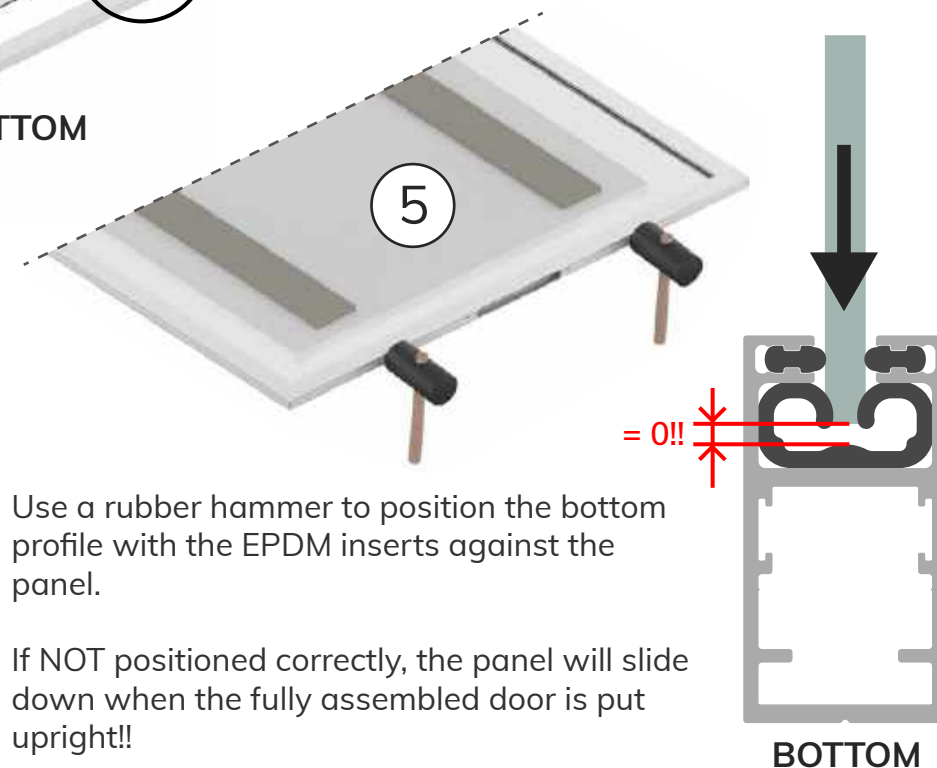
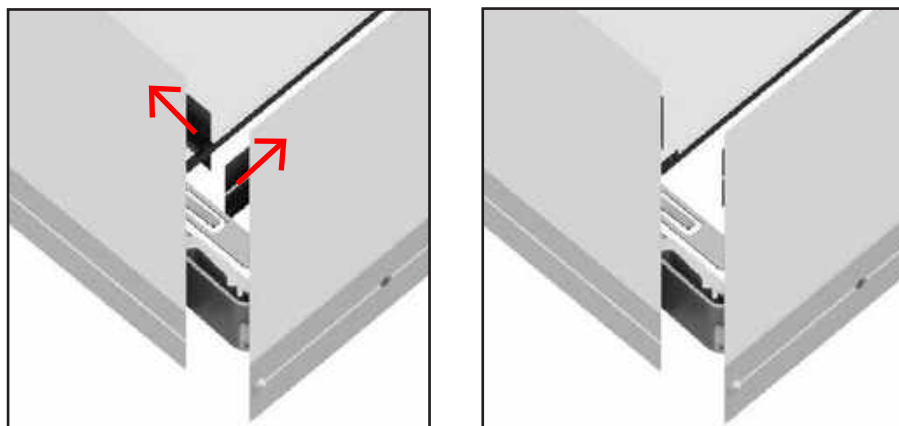

## SECURE CORNER JOINTS

Align the profiles as best as possible, and carefully tighten the inbus screw **BY HAND! Over-tightening will damage the corner joint!**

During tightening, the space between the profiles will disappear.

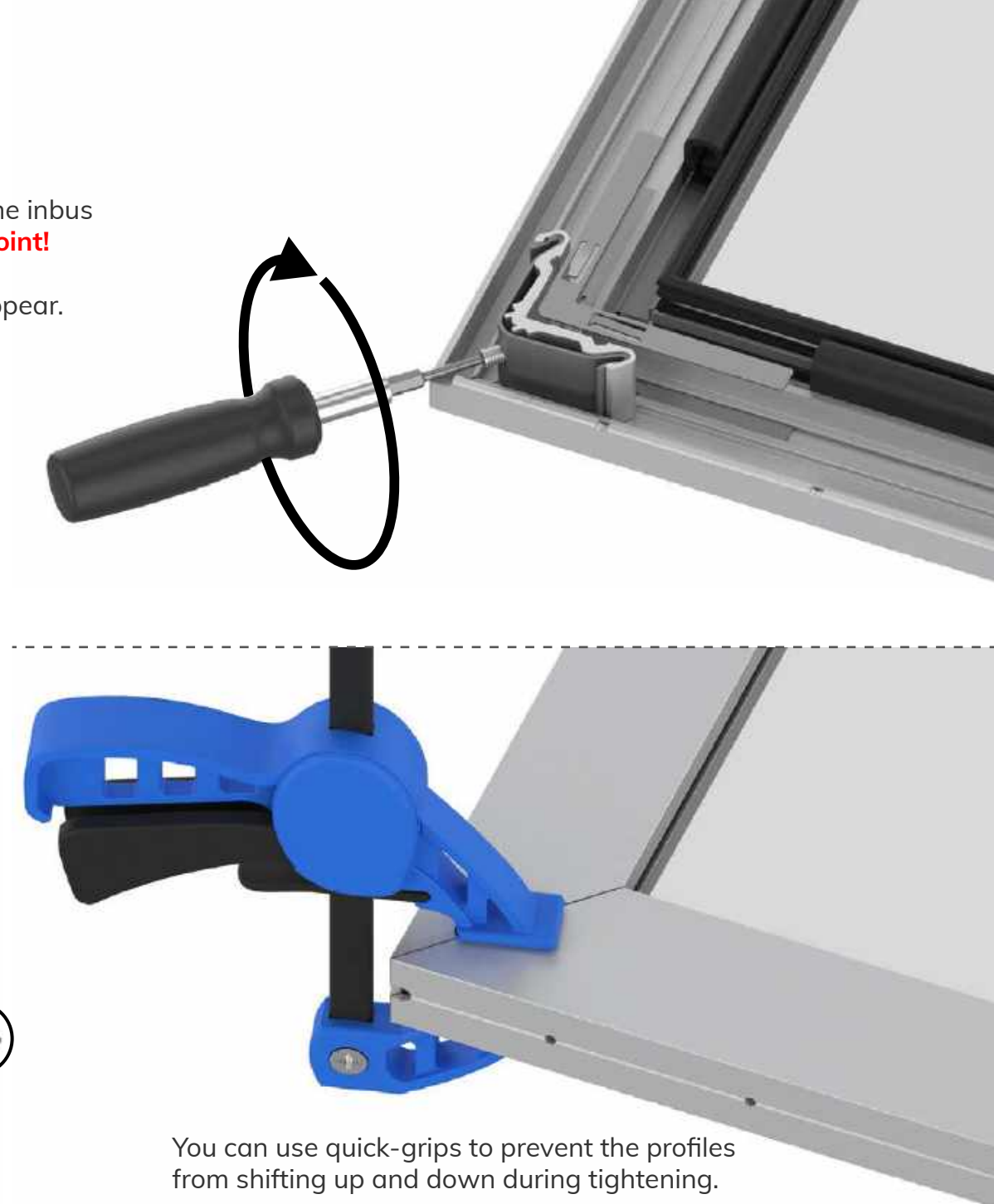
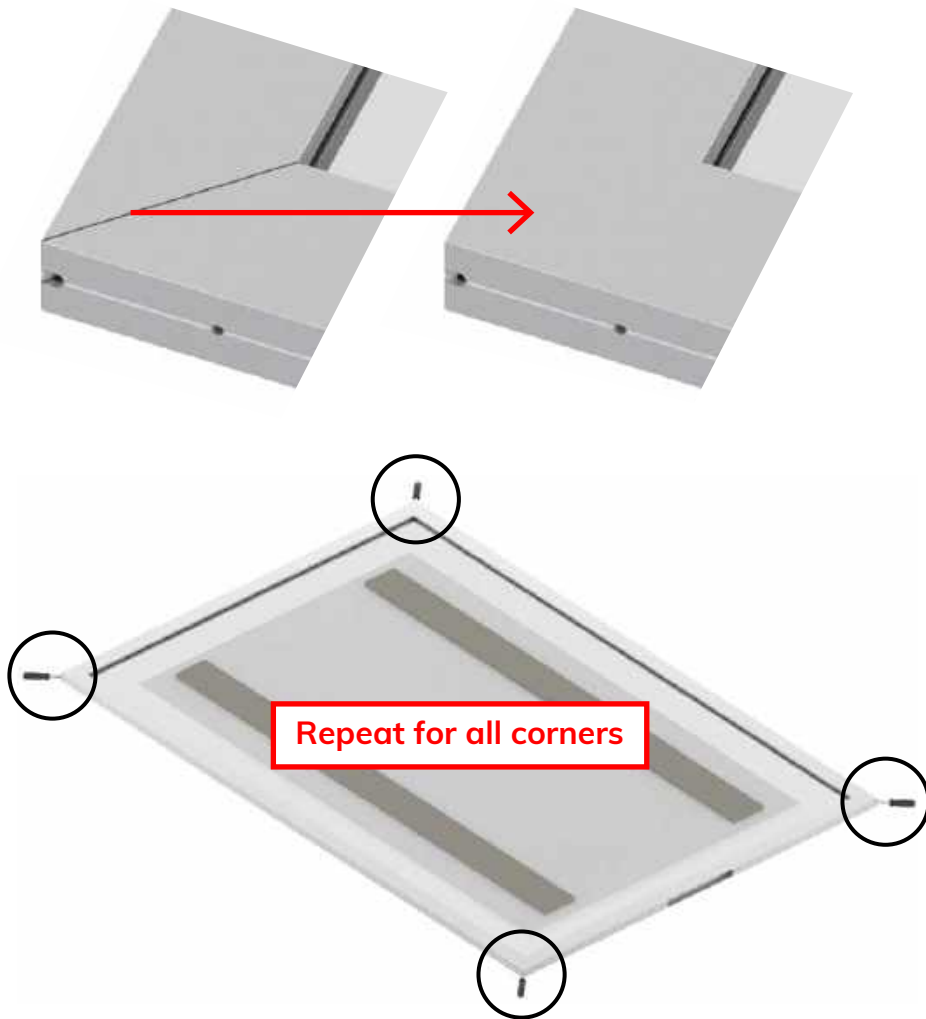

You can use quick-grips to prevent the profiles from shifting up and down during tightening.

## INSERT HINGE BRACKETS

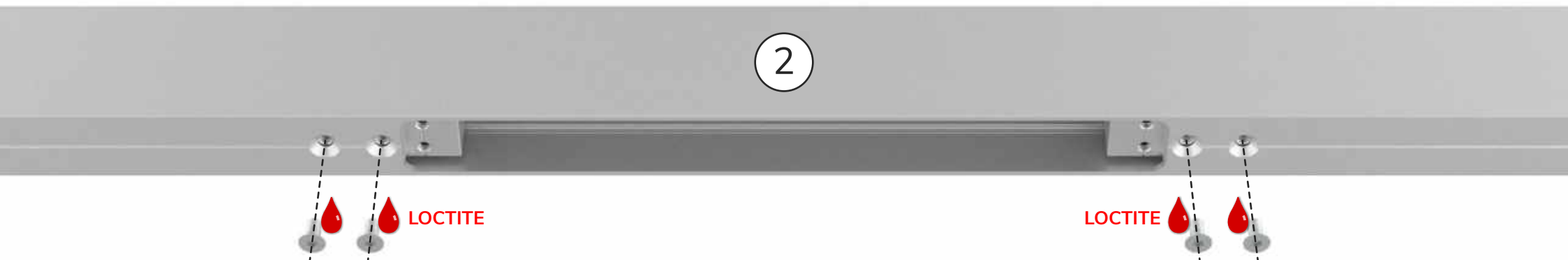
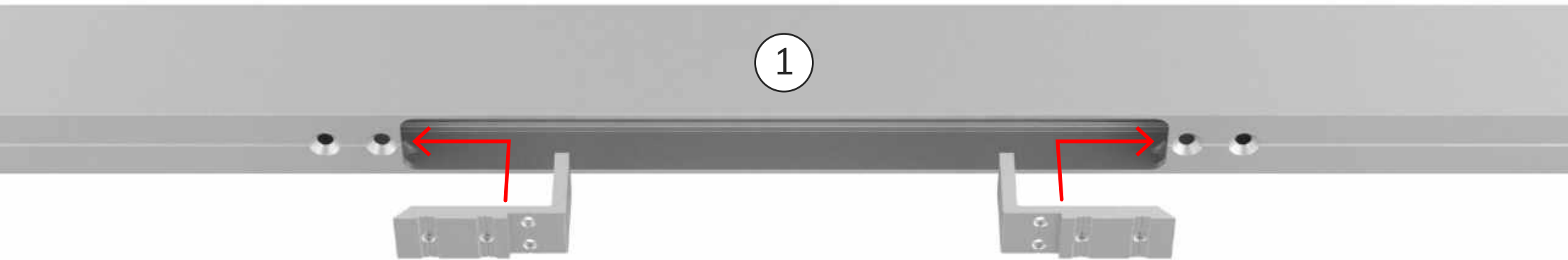

DON'T TIGHTEN FULLY YET!

DON'T TIGHTEN FULLY YET!

## MOUNT HINGE

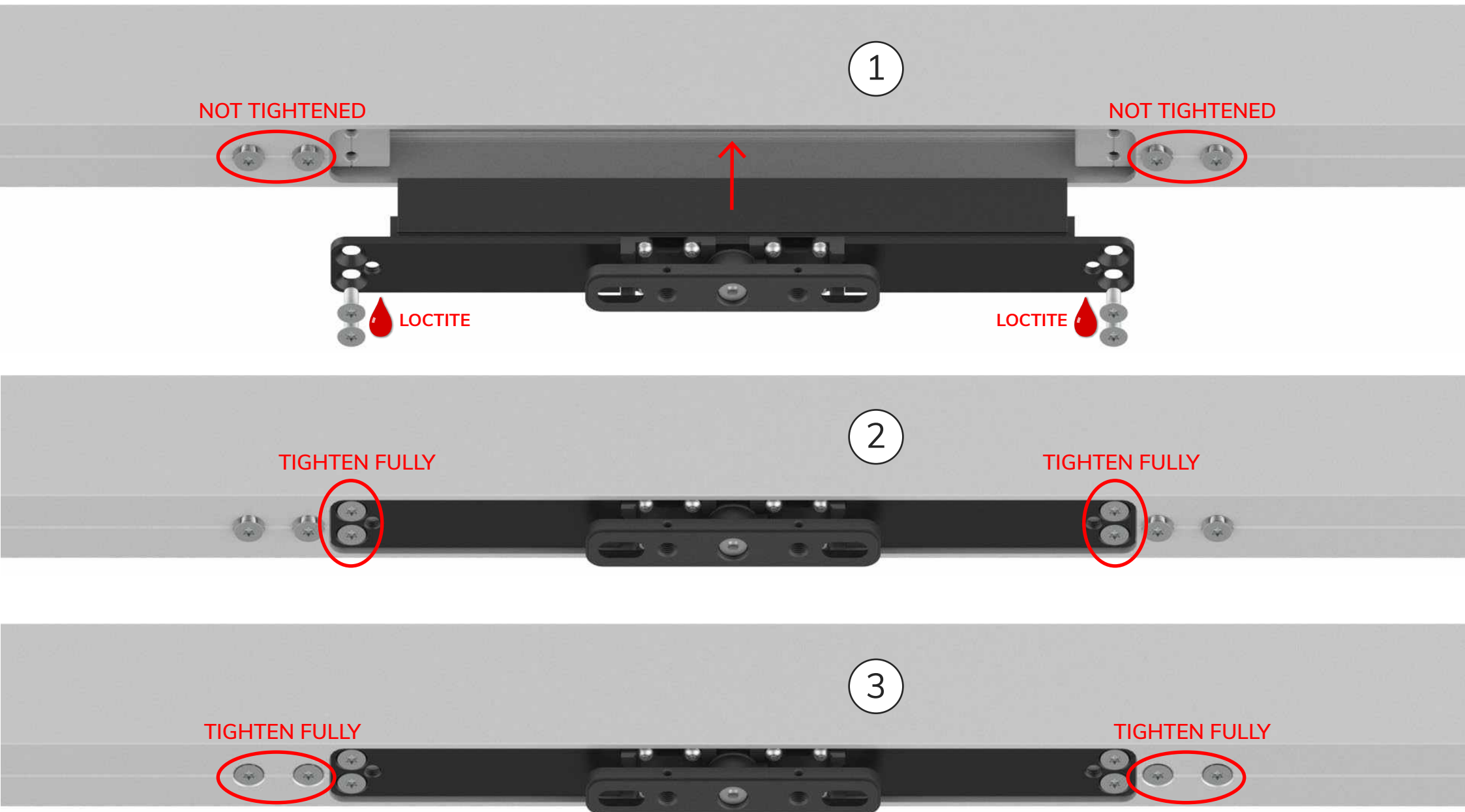

## SYNCHRONIZE PIVOT AXIS HEIGHT IN DOORWAY

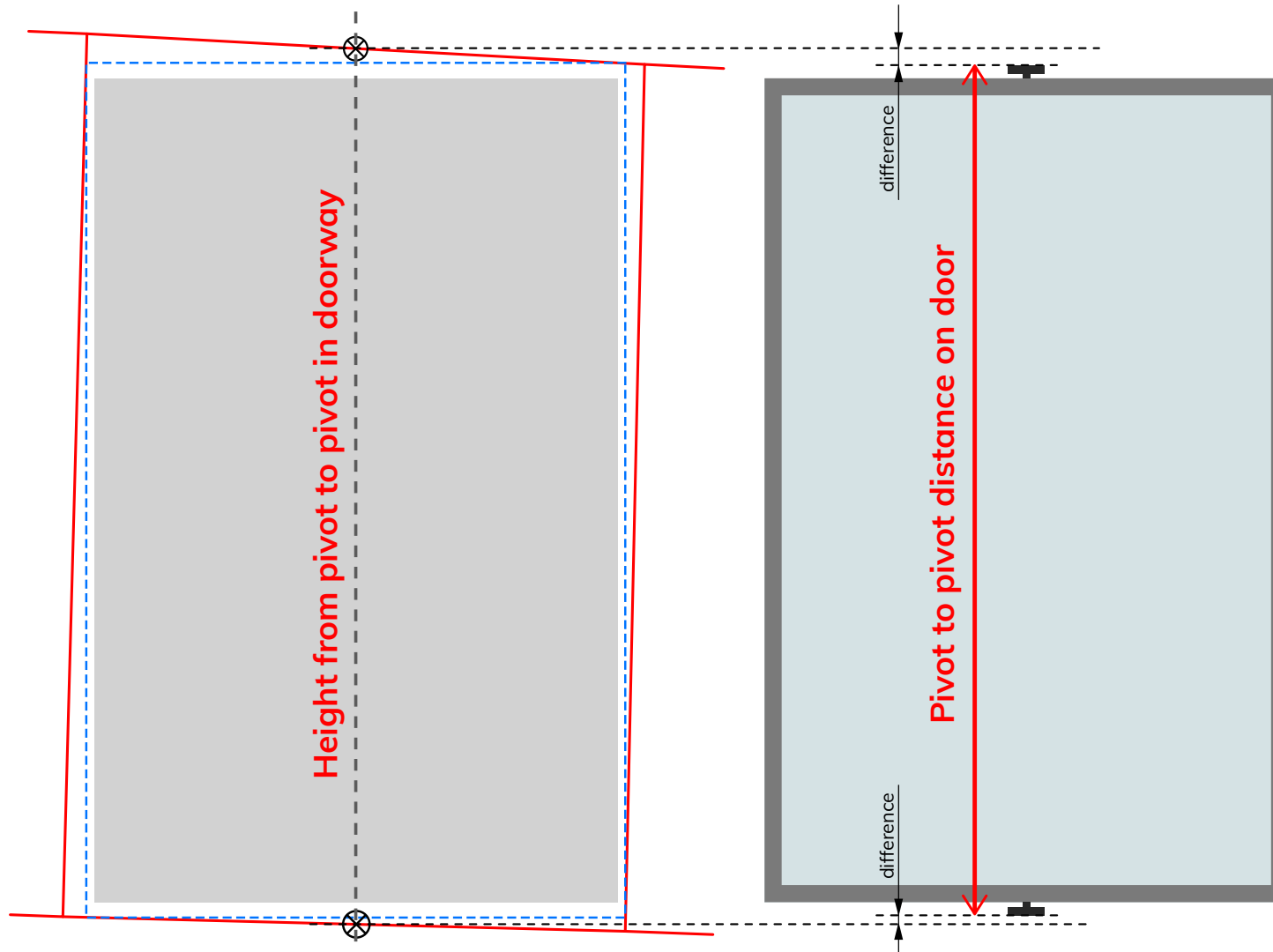

Compare the pivot to pivot distance of the door with the measured doorway height at the axis point.

**Synchronize them if necessary, using a method described on the next page.**

# ADJUST HINGE HEIGHT / JOINT DIMENSIONS

To increase the joint dimensions, there are 3 methods:



Use supplied shims between hinge and door leaf.  
**This is the preferred method for the bottom hinge.**

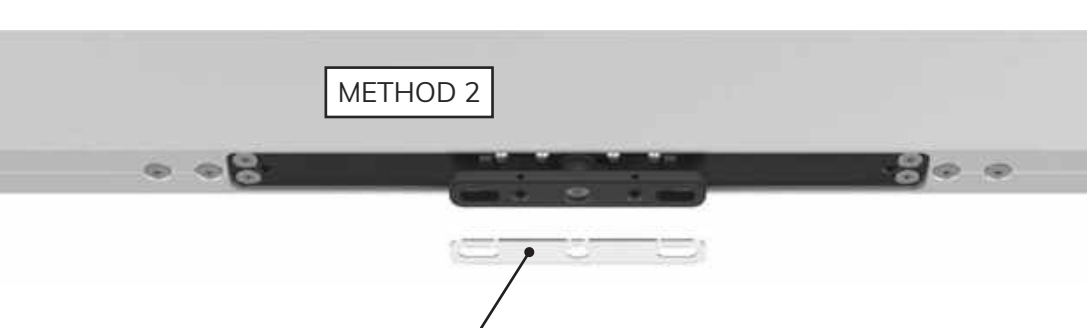

Use supplied shims between hinge and floor/ceiling

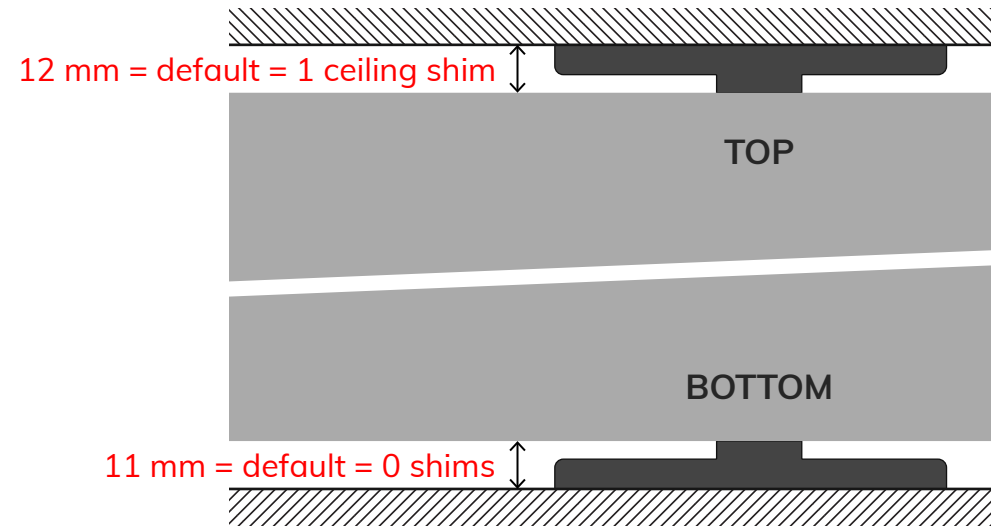

Adjust the inbus screws to move the hinge further away from the door leaf (loosen 4 hinge screws first).  
**Not recommended for bottom hinge**

## CHECK PIVOT TO PIVOT DISTANCE

Double check the pivot to pivot distance of the door with the measured doorway height at the axis point.

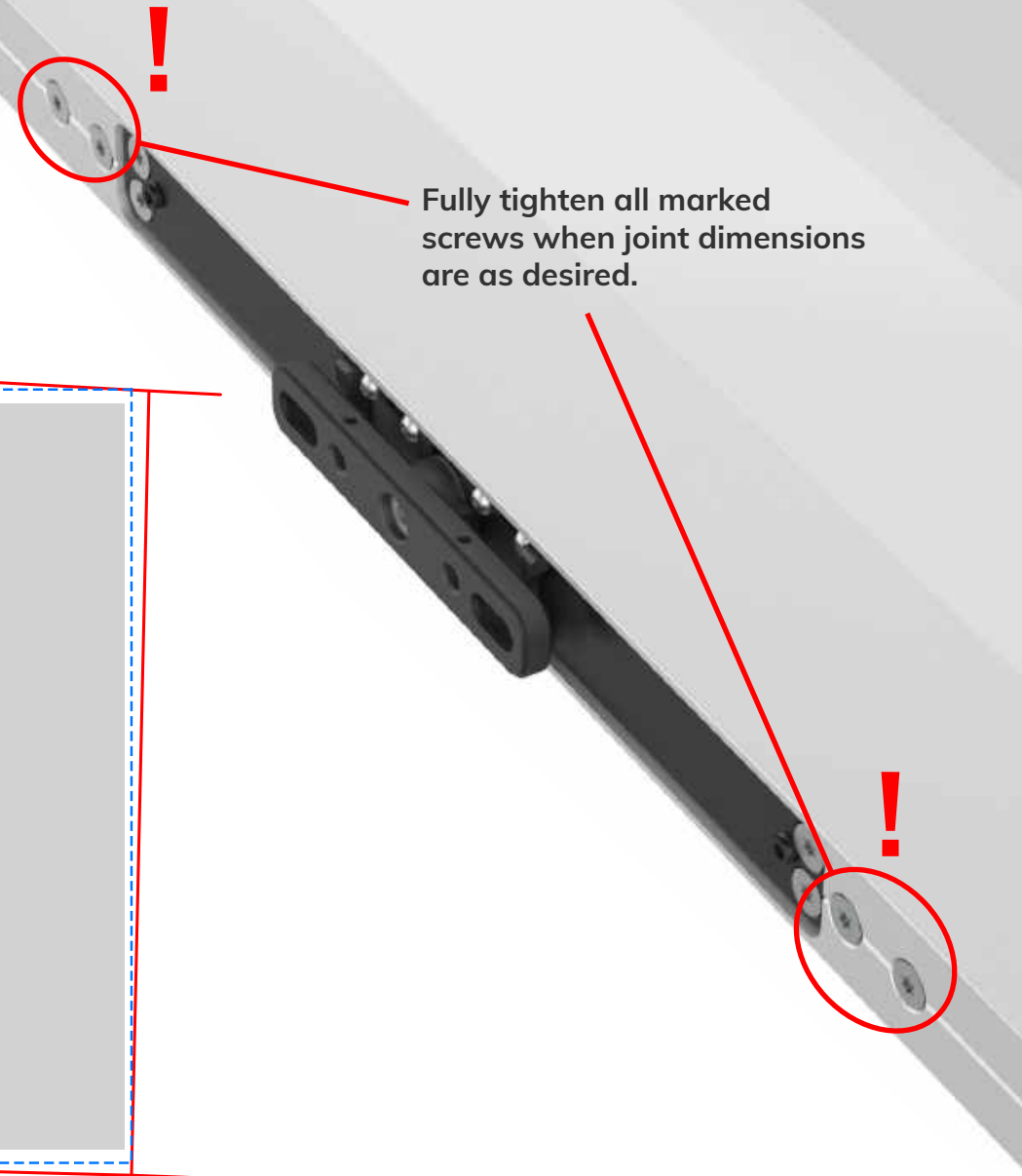
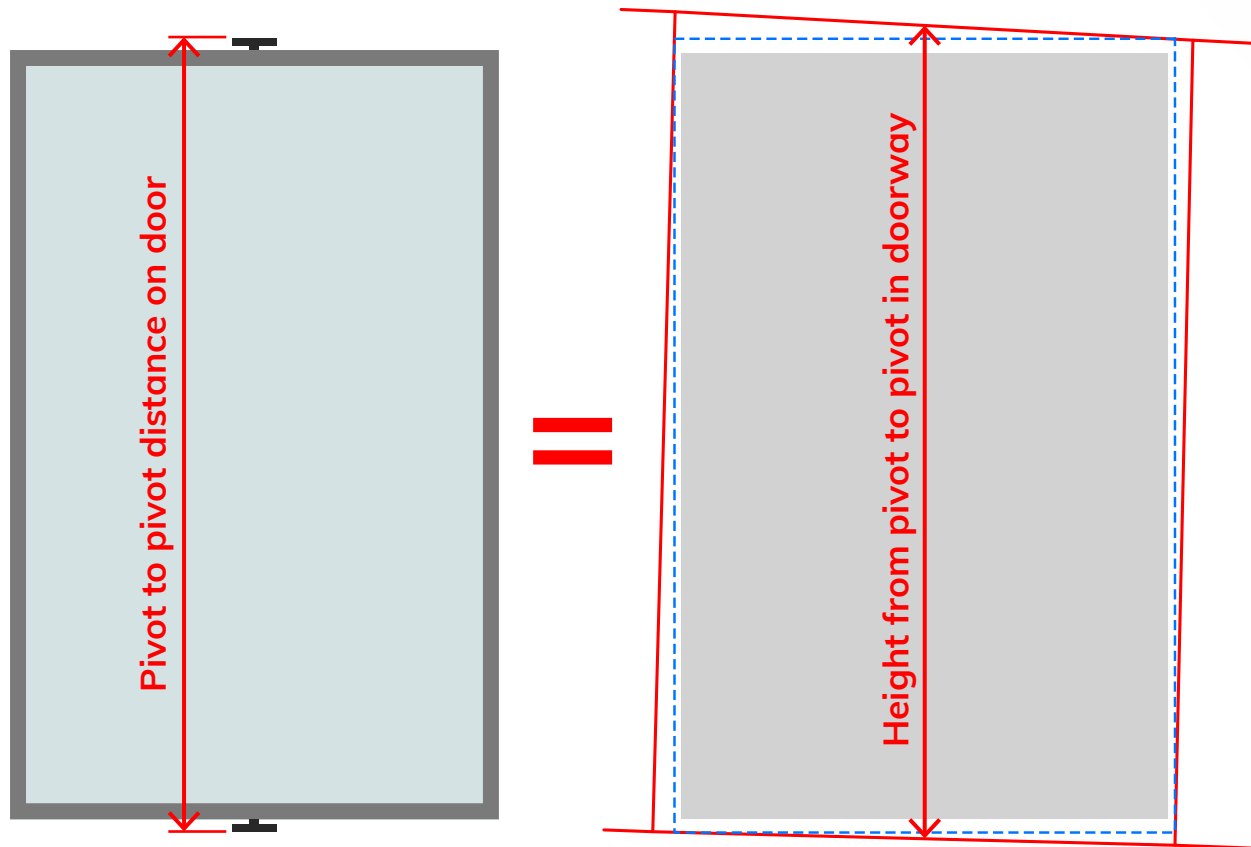

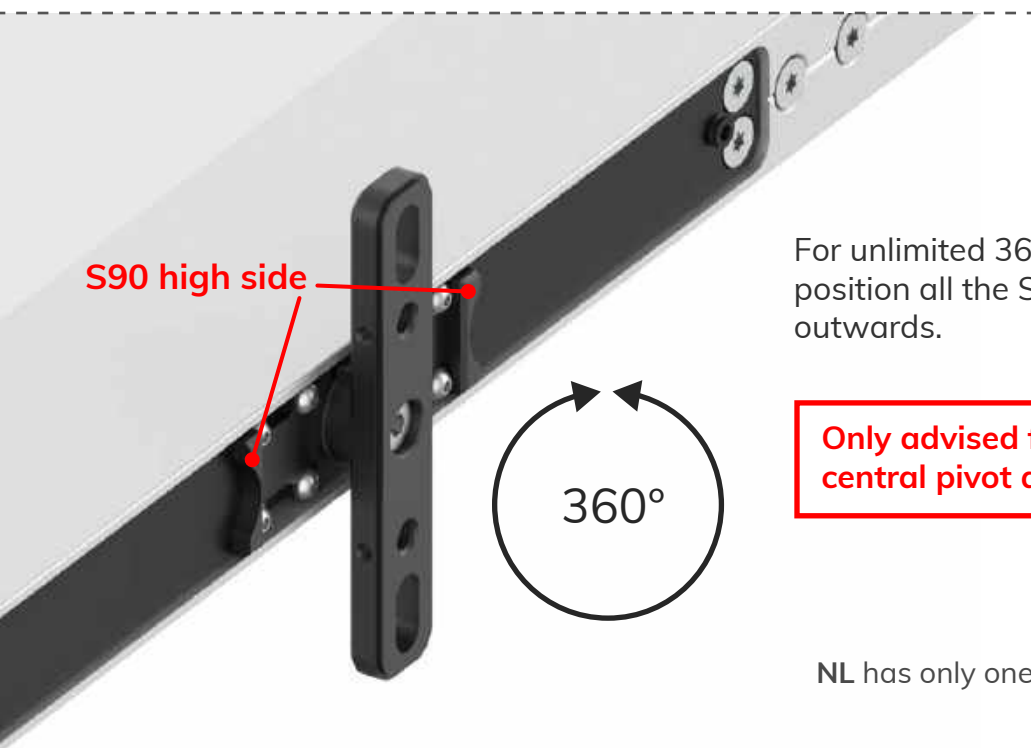
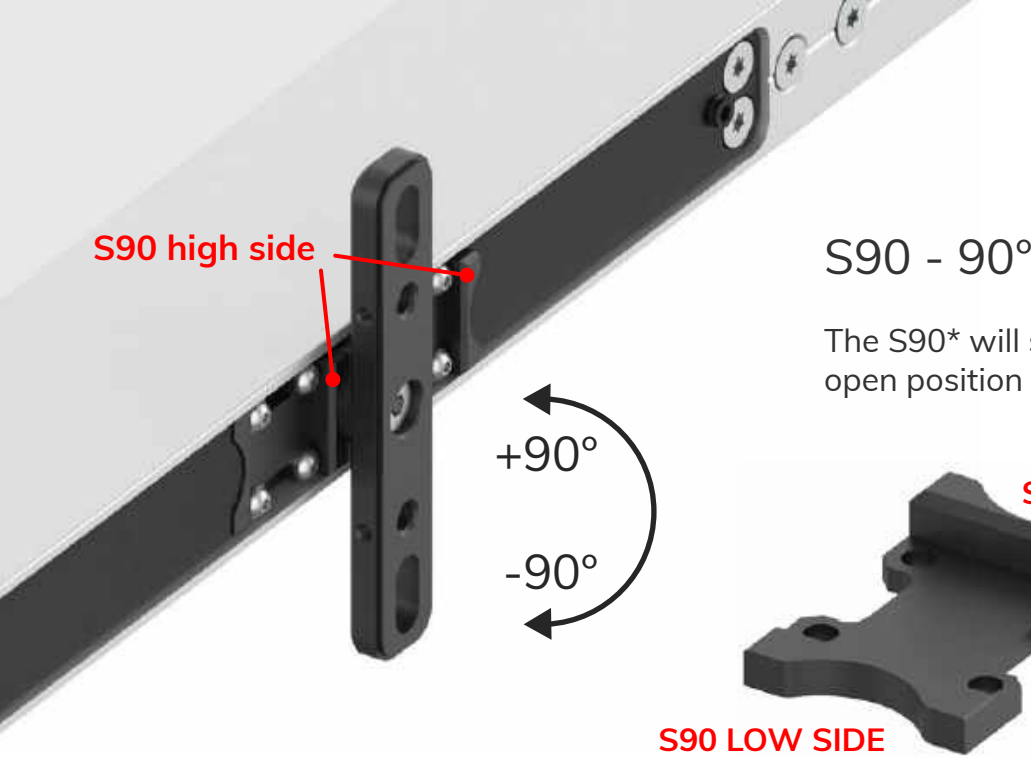

NL has only one S90 per hinge

**Make sure the S90\* high sides are positioned identical for top and bottom hinges!**

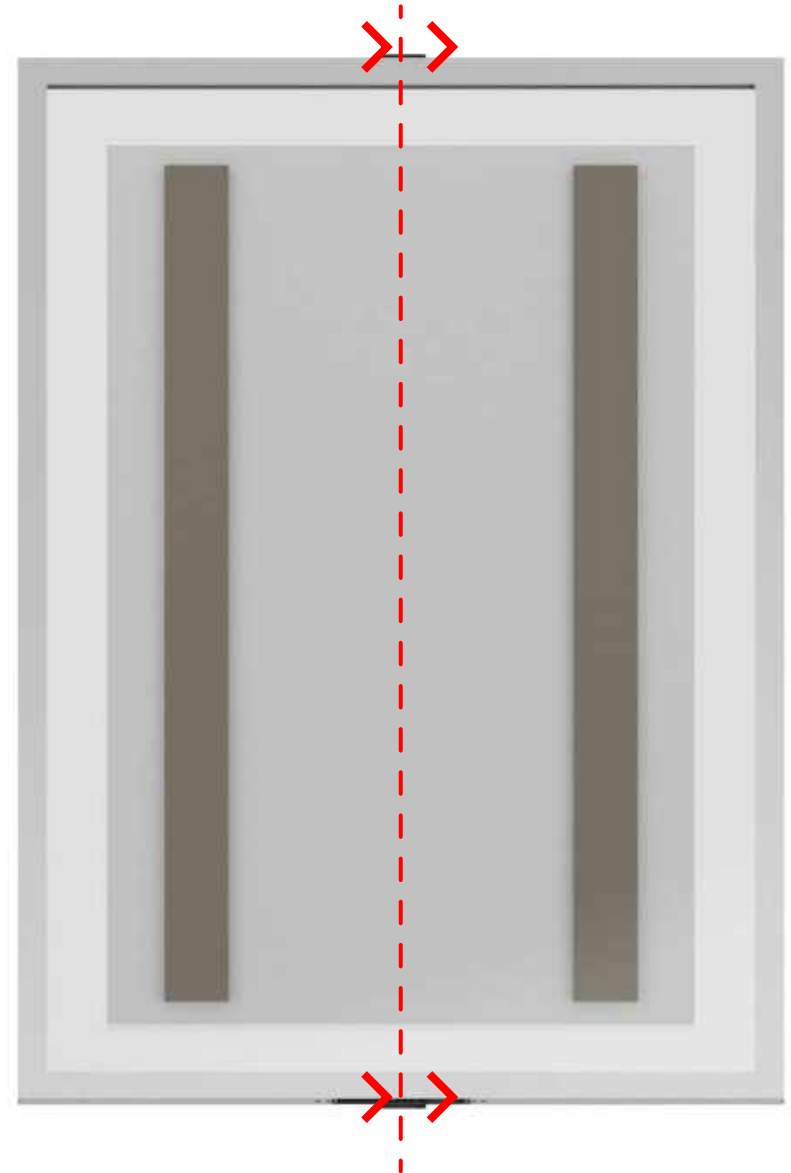

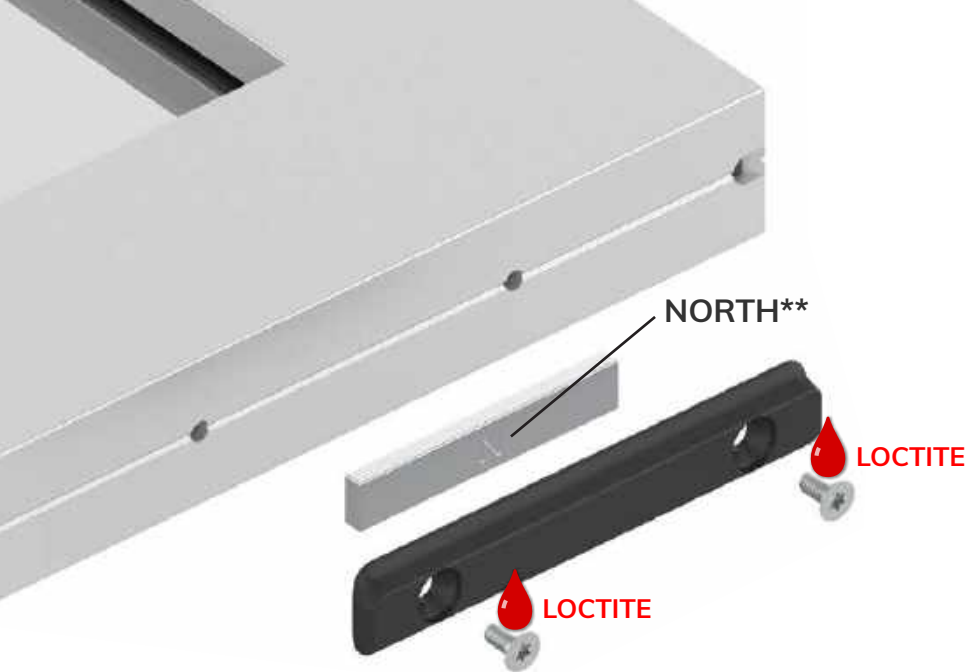

\*Always face NORTH side UP on doors, so you can always face SOUTH side down for counter magnets on ceiling.

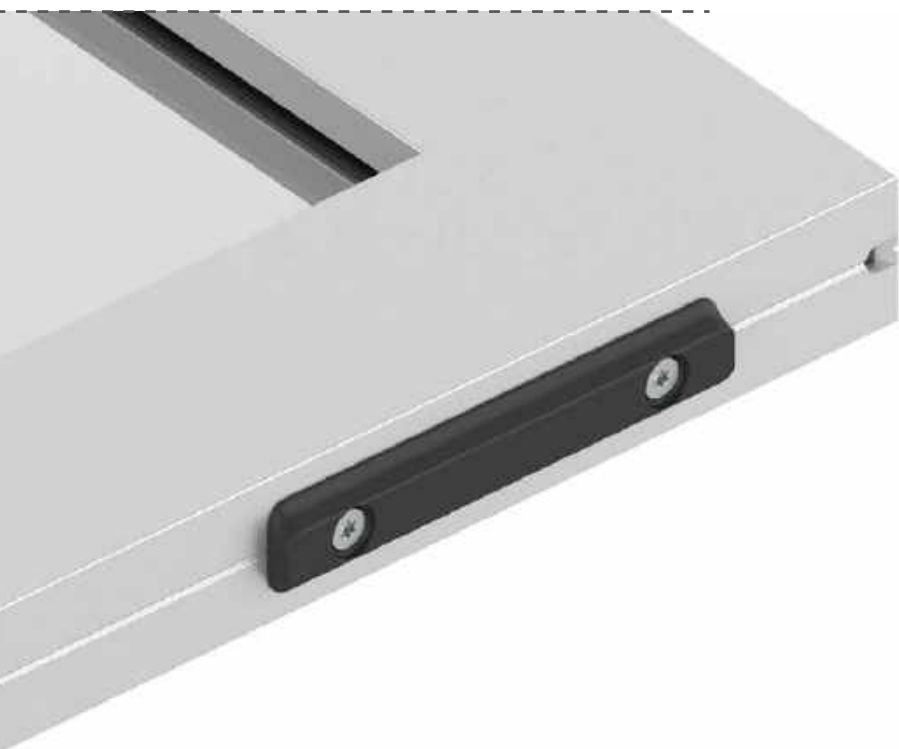

## FRAME-A-WAY POSITIONING MAGNETS

We advise to install the optional 2-way positioning magnet(s) onto the doorframe.

For counter magnets on the ceiling and/or 1-way operation, see 'Door installation manual'

For magnets on doors with **DOORJAMBS**, see next page.

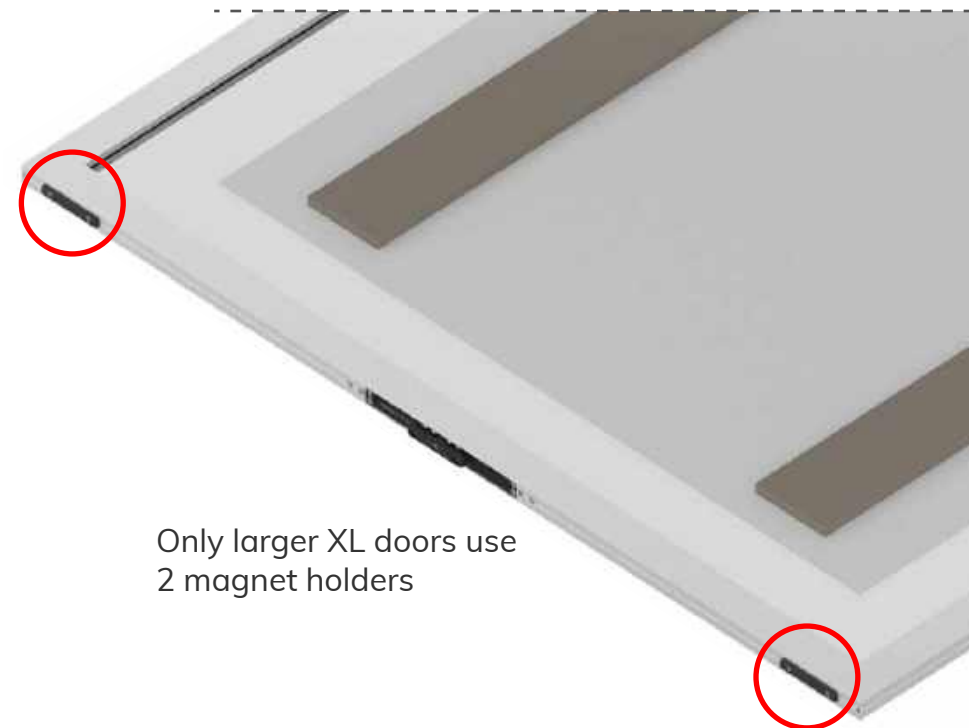

Only larger XL doors use  
2 magnet holders

## DOORJAMB POSITIONING MAGNETS

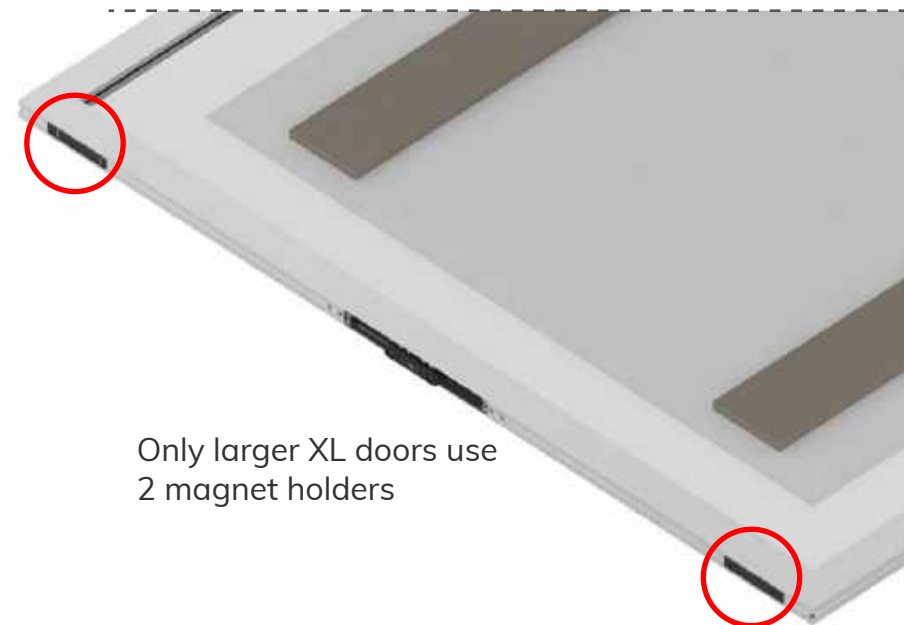
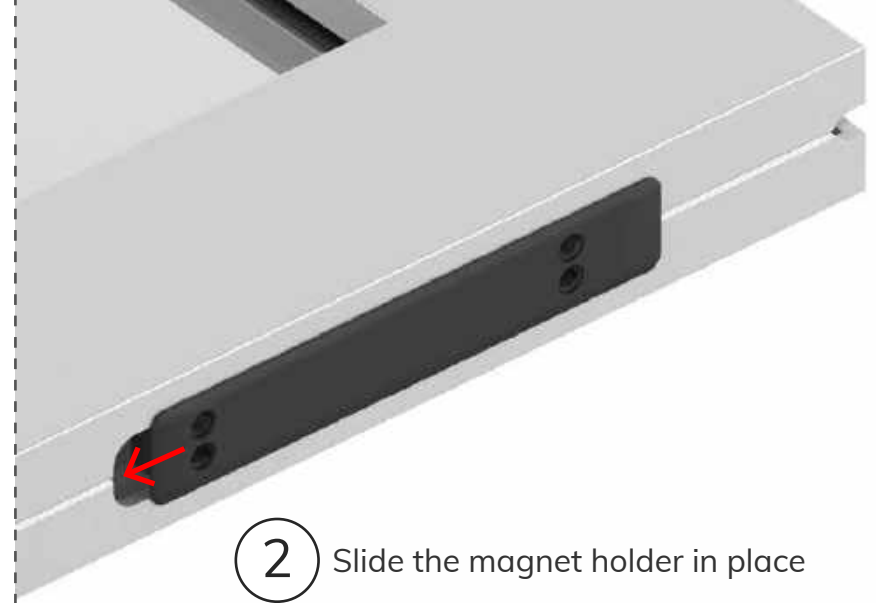
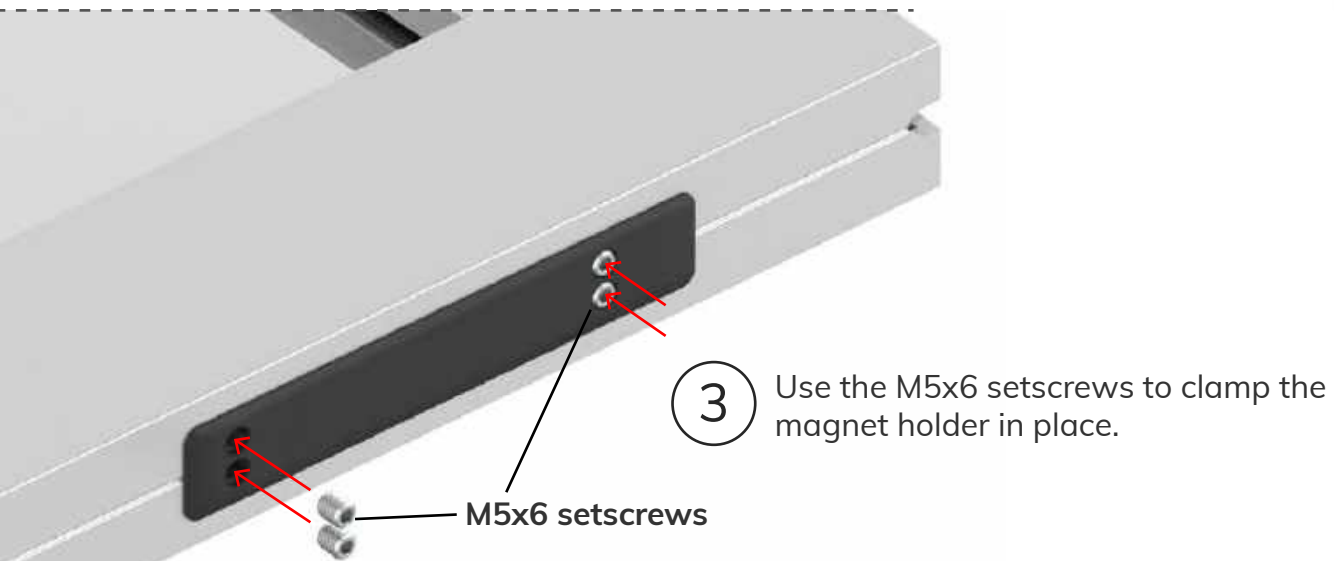
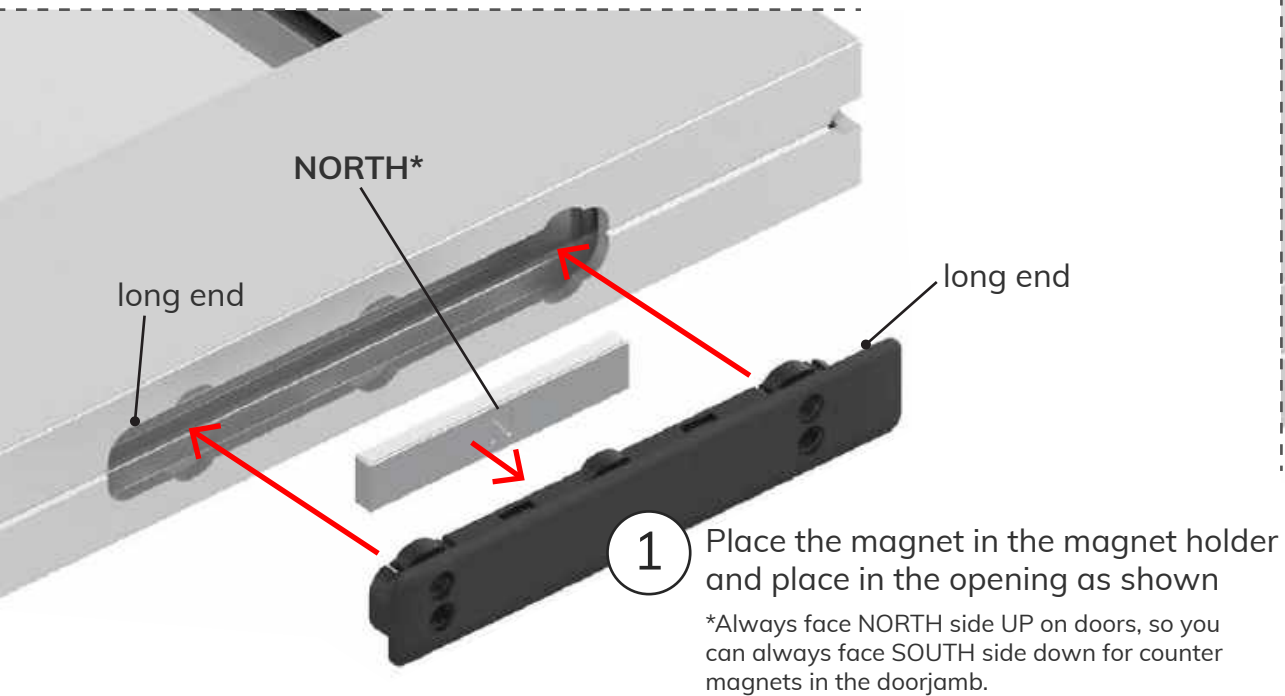

For further instructions on how to install  
the fully assembled door in your doorway,  
please refer to the DOOR INSTALLATION MANUAL